

# WAREHOUSE WITH YARD SPACE

## GREYHOUND COMMERCE PARK

### FOR LEASE

10980 ENTERPRISE AVENUE, BONITA SPRINGS, FL 34135



<b>PRICE:</b>	<b>\$13.50 PSF NNN</b>
<b>SIZE:</b>	15,000± SF on 1.27± Acres
<b>LOCATION:</b>	Located off Race Track Road, just south of Bonita Beach Road
<b>ZONING:</b>	IL - Light Industrial (City of Bonita Springs)
<b>YEAR BUILT:</b>	1974
<b>OH DOORS:</b>	One (1) 8' x 8'   One (1) 8' x 10'   One (1) 10' x 14'
<b>CEILING HEIGHT:</b>	16' At Peak
<b>POWER:</b>	3-Phase
<b>NNN:</b>	\$3.50 /PSF ESTIMATED
<b>PARCEL ID:</b>	02-48-25-B2-00011.0200

### WAREHOUSE WITH YARD SPACE

This 15,000± SF air-conditioned warehouse includes a 771± SF office space with a reception area, two restrooms, 3-phase power, a loading ramp and large yard space. Recent upgrades include overhead roll-up doors, LED lighting, roof membrane, and three 5-ton units for warehouse HVAC. Located in the Greyhound Commerce Park with quick access to US 41 and I-75. To be delivered "As Is"

### CONTACT

**DAVE WALLACE, CCIM, SIOR**  
**Senior Vice President**  
239.659.1447 x218  
dave.wallace@creconsultants.com

**DAVID WALLACE**  
**Associate**  
239.659.1447 x223  
david.wallace@creconsultants.com

12140 Carissa Commerce Ct, Suite 102  
Fort Myers, FL 33966

1100 Fifth Ave. S, Suite 404  
Naples, FL 34102

The information contained herein was obtained from sources believed reliable. CRE Consultants makes no guarantees, warranties or representations as to the completeness or accuracy thereof, and is subject to errors, omissions, change of price or conditions prior to sale or lease, or withdrawal without notice.

07/31/25



# WAREHOUSE WITH YARD SPACE

## GREYHOUND COMMERCE PARK

### FOR LEASE

10980 ENTERPRISE AVENUE, BONITA SPRINGS, FL 34135

## HIGHLIGHTS

- Three overhead doors
- Loading ramp
- Abundant parking
- Oversize side & rear yard
- Located at the end of the street offering privacy & security
- Updated:
  - Overhead Roll-up Doors
  - LED Lighting
  - Interior & Exterior paint
  - Roof Membrane
  - Warehouse HVAC (Three 5-ton units)

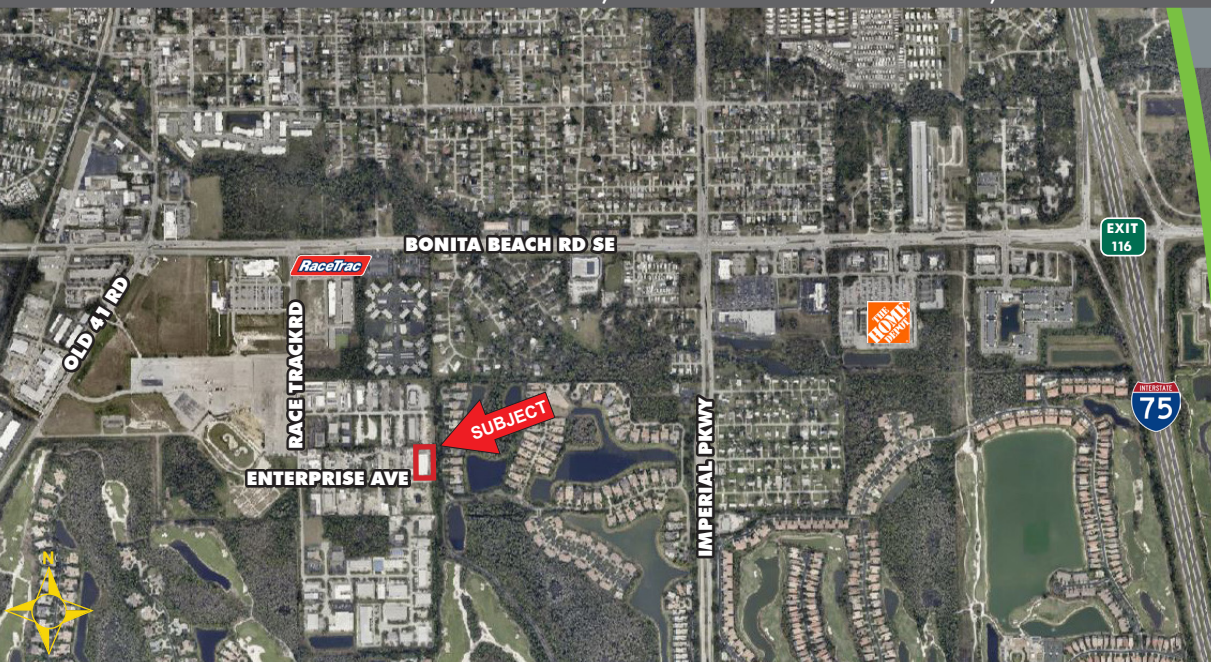

## CONTACT

**DAVE WALLACE, CCIM, SIOR**  
**Senior Vice President**  
239.659.1447 x218  
[dave.wallace@creconsultants.com](mailto:dave.wallace@creconsultants.com)

**DAVID WALLACE**  
**Associate**  
239.659.1447 x223  
[david.wallace@creconsultants.com](mailto:david.wallace@creconsultants.com)



