

11609 Catalpa Ln.
Woodstock, IL 60098

For Lease

MLS #12032067

RETAIL



RETAIL / OFFICE 1,400 SF

\$2,333.33 /MO. BASE \$20. PSF (NNN)

Retail / Office Space
1,400 SF
Vanilla Box

UNIT 11609: 1,400 SF vanilla box with 1 ADA bath.

Visible from Route 14 (Northwest Highway), near Walmart, Menards, Kohl's and Blain's Farm & Fleet. Traffic counts of 13,600 vpd. \$3,055.50/mo. including NNN.

Come join Anytime Fitness, Great Clips, Lucky Bernie's and Benjamin Edwards & Co.

2 Monument signs (front and rear).

Demographics	1 Mile	3 Miles	5 Miles
Total Population	2,284	22,965	40,020
Average HH Income	\$94,368	\$83,000	\$94,467

Specifications

Building Size:	15,515 SF
Year Built:	2007
HVAC System:	GFA / Central Air
Sprinklers:	Yes
Electric:	100 amp.
Washrooms:	1 ADA
Ceiling Height:	9'
Parking:	77 (Common)
Sewer/Water:	City
Zoning:	B3 PUD
Lease Term:	3-5 Years
CAM & Taxes	Cam: \$3.00 psf Taxes: \$3.19 psf (2024)
PIN #:	13-16-177-004

[CLICK HERE TO VIEW OUR WEBSITE](#)

No warranty or representation is made as to the accuracy of the foregoing information. Terms of sale or lease and availability are subject to change or withdrawal without notice. This document is for information purposes only. No offer of sub-agency is being made.



President / Designated Managing Broker
Heather Schweitzer
HeatherS@PremierCommercialRealty.com
O: 847.854.2300 x15 C: 815.236.9816

www.PremierCommercialRealty.com | 847.854.2300 | 9225 S. Route 31, Lake in the Hills, IL 60156

11609 Catalpa Ln.
Woodstock, IL 60098

For Lease

RETAIL

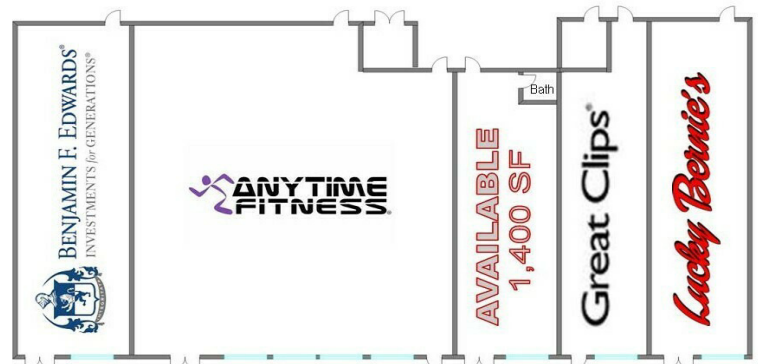
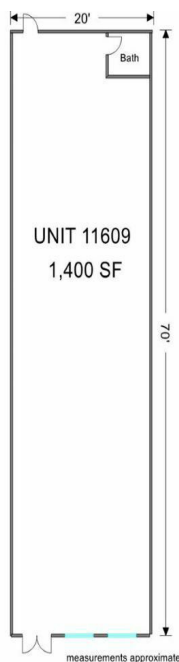

[CLICK HERE TO VIEW OUR WEBSITE](#)

No warranty or representation is made as to the accuracy of the foregoing information. Terms of sale or lease and availability are subject to change or withdrawal without notice. This document is for information purposes only. No offer of sub-agency is being made.



President / Designated Managing Broker
Heather Schweitzer
HeatherS@PremierCommercialRealty.com
O: 847.854.2300 x15 C: 815.236.9816

www.PremierCommercialRealty.com | 847.854.2300 | 9225 S. Route 31, Lake in the Hills, IL 60156

11609 Catalpa Ln.
Woodstock, IL 60098

For Lease

RETAIL

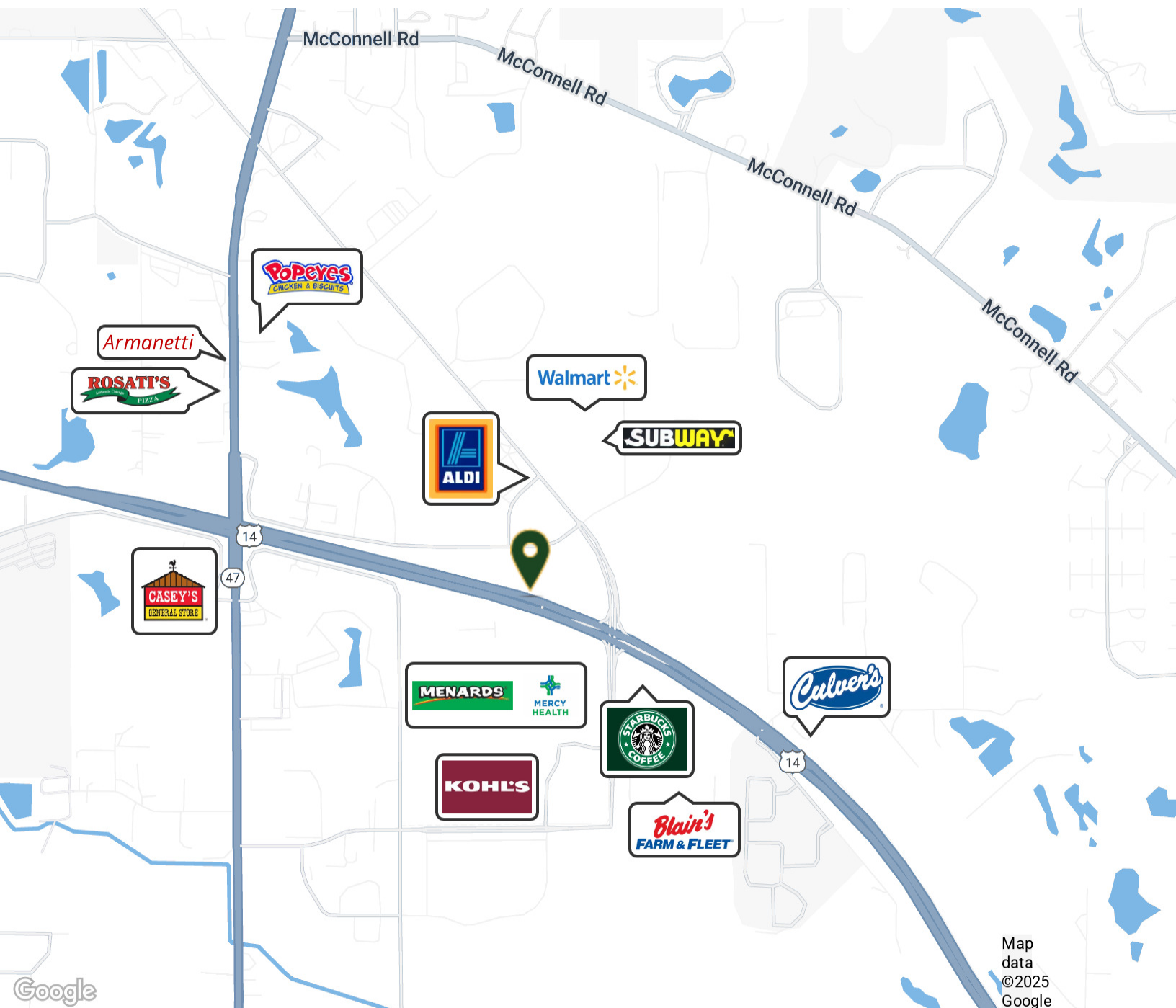

Map
data
©2025
Google

[CLICK HERE TO VIEW OUR WEBSITE](#)

No warranty or representation is made as to the accuracy of the foregoing information. Terms of sale or lease and availability are subject to change or withdrawal without notice. This document is for information purposes only. No offer of sub-agency is being made.



President / Designated Managing Broker
Heather Schweitzer
HeatherS@PremierCommercialRealty.com
O: 847.854.2300 x15 C: 815.236.9816

www.PremierCommercialRealty.com | 847.854.2300 | 9225 S. Route 31, Lake in the Hills, IL 60156