



ARES
INDUSTRIAL
MANAGEMENT

1500 TRADEPORT DR.

ORLANDO, FL 32824

FOR LEASE | 46,405 SQ FT | Class A Warehouse Facility



FOUNDRY
COMMERCIAL

JUSTIN RUBY, SIOR, CCIM

Partner
407-865-0311

JOEY WOODMAN

Senior Vice President
407-748-5888

OWNED BY



ARES
INDUSTRIAL
MANAGEMENT

Property FEATURES

- 5,370 Office SF
- 26' clear height
- 280' building depth
- Front Load
- 40' column spacing
- 7 Dock-High doors
- 1 Drive-In Door
- Wet Sprinkler
- 66 parking spots
- 120' truck court depth
- TPO Roof
- LED Lighting

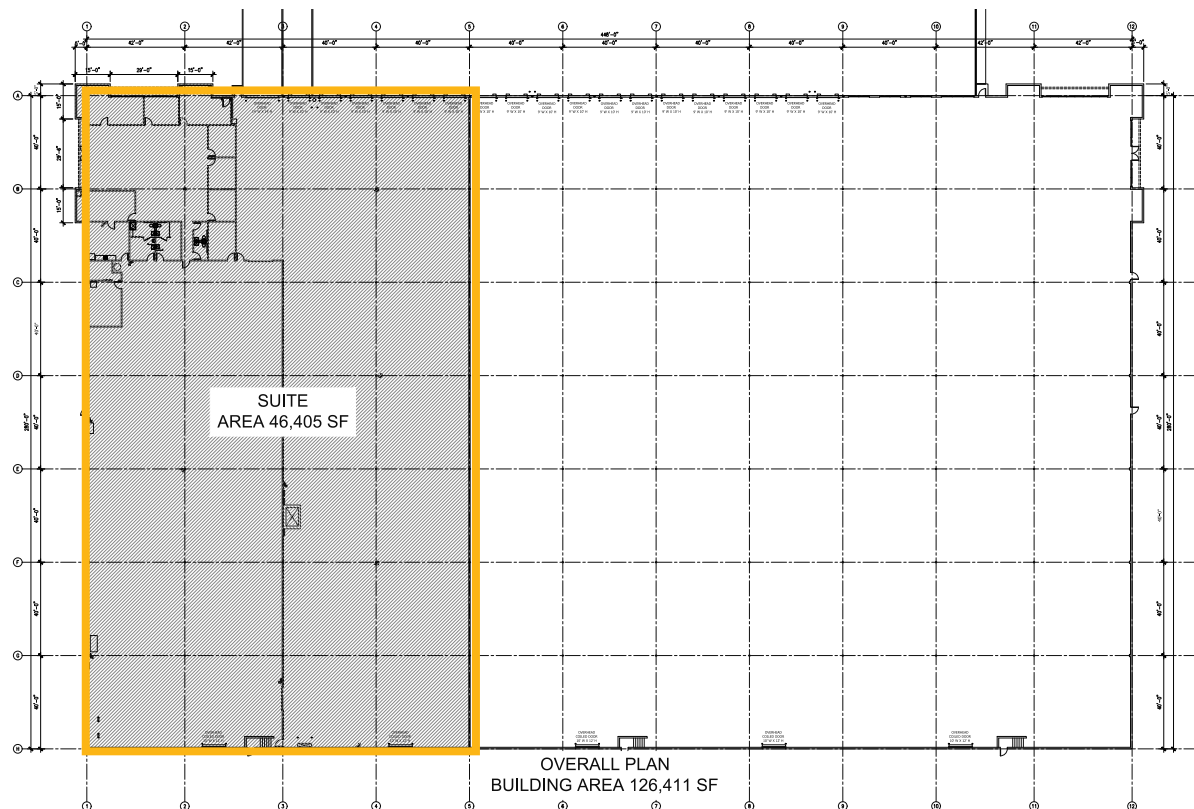

ARES
INDUSTRIAL
MANAGEMENT

Location HIGHLIGHTS

- Located near the Orlando International Airport (MCO)
- 6 miles to SR 417 and the Florida Turnpike
- 7 miles to SR 528



ARES
INDUSTRIAL
MANAGEMENT

ABOUT ARES MANAGEMENT CORPORATION

Ares Management Corporation (NYSE: ARES) is a leading global alternative investment manager offering clients complementary primary and secondary investment solutions across the credit, private equity, real estate and infrastructure asset classes. We seek to provide flexible capital to support businesses and create value for our stakeholders and within our communities. By collaborating across our investment groups, we aim to generate consistent and attractive investment returns throughout market cycles. For more information, please visit www.aresmgmt.com.



JUSTIN RUBY, SIOR, CCIM
Partner
407-865-0311

JOEY WOODMAN
Senior Vice President
407-748-5888



**ARES
INDUSTRIAL
MANAGEMENT**