



**COLDWELL BANKER
COMMERCIAL**
PRIME
PROPERTIES

2388 Patterson Road, Grand Junction, CO 81505



This information has been secured from sources we believe to be reliable, but we make no representations or warranties, expressed or implied, as to the accuracy of the information. References to square footage or age are approximate. Buyer must verify the information and bears all risk for any inaccuracies.

Mike Foster, CCIM | mfoster@cbcwest.com
Coldwell Banker Commercial Prime Properties

Direct: 970-244-6602
Mobile: 970-433-8374

131 N. 6th, St., Suite 200
Grand Junction, CO 81501



**COLDWELL BANKER
COMMERCIAL**
PRIME
PROPERTIES

Professional Office or Retail Space Available



This information has been secured from sources we believe to be reliable, but we make no representations or warranties, expressed or implied, as to the accuracy of the information. References to square footage or age are approximate. Buyer must verify the information and bears all risk for any inaccuracies.

Mike Foster, CCIM | mfoster@cbcwest.com
Coldwell Banker Commercial Prime Properties

Direct: 970-244-6602
Mobile: 970-433-8374

131 N. 6th, St., Suite 200
Grand Junction, CO 81501



**COLDWELL BANKER
COMMERCIAL**
PRIME
PROPERTIES



This information has been secured from sources we believe to be reliable, but we make no representations or warranties, expressed or implied, as to the accuracy of the information. References to square footage or age are approximate. Buyer must verify the information and bears all risk for any inaccuracies.

Mike Foster, CCIM | mfoster@cbcwest.com
Coldwell Banker Commercial Prime Properties

Direct: 970-244-6602
Mobile: 970-433-8374

131 N. 6th, St., Suite 200
Grand Junction, CO 81501



2388 Patterson Road, Grand Junction, CO 81505

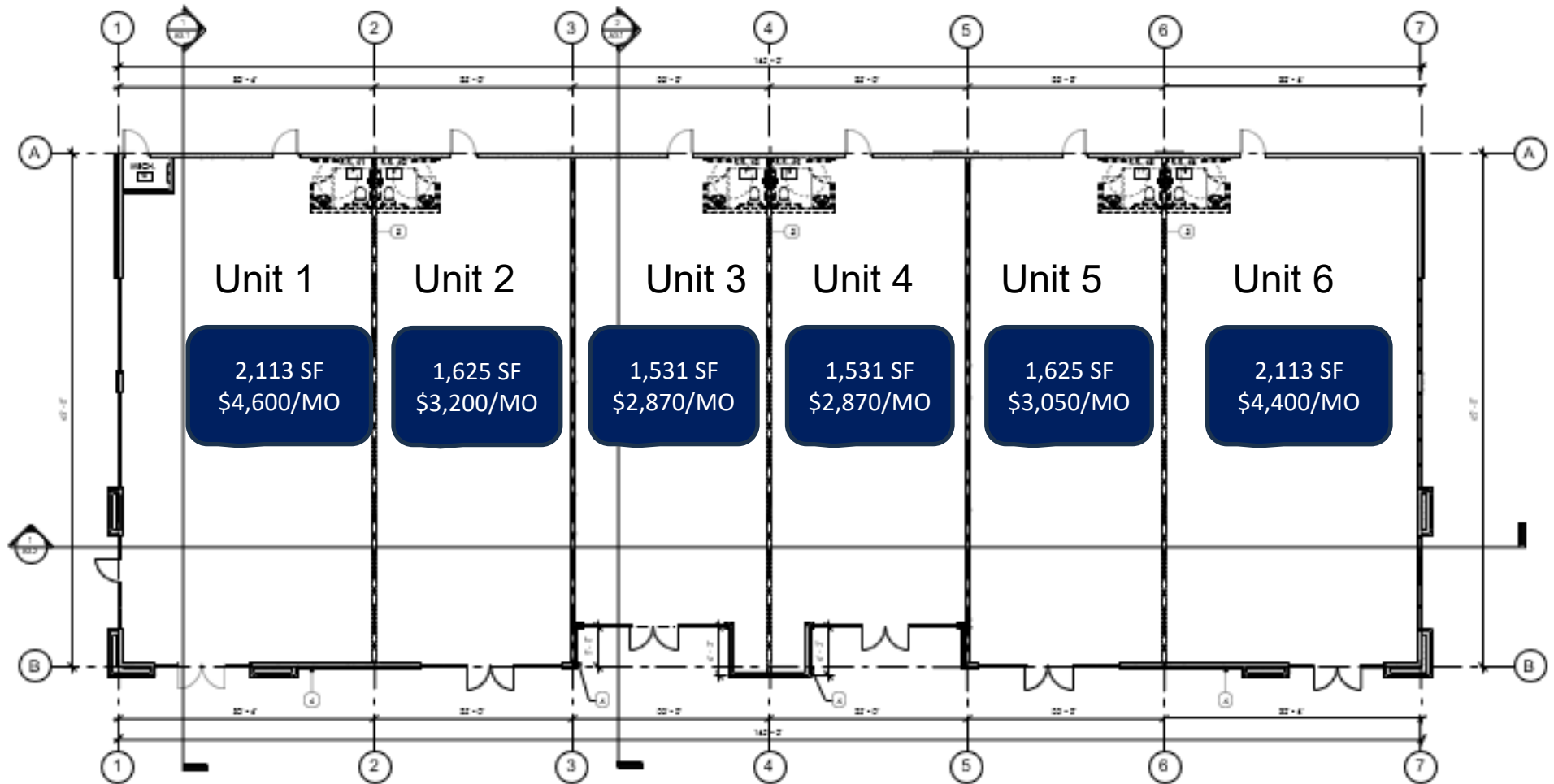

POSSIBLE CONFIGURATIONS



1. All Units = 10,538 SF @ \$19,760/MO + NNN
2. Units 4,5 & 6 = 5,269 SF @ \$9,880/MO + NNN
3. Units 5 and 6 = 3,738 SF @ \$7,450/MO + NNN
4. Possible floor layout for other unit combinations - Negotiable



2388 Patterson Road, Grand Junction, CO 81505

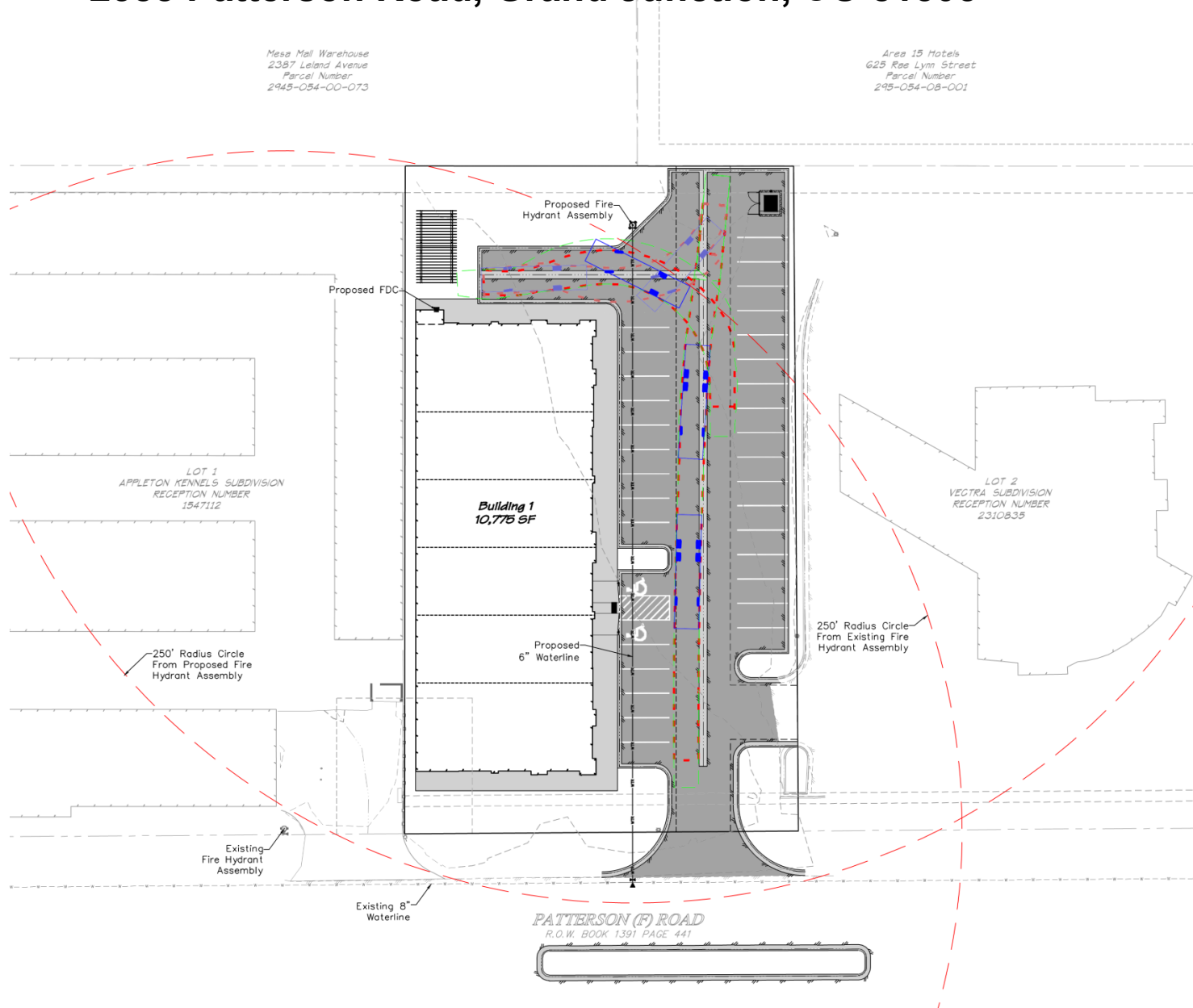



COLDWELL BANKER COMMERCIAL

PRIME PROPERTIES



24 Road

MESA
MALL



SITE

MESA
MALL





**COLDWELL BANKER
COMMERCIAL**
PRIME
PROPERTIES

2388 Patterson Road, Grand Junction, CO 81505

