

# RETAIL FOR LEASE

University Plaza • 101 W Florida Ave Melbourne, FL 32901



## OFFERING SUMMARY

<b>Available SF:</b>	2,000 SF
<b>Lease Rate:</b>	\$17.00 SF/yr (\$5.00/sf NNN)
<b>Lot Size:</b>	0.86 Acres
<b>Year Built:</b>	2007
<b>Building Size:</b>	6,500 SF
<b>Zoning:</b>	C2
<b>Market:</b>	South Brevard
<b>Submarket:</b>	Melbourne

## PROPERTY OVERVIEW

Join this great plaza located blocks from F.I.T., a nationally ranked university with over 3600 students.

Plaza offers building and monument signage with abundant parking.

University Plaza is located off Babcock Street, a heavily travelled corridor running north and south through southern Brevard County next to Walmart Neighborhood Market.

## LOCATION OVERVIEW

Just south of Florida Institute of Technology and across from Melbourne Central Catholic High School.

Located a block west of Babcock St. midway between US 192 (New Haven) and Palm Bay Rd.

### JEFFERY T. ROBISON, CCIM

President | Broker  
321.722.0707 X13  
jeff@teamlbr.com

### J. BLAKE ROBISON

Retail Sales And Leasing Advisor  
321.722.0707 X18  
blake@teamlbr.com

### VITOR DE SOUSA, CCIM

Retail Sales & Leasing  
321.722.0707 X15  
vitor@teamlbr.com

### Lightle Beckner Robison, Inc.

321.722.0707 • teamlbr.com  
70 W. Hibiscus Blvd.,  
Melbourne, FL 32901

Information contained herein has been obtained through sources deemed reliable but cannot be guaranteed as to its accuracy. A purchaser or lessee is expected to verify all information to his/her own satisfaction. Zoning information subject to change and not warranted. Always confirm current requirements with local governing agencies.

# ADDITIONAL PHOTOS

University Plaza • 101 W Florida Ave Melbourne, FL 32901



## JEFFERY T. ROBISON, CCIM

President | Broker  
321.722.0707 X13  
jeff@teamlbr.com

## J. BLAKE ROBISON

Retail Sales And Leasing Advisor  
321.722.0707 X18  
blake@teamlbr.com

## VITOR DE SOUSA, CCIM

Retail Sales & Leasing  
321.722.0707 X15  
vitor@teamlbr.com

## Lightle Beckner Robison, Inc.

321.722.0707 • teamlbr.com  
70 W. Hibiscus Blvd.,  
Melbourne, FL 32901

Information contained herein has been obtained through sources deemed reliable but cannot be guaranteed as to its accuracy. A purchaser or lessee is expected to verify all information to his/her own satisfaction. Zoning information subject to change and not warranted. Always confirm current requirements with local governing agencies.



# AVAILABLE SPACES

University Plaza • 101 W Florida Ave Melbourne, FL 32901

LEASE TYPE | \$5.00/sf NNN

TOTAL SPACE | 2,000 SF

LEASE TERM | Negotiable

LEASE RATE | \$17.00 SF/yr



## University Plaza

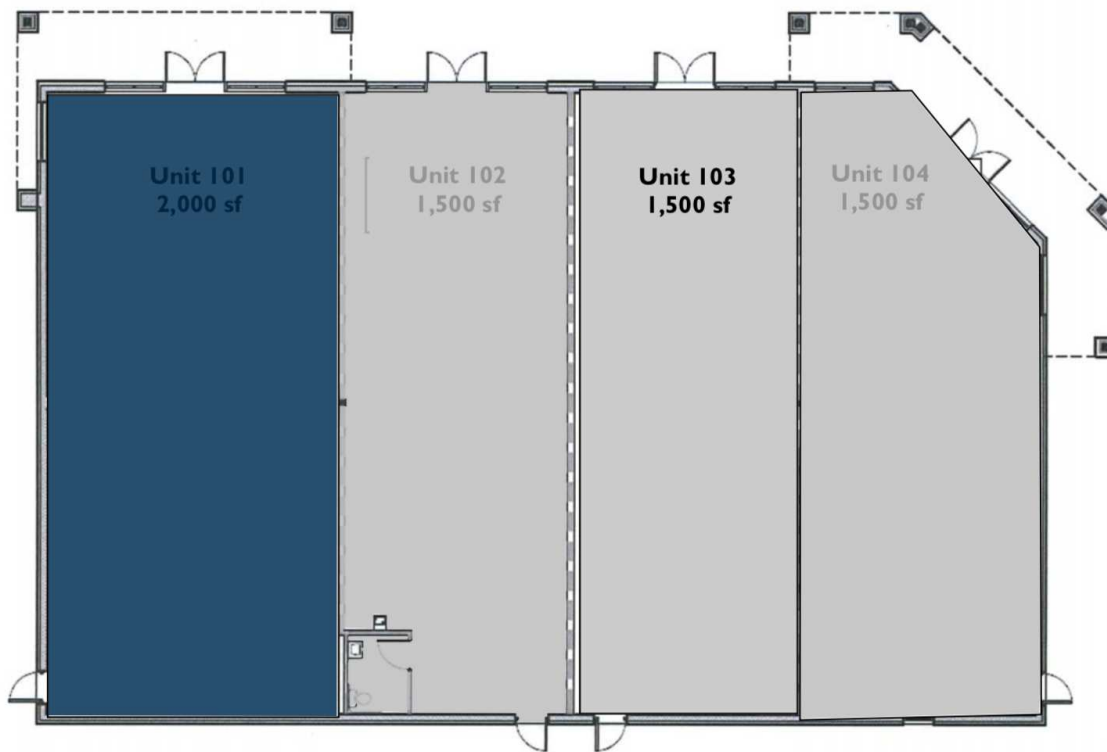

UNAVAILABLE

AVAILABLE

SUITE	TENANT	SIZE	TYPE	RATE
Unit #101	Available	2,000 SF	\$5.00/sf NNN	\$17.00 SF/yr

### JEFFERY T. ROBISON, CCIM

President | Broker  
321.722.0707 X13  
jeff@teamlbr.com

### J. BLAKE ROBISON

Retail Sales And Leasing Advisor  
321.722.0707 X18  
blake@teamlbr.com

### VITOR DE SOUSA, CCIM

Retail Sales & Leasing  
321.722.0707 X15  
vitor@teamlbr.com

### Lightle Beckner Robison, Inc.

321.722.0707 • teamlbr.com  
70 W. Hibiscus Blvd.,  
Melbourne, FL 32901

Information contained herein has been obtained through sources deemed reliable but cannot be guaranteed as to its accuracy. A purchaser or lessee is expected to verify all information to his/her own satisfaction. Zoning information subject to change and not warranted. Always confirm current requirements with local governing agencies.

# LOCATION MAPS

University Plaza • 101 W Florida Ave Melbourne, FL 32901

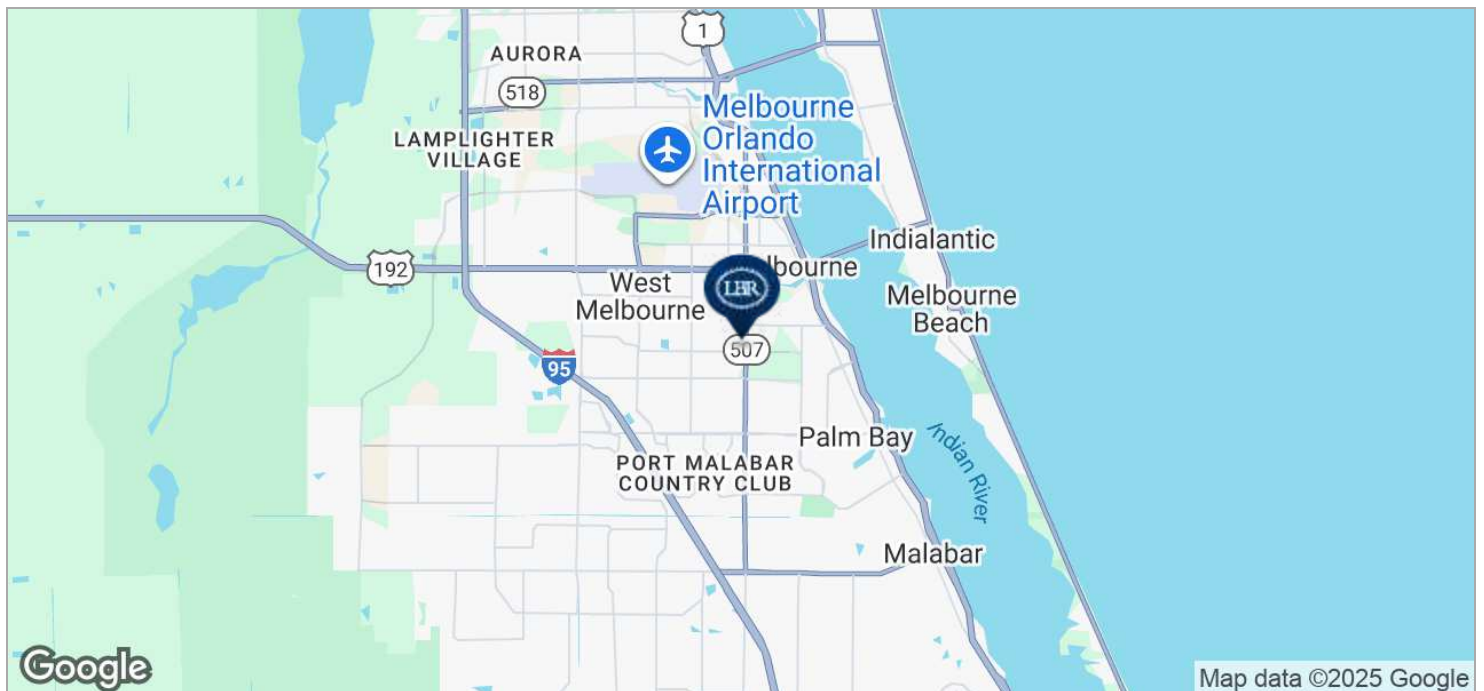
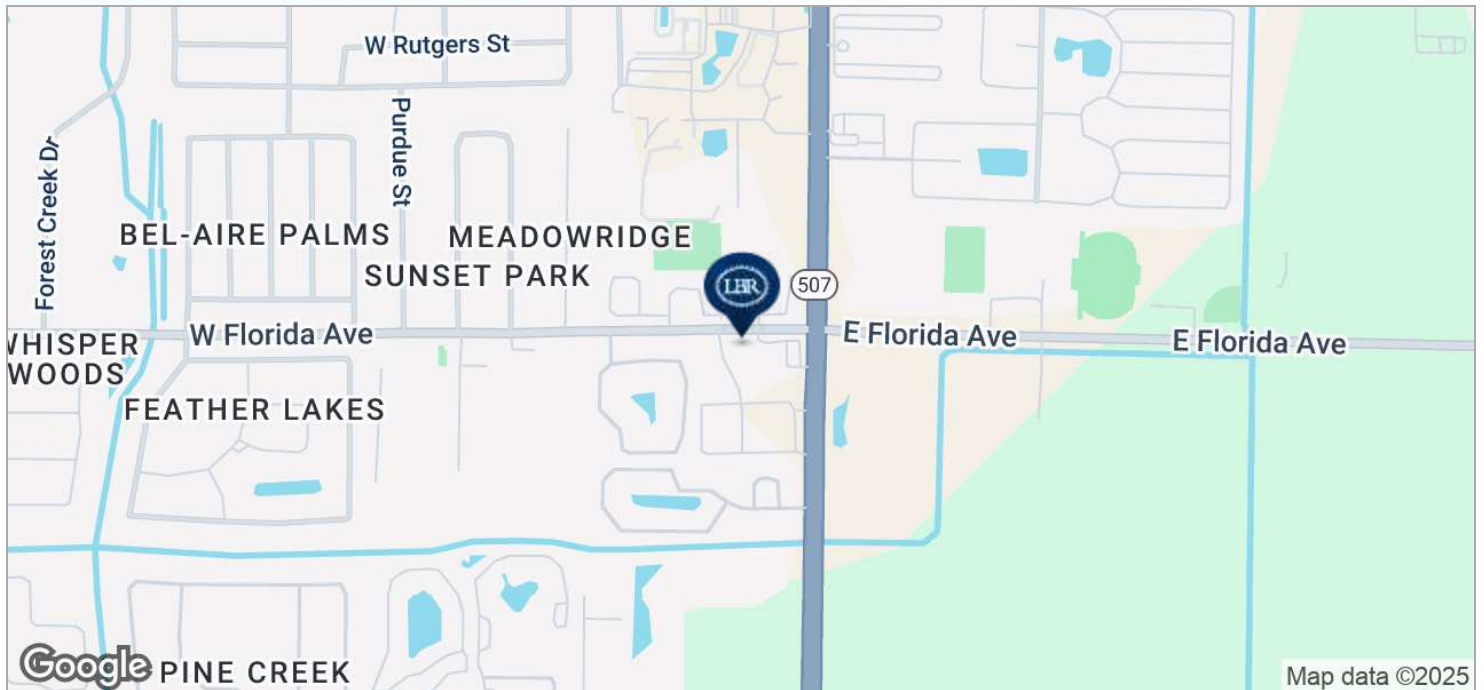

## JEFFERY T. ROBISON, CCIM

President | Broker  
321.722.0707 X13  
jeff@teamlbr.com

## J. BLAKE ROBISON

Retail Sales And Leasing Advisor  
321.722.0707 X18  
blake@teamlbr.com

## VITOR DE SOUSA, CCIM

Retail Sales & Leasing  
321.722.0707 X15  
vitor@teamlbr.com

## Lightle Beckner Robison, Inc.

321.722.0707 • teamlbr.com  
70 W. Hibiscus Blvd.,  
Melbourne, FL 32901

Information contained herein has been obtained through sources deemed reliable but cannot be guaranteed as to its accuracy. A purchaser or lessee is expected to verify all information to his/her own satisfaction. Zoning information subject to change and not warranted. Always confirm current requirements with local governing agencies.

# DEMOGRAPHICS MAP

University Plaza • 101 W Florida Ave Melbourne, FL 32901

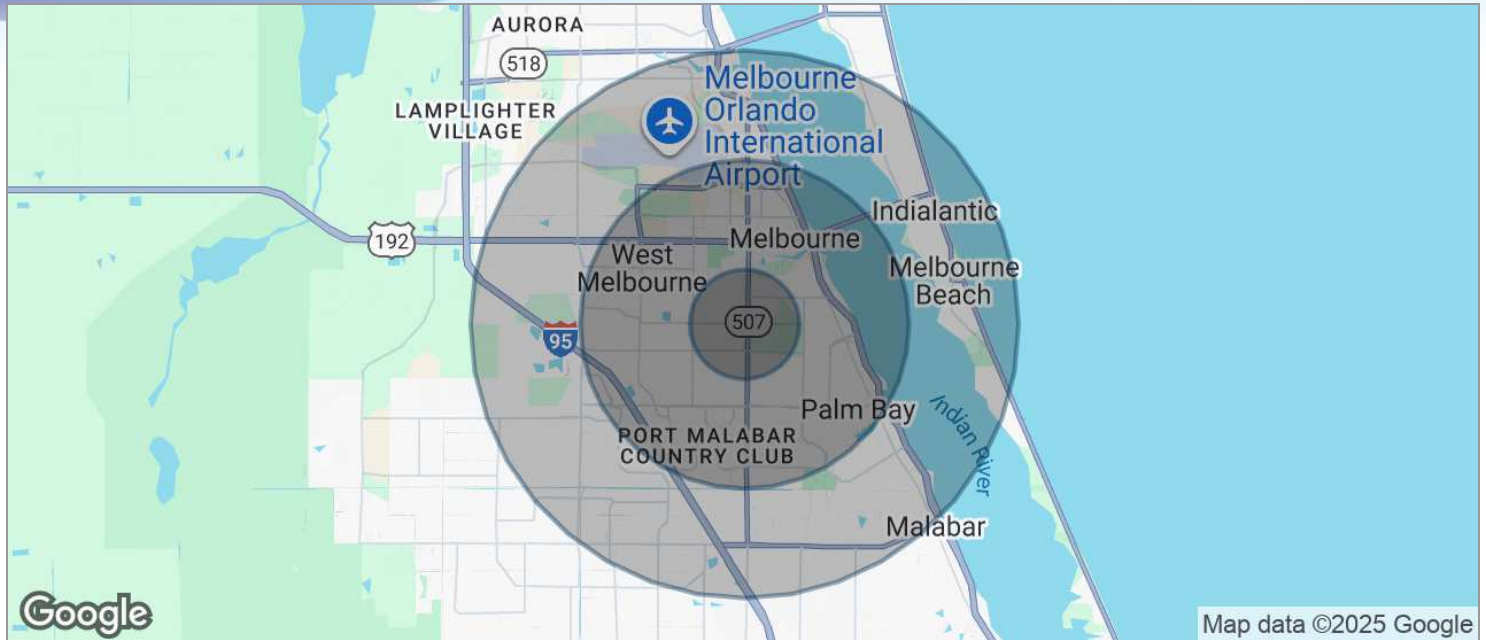

POPULATION	1 MILE	3 MILES	5 MILES
TOTAL POPULATION	9,574	56,408	126,435
MEDIAN AGE	40.8	42.8	43.8
MEDIAN AGE (MALE)	35.6	38.7	41.2
MEDIAN AGE (FEMALE)	44.2	45.8	46.0
HOUSEHOLDS & INCOME	1 MILE	3 MILES	5 MILES
TOTAL HOUSEHOLDS	3,962	24,340	52,607
# OF PERSONS PER HH	2.4	2.3	2.4
AVERAGE HH INCOME	\$48,950	\$50,057	\$58,160
AVERAGE HOUSE VALUE	\$171,276	\$178,588	\$198,306

\* Demographic data derived from 2020 ACS - US Census

## JEFFERY T. ROBISON, CCIM

President | Broker  
321.722.0707 X13  
jeff@teamlbr.com

## J. BLAKE ROBISON

Retail Sales And Leasing Advisor  
321.722.0707 X18  
blake@teamlbr.com

## VITOR DE SOUSA, CCIM

Retail Sales & Leasing  
321.722.0707 X15  
vitor@teamlbr.com

## Lightle Beckner Robison, Inc.

321.722.0707 • teamlbr.com  
70 W. Hibiscus Blvd.,  
Melbourne, FL 32901

Information contained herein has been obtained through sources deemed reliable but cannot be guaranteed as to its accuracy. A purchaser or lessee is expected to verify all information to his/her own satisfaction. Zoning information subject to change and not warranted. Always confirm current requirements with local governing agencies.