

NOTES:

1. Plat Scale: 1" = 100'
2. The bearings for this survey are based on East R-O-W of IH45.
3. Roads dedicated by recorded deed unless otherwise noted
4. This plat of survey has been performed with reliance upon title examination and abstracting performed by Alamo Title Company under GF No.05-42610982 with an effective date of 09/02/05. This surveyor has not abstracted the subject property.

5. The professional service reflected on this plat of survey is provided in connection with the transaction anticipated by the title search referenced and dated above. It is not to be used for any other purpose. This original work is protected under copyright laws, Title 17 United States Code Sections 101 and 102. All violators will be prosecuted to the fullest extent of the law. This survey is being provided solely for the use of the recipients named below and no license has been created, expressed or implied, to copy the survey except as is necessary in conjunction with the original transaction, which shall take place within thirty (30) days from the date shown hereon.

6. Terms and conditions of those certain Deeds (Controlled Access Highway Facility) recorded under CF 9444437, 9444438, 9444439 and 9444440 RPRMCT.
7. Sanitary Sewer Affidavit recorded under CF 99072143 RPRMCT.
8. Subject to terms and conditions regarding the grant and reservation of that certain 50' wide, non-exclusive access easement as set forth and described in CF 8135118 and 9615565, RPRMCT.

Patricia A. Hillman
10,000 Acres
CF 8541002

The Woodlands Land
Development Company
8951 Acres
CF 2000-080837

LINE	BEARING	DISTANCE
L 1	S 03°03'39"E	180.69'
L 2	N 10°31'20"W	62.38'

61,295 ACRES
GEORGE TAYLOR SURVEY, A-555
RICHARD VINCE SURVEY, A-583
MONTGOMERY COUNTY, TEXAS

Being 61,295 acres of land with 44,820 acres situated in the George Taylor Survey, Abstract Number 555 and 16,475 acres situated in the Richard Vince Survey, Abstract Number 583, all in Montgomery County, Texas; the 44,820 acres being the called 44,597 acres as described in Deed to James John Tiampo, Josette Tiampo-Oskarsen and Janet M. Tiampo, recorded under Clerk's File Number 9108846, and Nadia T. Savage, Claire T. Savage and Lisa T. Savage, recorded under Clerk's File Number 2000-093799; the 16,475 acres being the called 16,513 acres as described in Deed to James John Tiampo, Josette Tiampo-Oskarsen and Janet M. Tiampo, recorded under Clerk's File Number 9108845, and Nadia T. Savage, Francis T. Savage, Claire T. Savage and Lisa T. Savage, recorded under Clerk's File Number 2000-093797; said 61,295 being more particularly described by metes and bounds as follows with all bearing referenced to the East line of Interstate Highway 45 as described under Clerk's File Number 9444439 of the Real Property Records of Montgomery County, Texas.

BEGINNING at a 4 inch by 4 inch concrete monument, found at the Northwest corner of the Montgomery County School Land Survey, Abstract Number 350, being the Southwest corner of the Richard Vince Survey, in the East line of the George Taylor Survey, for the Southwest corner of the 16,475 acre tract and being a controlling monument for the herein described tract;

THENCE South 03 degrees 03'39" East, a distance of 180.69 feet along the West line of the Montgomery County School Land Survey and George Taylor Survey, and the West line of the Tom R. Jones 7.0 acres described in Volume 646, Page 328 of the Montgomery County Deed Records and East line of the 44,820a tract, to a bent inch iron rod, found for the Southeast corner of the 44,820 acre tract at the Northeast corner of the Jamaluddin Family Partnership LTD, 13,000 acres as described under Clerk's File Number 2001-115726;

THENCE South 86 degrees 34'20" West, a distance of 1562.29 feet along the South line of the 44,820 acre tract (Deed call: North 89 degrees 34'20" West, 1545.68 feet) and the North line of the 13,000 acre tract Jamaluddin Family Partnership LTD, to a 5/8 inch iron rod with survey cap marked "Glezman RPLS 4627", set for the Southwest corner of the herein described tract in the East line of Interstate Highway 45;

THENCE North 11 degrees 36'16" West, a distance of 668.90 feet along the East line of Interstate Highway 45, to a 5/8 inch iron rod with survey cap, set December 8, 2003, for a Southwesterly Northwest corner of the herein described tract;

THENCE with the following courses and distances along the perimeter of that certain 6,359 acres as described in Deed to PLR, L.L.C. recorded under Clerk's File Number 2003-051732 and monumented December 8, 2003:

North 87 degrees 47'40" East, a distance of 360.33 feet to an angle point;

North 55 degrees 44'00" East, a distance of 522.26 feet to an interior corner;

North 44 degrees 51'07" West, a distance of 367.69 feet to an interior corner;

South 55 degrees 02'36" West, a distance of 365.55 feet to an angle point;

South 87 degrees 45'05" West, a distance of 300.01 feet to a Southwesterly Northwest corner of the herein described tract, in the East line of Interstate Highway 45;

THENCE North 10 degrees 31'29" West, a distance of 62.38 feet along the East line of Interstate Highway 45, to a 1x100 capped monument, found for an angle point;

THENCE North 11 degrees 34'45" West, a distance of 270.16 feet along the East line of Interstate Highway 45, to a 5/8 inch iron rod with survey cap, set for the Northwest corner of the herein described tract at the Northwest corner of the Patricia A. Hillman 10,000 acres as described under Clerk's File Number 8541002;

THENCE North 86 degrees 52'52" East along the North line of the 44,820 acres, passing at 1755.45, an iron rod with a capped marked "SV", found for the Northeast corner of the 44,820 acre tract (Deed call: South 89 degrees 39'30" East, 1763.75 feet) and the Southwest corner of The Woodlands Land Development Company 9,651 acres as described under Clerk's File Number 2000-080837 and the Southeast corner of the Hillman 10,000 acre tract, in the West line of the Richard Vince Survey and East line of the George Taylor Survey; in all, a distance of 2249.09 feet along the North line of the 16,475 acre tract (Deed call: North 89 degrees 39'00" West, 498.70 feet) and the South line of the 9,651 acre tract (Deed call: South 86 degrees 46'43" West, 497.60 feet), to a 5/8 inch iron rod with survey cap, set for the Northeast corner of the 16,475 acre tract and Northeast corner of the herein described tract, in the West line of the Missouri-Pacific Railroad, a 150 foot wide right-of-way based on the Right-Of-Way and Track Map dated June 30, 1917 (no Deed found);

THENCE South 15 degrees 21'03" East, a distance of 1185.35 feet along the East line of the 16,475 acre tract (Deed call: North 11 degrees 31'00" West, 1189.84 feet) and West line of the Missouri-Pacific Railroad, to a 5/8 inch iron rod with survey cap, set for the most Easterly Southeast corner of the herein described tract at the Southeast corner of the 16,475 acre tract and Northeast corner of the aforementioned Jones 7.0 acre tract, in the common line of the Montgomery County School Land Survey and Richard Vince Survey;

THENCE South 86 degrees 37'26" West, a distance of 743.55 feet along the South line of the 16,475 acre tract (Deed call: South 89 degrees 51'07" East, 736.55 feet) along the North line of the Jones 7.0 acre tract (Deed call: East, 736.7 feet) and common line of the Montgomery County School Land Survey and Richard Vince Survey, back to the Point of Beginning and containing 61,295 acres of land based on the survey and plat prepared by Glezman Surveying, Inc., dated October 12, 2005.

61.295 Acres

16.475 Acres

Tract Two:
Called 16,513 Acres
CF 2000-093797 RPRMCT
Re: CF 9108845 RPRMCT

44.820 Acres

Tract One:
Called 44,597 Acres
CF 2000-093799 RPRMCT
Re: CF 9108846 RPRMCT

POINT OF BEGINNING
Found 4" x 4" concrete
monument NW corner Montgomery
County School Survey, SW corner
Richard Vince Survey, and East
line of George Taylor Survey

Survey of 61,295 acres located in the
George Taylor Survey, A-555 and the
Richard Vince Survey, A-583
Montgomery County, Texas

GF No.: 05-42610982 Date: October 17, 2005 (TC)
Job No.: 2005-238

To: Alamo Title Company
We, Glezman Surveying, Inc., acting by and through Michael Glezman, a Registered Professional Land Surveyor in the State of Texas, hereby certify that this survey and professional service substantially conforms to the Texas Society of Professional Surveyors Standards and Specifications for a Category 1A, Condition II Survey.
© 2005 All Rights Reserved

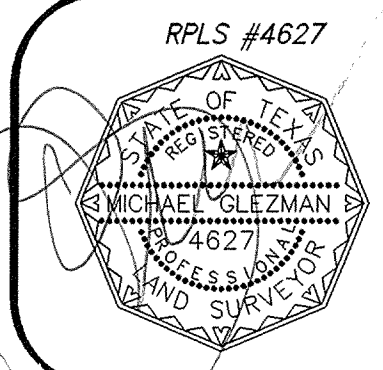

Surveying Southern Texas since 1987
GLEZMAN SURVEYING, INC.
1838 Old River Road
Montgomery, Texas 77156
Office: (936) 582-6340 www.glezmansurveying.com

Glezman Surveying Inc.