

# 661 S Eastwood Dr. (Route 47)

Woodstock, IL 60098

## For Lease

MLS #12403041



RETAIL / OFFICE

1,750 SF

\$3,164.58/MO TOTAL

\$15.PSF(NNN)

### RETAIL OR OFFICE SPACE

Prime location on busy Route 47 between Route 120 and Route 14 with traffic counts of 13,200 vpd.

1,750 SF open space with 2 ADA bathrooms, utility room, storage closet, walk in cooler and stand alone cooler (both can stay or go).

Ideal location for retail, office or café. New lighted monument signage available. \$3,164.58 total monthly, including NNN. Come join Family Dentistry of Woodstock, Pizza Hut, Pro-Nails, AutoTech, PawStock and more.

Demographics	1 Mile	3 Miles	5 Miles
Total Population	6,066	27,797	34,532
Average HH Income	\$88,349	\$102,310	\$108,395

### Specifications

Center Size:	7,400 SF
Year Built:	1993
HVAC System:	GFA / Central Air
Electrical:	200 amp
Washrooms:	2 ADA
Ceiling Height:	12 ft
Parking:	Common
Sewer/Water:	City
Zoning:	B3
CAM & Taxes	CAM: \$2.82 psf Taxes: \$3.88 psf
PIN #:	13-09-103-001

[CLICK HERE TO VIEW OUR WEBSITE](#)

No warranty or representation is made as to the accuracy of the foregoing information. Terms of sale or lease and availability are subject to change or withdrawal without notice. This document is for information purposes only. No offer of sub-agency is being made.



President / Designated Managing Broker  
**Heather Schweitzer**  
HeatherS@PremierCommercialRealty.com  
O: 847.854.2300 x15 C: 815.236.9816

Broker Associate  
**Shari Haefner**  
ShariH@premiercommercialrealty.com  
O: 847.854.2300 x18 C: 312.671.3600

# 661 S Eastwood Dr. (Route 47)

Woodstock, IL 60098

## For Lease

RETAIL / OFFICE

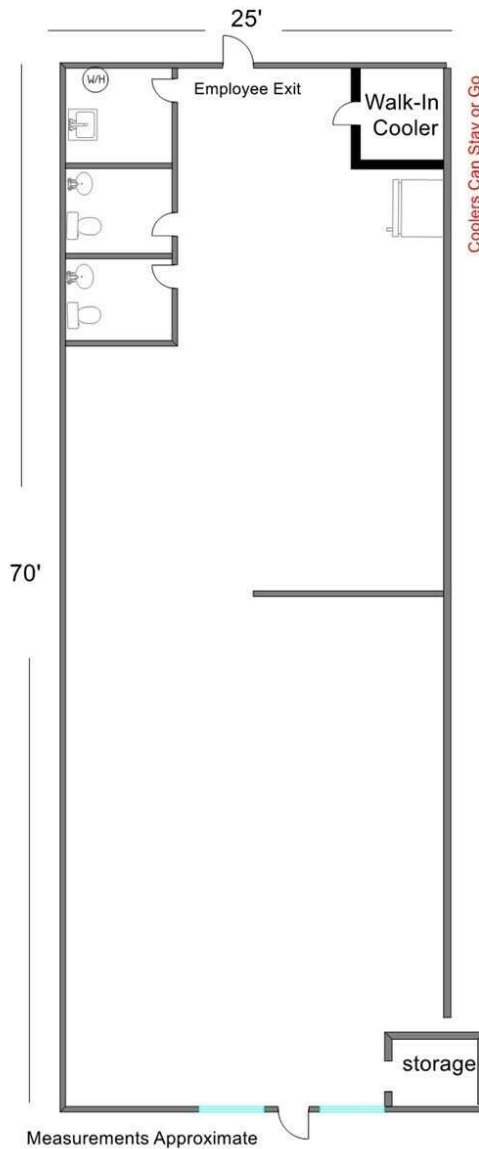

[CLICK HERE TO VIEW OUR WEBSITE](#)

No warranty or representation is made as to the accuracy of the foregoing information. Terms of sale or lease and availability are subject to change or withdrawal without notice. This document is for information purposes only. No offer of sub-agency is being made.



President / Designated Managing Broker  
**Heather Schweitzer**  
HeatherS@PremierCommercialRealty.com  
O: 847.854.2300 x15 C: 815.236.9816

Broker Associate  
**Shari Haefner**  
ShariH@premiercommercialrealty.com  
O: 847.854.2300 x18 C: 312.671.3600

[www.PremierCommercialRealty.com](http://www.PremierCommercialRealty.com) | 847.854.2300 | 9225 S. Route 31, Lake in the Hills, IL 60156



# 661 S Eastwood Dr. (Route 47)

Woodstock, IL 60098

## For Lease

RETAIL / OFFICE



Imagery ©2025 Airbus, Maxar Technologies, Vexcel Imaging US, Inc.

[CLICK HERE TO VIEW OUR WEBSITE](#)

No warranty or representation is made as to the accuracy of the foregoing information. Terms of sale or lease and availability are subject to change or withdrawal without notice. This document is for information purposes only. No offer of sub-agency is being made.



President / Designated Managing Broker  
**Heather Schweitzer**  
HeatherS@PremierCommercialRealty.com  
O: 847.854.2300 x15 C: 815.236.9816

Broker Associate  
**Shari Haefner**  
ShariH@premiercommercialrealty.com  
O: 847.854.2300 x18 C: 312.671.3600

[www.PremierCommercialRealty.com](http://www.PremierCommercialRealty.com) | 847.854.2300 | 9225 S. Route 31, Lake in the Hills, IL 60156