

FOR LEASE

OFFICE/WAREHOUSE 1 RAMP & 1 DOCK HIGH DOOR



10400 NW 55th St. #100, Sunrise, FL 33351 **6,000 +/- SQFT**



- Class 'A' Sawgrass Area
- Zoning I-1 (Light Industrial)
- 32' Clear Ceiling Height
- Dock-high door
- Roll-up door with ramp
- Hurricane impact glass windows & doors
- Tilt-up concrete walls
- High security with gate and cameras
- ESFR Sprinklers / 20+/- Parking spots
- Power 277/480 Volt 3 Phase

Terms Negotiable

Call or text **954-224-8773** for more information!



JOE PELAYO, CCIM, SIOR
 BROKER
 trec@joepelayo.com
954.224.8773



GEORGE PELAYO
 BROKER ASSOCIATE
 george@trecfl.com
954.482.1330



NOTICE: This information has been obtained from sources believed to be reliable but has not been verified. No warranty or representation, express or implied, is made as to the condition/legal adjustments of the property (or properties) referenced or as to the accuracy or completeness of the information contained, and same is submitted subject to errors, omissions, change of price, retail or other conditions, including but not limited to withdrawal without notice, and to any special listing conditions imposed by the property owner.

FOR LEASE

OFFICE/WAREHOUSE 1 RAMP & 1 DOCK HIGH DOOR

10400 NW 55th St. #100, Sunrise, FL 33351

6,000 +/- SQFT



FLOOR PLAN

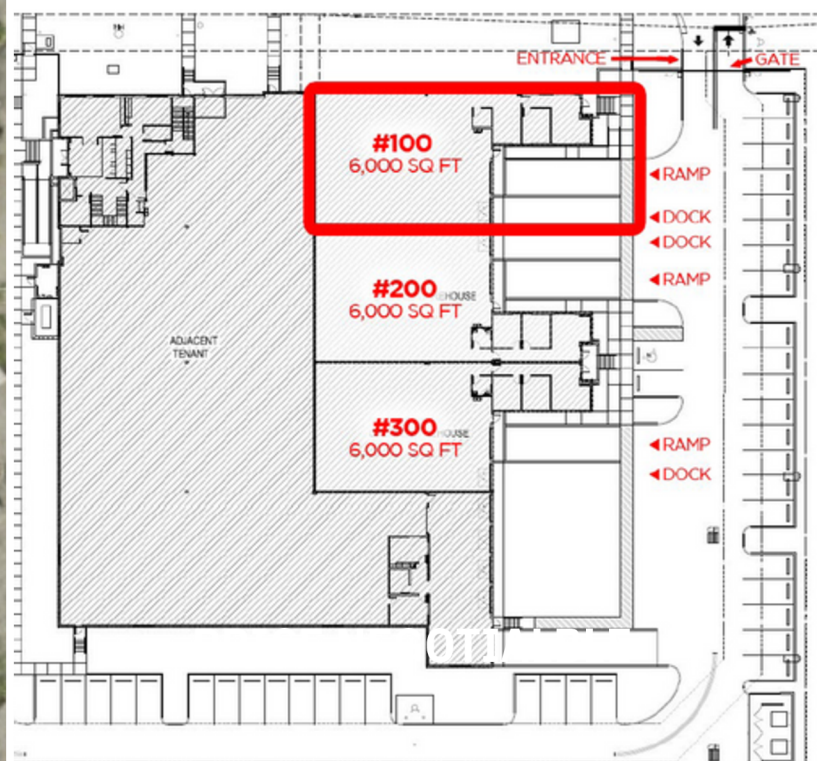

JOE PELAYO, CCIM, SIOR
BROKER
trec@joepelayo.com
954.224.8773

TREC
Total Real Estate Consultants Inc.
www.trecfl.com

GEORGE PELAYO
BROKER ASSOCIATE
george@trecfl.com
954.482.1330



NOTICE: This information has been obtained from sources believed to be reliable but has not been verified. No warranty or representation, express or implied, is made as to the condition/legal adjustments of the property (or properties) referenced or as to the accuracy or completeness of the information contained, and same is submitted subject to errors, omissions, change of price, retail or other conditions, including but not limited to withdrawal without notice, and to any special listing conditions imposed by the property owner.