

FOR LEASE

Owned and Operated by



33rd Street Industrial Center Bldg 7

4240-4288 LB McLeod Road, Orlando, FL 32811

5,760 SF | SUITE 4288



**LEASING INFO
& CONTACT**

Derek Riggleman SIOR

321.281.8507 / driggleman@lee-associates.com

LEE & ASSOCIATES
COMMERCIAL REAL ESTATE SERVICES

This is not an offer or acceptance of an offer to lease space. A lease will only be offered or made in a written agreement signed by landlord. No representation or warranty of any kind is made by landlord unless set forth in a written definitive lease executed by the landlord.

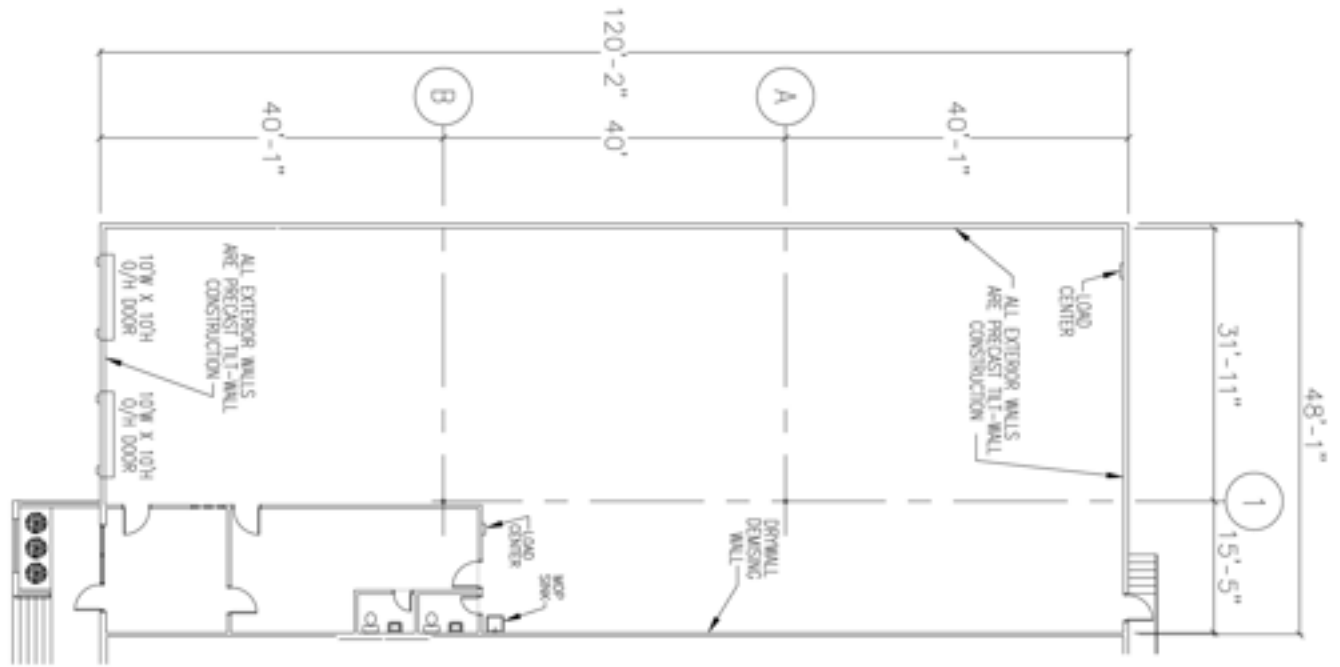

BUILDING DATA

Total Bldg SF:	57,600 SF
Ceiling Height:	18'
Column Spacing:	32'W x 40'D
Parking Ratio:	Up to 1.9/1,000
Fire Protection:	.215 GPM/2,000 SF
Truck Court:	115'
Building Type:	Front Load

LISTING DATA

Available SF:	Suite 4288 - 5,760 SF
Office SF:	660 SF
Warehouse SF:	5,100 SF
Doors:	Two (2) Dock High
Lease Rate:	\$16.95/SF NNN
Op Ex:	\$2.86/SF
Available:	March 1, 2025

