

Downtown Sanford Office/ Retail Spaces

2200 S French Ave, Sanford, FL 32771



Lease Rate: \$19 psf/yr

LOCATION DETAILS

Situated on the corner of W 22nd St and S French Ave, with a traffic count of 26,500 VPD. Just south of Historic Downtown Sanford and less than 3 miles from Orlando Sanford International Airport. Conveniently located less than 5 minutes from SR-417 and under 10 minutes from the SR-429/I-4 interchange, offering easy access across Central Florida.

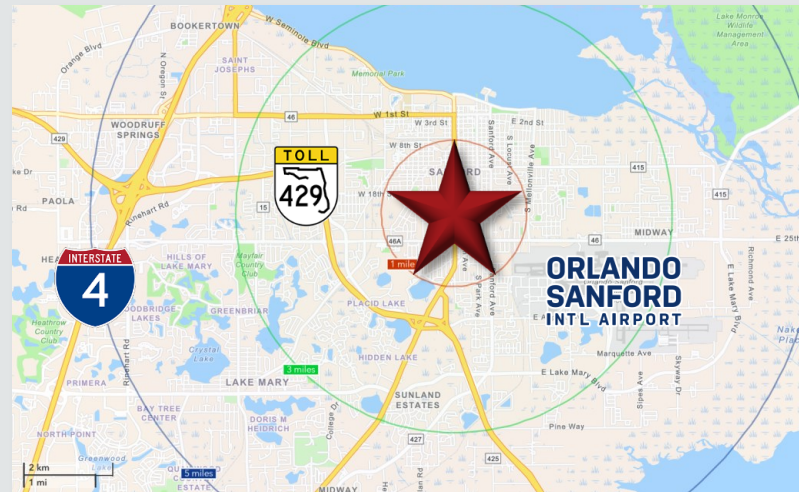

LISTING DETAILS

- **2nd Generation Spaces Available Now:**
 - Ste. 1003-1004: ±1,040 SF
 - Ste. 1005: ±1,320 SF
 - Ste. 1006: ±1,170 SF
- Building signage visible from S French Ave
- **13 Shared parking spaces** with additional overflow parking also available
- **Electric included**

2024 DEMOGRAPHICS	1-MILE	3-MILE	5-MILE
Population	10,915	60,132	106,384
Average HH Income	\$84,649	\$87,001	\$104,246
Median HH Income	\$59,577	\$64,656	\$75,902

CONTACT FOR MORE INFORMATION

Marie Shorey, CCIM
(407) 383-8142
marie@palkiper.com

Downtown Sanford Office/ Retail Spaces

2200 S French Ave, Sanford, FL 32771

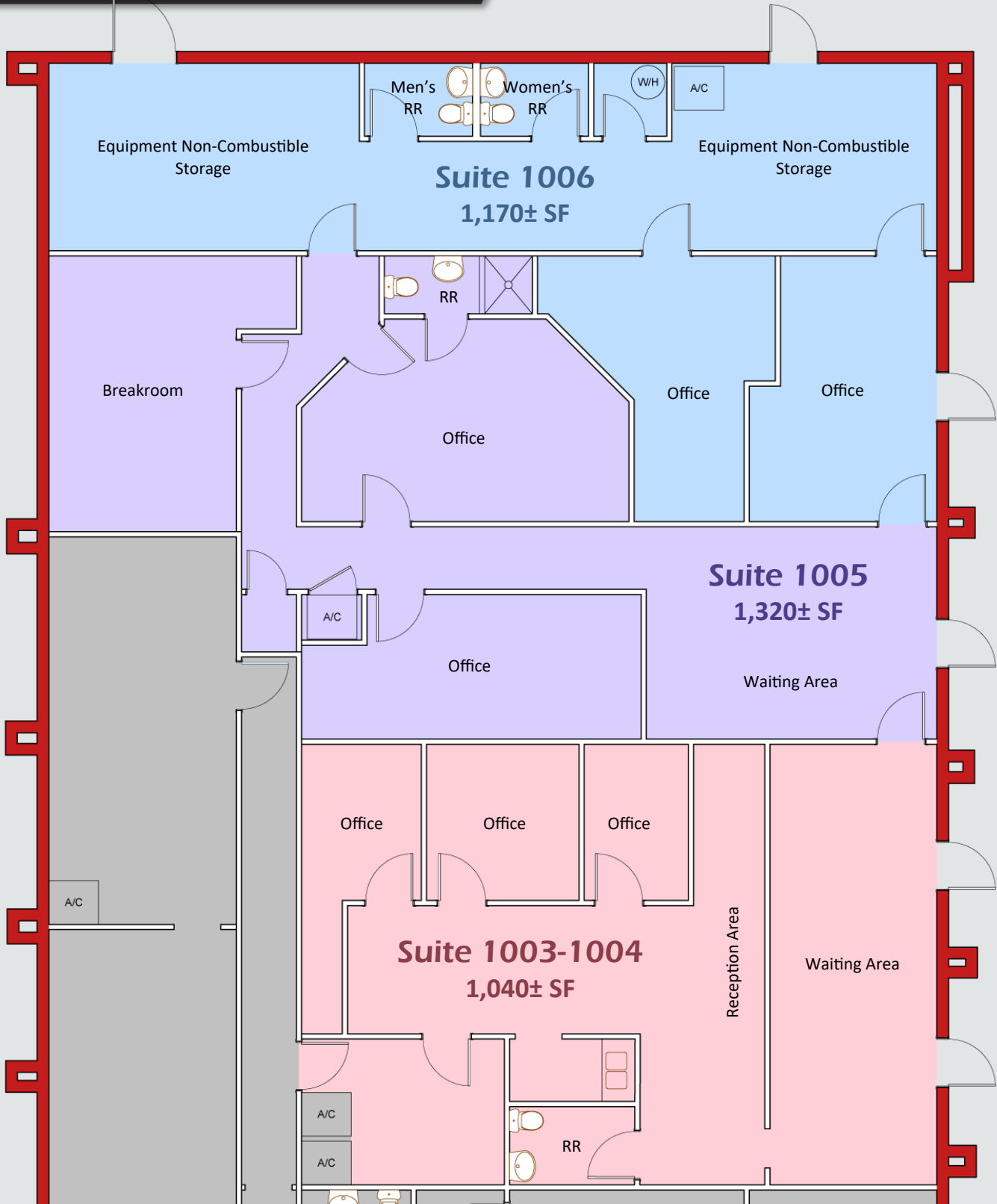

CONTACT FOR MORE INFORMATION

Marie Shorey, CCIM
(407) 383-8142
marie@palkiper.com

Downtown Sanford Office/ Retail Spaces

2200 S French Ave, Sanford, FL 32771

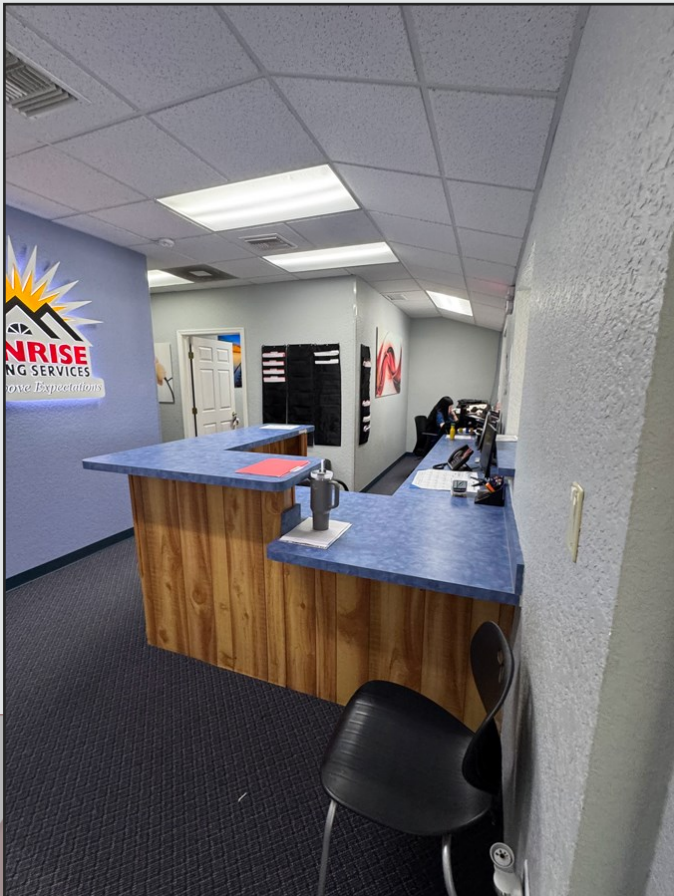

CONTACT FOR MORE INFORMATION

Marie Shorey, CCIM
(407) 383-8142
marie@palkiper.com

Downtown Sanford Office/ Retail Spaces

2200 S French Ave, Sanford, FL 32771

 **Palkiper**
Commercial Real Estate Services
Licensed Real Estate Broker

SUITE 1005



CONTACT FOR MORE INFORMATION

Marie Shorey, CCIM
(407) 383-8142
marie@palkiper.com