



3350 HANSON STREET, UNIT F | FORT MYERS, FL 33916

5,000± SF WAREHOUSE SPACE AVAILABLE

FOR LEASE

CONTACT

Chase Mayhugh, SIOR, CCIM
239-278-4945
chase@mayhughcommercial.com

Chris Ferritto
239-310-6257
chris@mayhughcommercial.com

Exceptional Industrial Warehouse Space for Lease

This 5,000± SF warehouse, located at the prominent corner of Hanson St & Work Drive, is zoned for Industrial Heavy use. This versatile space is ideal for a variety of business operations with two 12'x12' overhead doors, two restrooms, and two offices. New roof and insulation installed in 2023. With its strategic location and robust features, this warehouse is perfectly suited for businesses looking to optimize their operations. **Call us to arrange a tour.**

PROPERTY DETAILS

ZONING	IH (City of Fort Myers)
YEAR BUILT	1975
SIZE	5,000± SF
AVAILABLE	Available Immediately
LEASE RATE	\$13.95 p/s/f
CAM	\$3.44 p/s/f CAM/OPEX
MONTHLY RATE	\$7,245.83/month + sales tax
OH DOORS	Two 12'x12' doors
RESTROOMS	Two (2)



MAYHUGH
COMMERCIAL ADVISORS

13099 S. Cleveland Ave. Suite 410
Fort Myers, FL 33907

MAYHUGHCOMMERCIAL.COM

FLOORPLAN

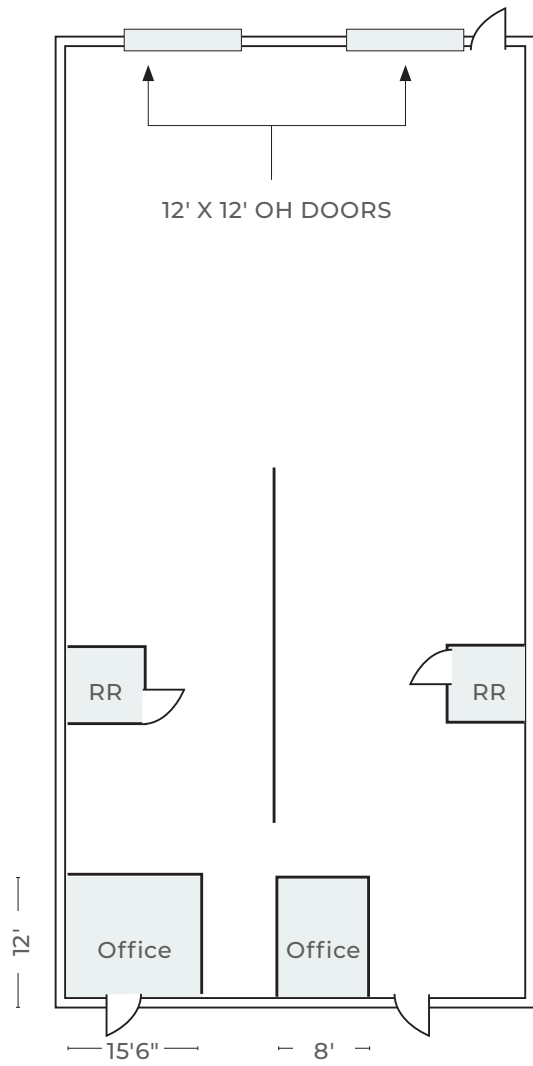

This floorplan is provided for illustrative purposes only and is not drawn to scale.





This marketing brochure serves as a reference for informational purposes only and does not constitute an offer for sale or lease, nor does it serve as a solicitation for an offer to purchase or lease. While the information contained herein is believed to be reliable, its accuracy, completeness, or reliability cannot be guaranteed. Prospective buyers or lessees are encouraged to conduct their own investigations and due diligence to verify the information provided. All descriptions, dimensions, conditions, permissions for use, and other details are offered in good faith but are subject to verification. No express or implied warranty or representation is made regarding the accuracy of the information herein. The content is subject to errors, omissions, price changes, withdrawal without notice, and any special listing conditions imposed by our principals.