



SPACE AVAILABLE FOR LEASE

 1650 Tropic Park Drive,
Sanford 32773

Pricing:

\$16/SF



ALPHA
EQUITY
REALTY & MANAGEMENT

PROPERTY HIGHLIGHTS:

- α High Ceilings
- α Floor-to-Ceilings Bay Doors
- α Full-sized Glass Doors
- α Ample Parking
- α Oversized Bay Windows
- α Accessibility



Mac Jaffer
516-554-5775
leasing@alphaacq.com

1650 Tropic Park Drive,
Sanford 32773

Alpha Equity does not represent or warranty the accuracy of the information contained herein. Such information has been given to Alpha Equity by the owner of the property or obtained from other sources deemed reliable. Alpha Equity has no reason to doubt its accuracy, but does not guarantee it. The reviewer(s) of this document is encouraged to perform their own research for their own purposes to verify the dependability of the information being reviewed. All information should be verified by reviewer(s) prior to purchase or lease. Unless otherwise noted, the property is being offered as-is, where is, with all faults.



Mac Jaffer
516-554-5775
leasing@alphaacq.com

1650 Tropic Park Drive
Sanford, FL 32773

Alpha Equity does not represent or warranty the accuracy of the information contained herein. Such information has been given to Alpha Equity by the owner of the property or obtained from other sources deemed reliable. Alpha Equity has no reason to doubt its accuracy, but does not guarantee it. The reviewer(s) of this document is encouraged to perform their own research for their own purposes to verify the dependability of the information being reviewed. All information should be verified by reviewer(s) prior to purchase or lease. Unless otherwise noted, the property is being offered as-is, where is, with all faults.



3D TOUR

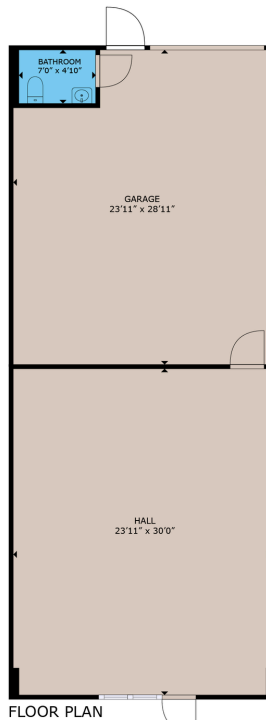

GROSS INTERNAL AREA
FLOOR PLAN: 713 sq. ft.
EXCLUDED AREA: GARAGE: 713 sq. ft.
SIZES AND DIMENSIONS ARE APPROXIMATE; ACTUAL MAY VARY.



Mac Jaffer
516-554-5775
leasing@alphaacq.com

1650 Tropic Park Drive,
Sanford, FL 32773

Alpha Equity does not represent or warranty the accuracy of the information contained herein. Such information has been given to Alpha Equity by the owner of the property or obtained from other sources deemed reliable. Alpha Equity has no reason to doubt its accuracy, but does not guarantee it. The reviewer(s) of this document is encouraged to perform their own research for their own purposes to verify the dependability of the information being reviewed. All information should be verified by reviewer(s) prior to purchase or lease. Unless otherwise noted, the property is being offered as-is, where is, with all faults.



Tropic Park Drive



**ALPHA
EQUITY**
REALTY & MANAGEMENT

Alpha Equity Realty & Management
1485 International Parkway #2001
Lake Mary, FL 32746

www.recfl.com



MAC JAFFER

516-554-5775

leasing@alphaacq.com