



Altamonte Capital Center



MEDICAL / OFFICE SPACE FOR LEASE

249 & 251 Maitland Ave., Altamonte Springs, FL 32701

Contact: Dan Van Nada, CCIM
Vice President of Brokerage Services

E: Dan@FCPG.com
P: 407.872.0177 ext. 117

Contact: Ben Kuykendall
Sales & Leasing Associate

E: Ben@FCPG.com
P: 407.872.0177 ext. 131

For Lease: Inquire For Rate, Full Service

± 515 - 1,047 RSF Available

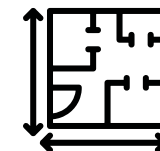

FLEXIBLE SUITE LAYOUTS AVAILABLE

Under new management & ownership: extensive building renovations recently completed

On-site parking with a ratio of 7 / 1,000

Prominent monument signage available

Strategically located just South of high-traffic Semoran Blvd / SR 436 (AADT 62,000) and 4 minutes from I-4 interchange

Varied suite layouts available for high degree of flexibility and customization

Within 1 mile of Florida Hospital, Uptown Altamonte / Cranes Roost, Altamonte Mall, Sunrail Station and Eastmonte Park

DEMOGRAPHICS

2024



Total Population



Total Households



Average HH Income

1 Mile

9,239

4,528

\$155,676

3 Miles

99,588

45,108

\$115,733

5 Miles

271,966

118,408

\$114,077

615 E. Colonial Dr., Orlando, FL 32803 Phone: 407.872.0209 www.FCPG.com

Information furnished regarding the subject property is believed to be accurate, but no guarantee or representation is made. References to square footage are approximate. This offering is subject to errors, omissions, prior sale or lease or withdrawal without notice. ©2024 First Capital Property Group, Inc., Licensed Real Estate Brokers & Managers.

LOCATION

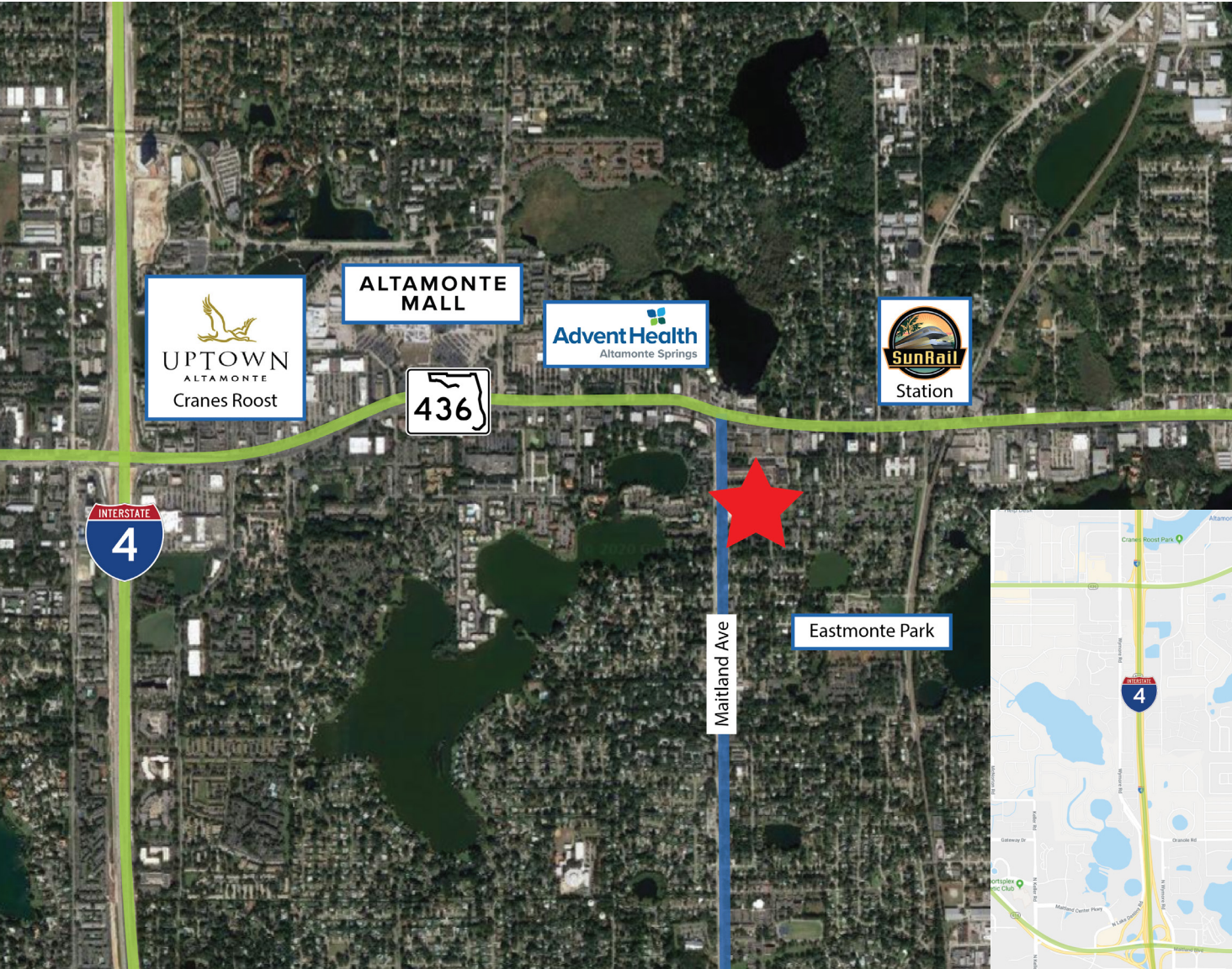

\$114,077
AVERAGE HH INCOME
WITHIN 5 MILE RADIUS



118,408
HOUSEHOLDS
WITHIN 5 MILE RADIUS

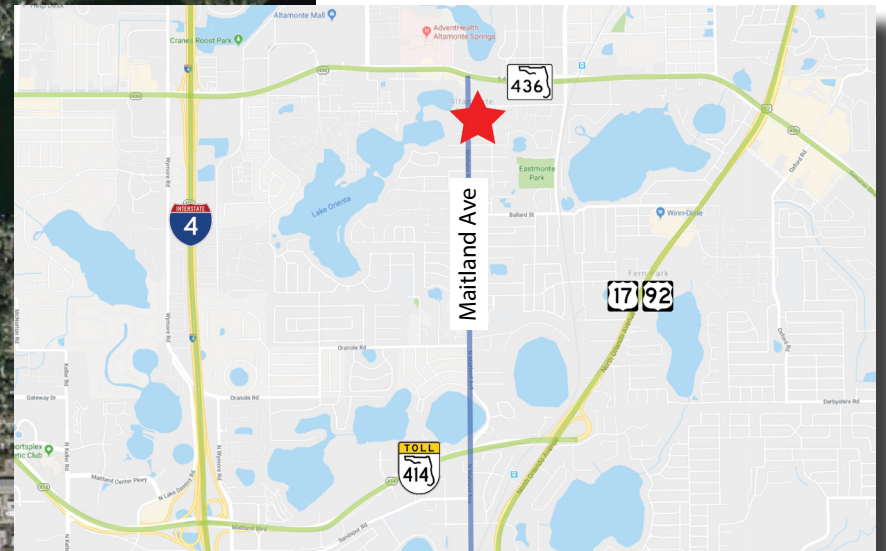

■ 615 E. Colonial Dr., Orlando, FL 32803 ■ Phone: 407.872.0209 ■ www.FCPG.com ■

Information furnished regarding the subject property is believed to be accurate, but no guarantee or representation is made. References to square footage are approximate. This offering is subject to errors, omissions, prior sale or lease or withdrawal without notice. ©2024 First Capital Property Group, Inc., Licensed Real Estate Brokers & Managers.

AVAILABILITY

AVAILABLE IMMEDIATELY

Building 251

Suite 212: 515 RSF

Suite 302: 1,047 RSF



Floorplans Available by Request.

■ 615 E. Colonial Dr., Orlando, FL 32803 ■ Phone: 407.872.0209 ■ www.FCPG.com ■

Information furnished regarding the subject property is believed to be accurate, but no guarantee or representation is made. References to square footage are approximate. This offering is subject to errors, omissions, prior sale or lease or withdrawal without notice. ©2024 First Capital Property Group, Inc., Licensed Real Estate Brokers & Managers.

