



# RETAIL SPACE FOR LEASE

530 N. Bumby Ave, Orlando, FL 32803

Contact: Dan Van Nada, CCIM  
Vice President of Brokerage Services

E: Dan@FCPG.com  
P: 407.872.0177 ext. 117

Contact: Ben Kuykendall  
Sales & Leasing Associate

E: Ben@FCPG.com  
P: 407.872.0177 ext. 131

**For Lease: \$28.00 / RSF, NNN**

Full Building: ± 3,052 RSF



**DAYTIME POPULATION**  
**262,721**  
3 Mile Radius

Prominent property in the heart of Orlando's Milk District, a top local neighborhood for experiential retail

Features large pylon signage along busy Bumby Ave. (17,200 AADT), located 3 blocks south of E. Colonial Dr. (41,500 AADT)

Adjacent to Colonial Plaza, a 500,000 SF power center featuring Sprouts, Hobby Lobby, Total Wine and other national retailers

Minutes from affluent Orlando neighborhoods including Baldwin Park, Audubon Park, Mills 50, and Colonialtown

Large open layout offers a blank canvas for a variety of creative and engaging uses

MU-1/T Zoning allows for a variety of uses alongside co-tenant More Space Place

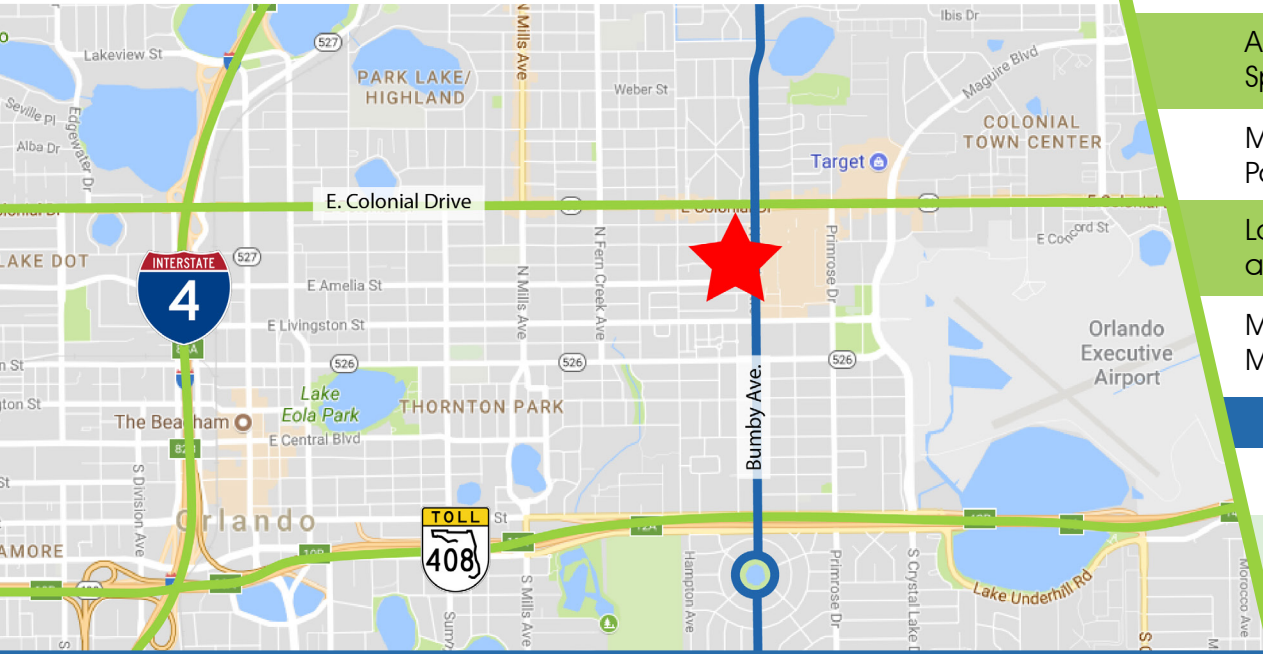

## DEMOGRAPHICS

**2024**

**1 Mile**

**3 Miles**

**5 Miles**



Total Population

10,838

122,379

304,699



Total Households

5,679

57,559

130,610



Average HH Income

\$131,536

\$126,178

\$111,482

615 E. Colonial Dr., Orlando, FL 32803 Phone: 407.872.0209 www.FCPG.com

Information furnished regarding the subject property is believed to be accurate, but no guarantee or representation is made. References to square footage are approximate. This offering is subject to errors, omissions, prior sale or lease or withdrawal without notice. ©2024 First Capital Property Group, Inc., Licensed Real Estate Brokers & Managers.

# FLOORPLAN

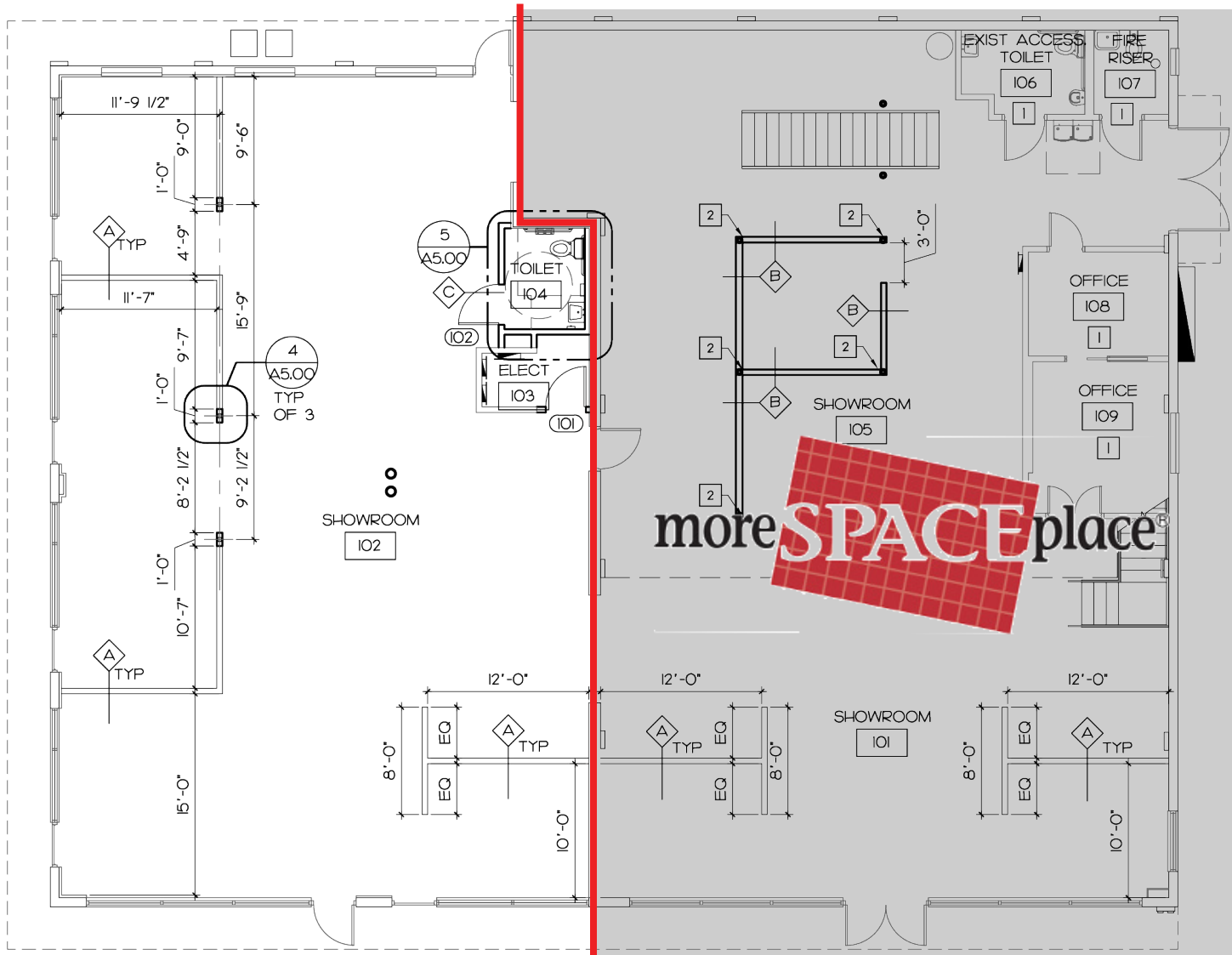

615 E. Colonial Dr., Orlando, FL 32803 Phone: 407.872.0209 www.FCPG.com

Information furnished regarding the subject property is believed to be accurate, but no guarantee or representation is made. References to square footage are approximate. This offering is subject to errors, omissions, prior sale or lease or withdrawal without notice. ©2024 First Capital Property Group, Inc., Licensed Real Estate Brokers & Managers.

# NEIGHBORHOOD MAP

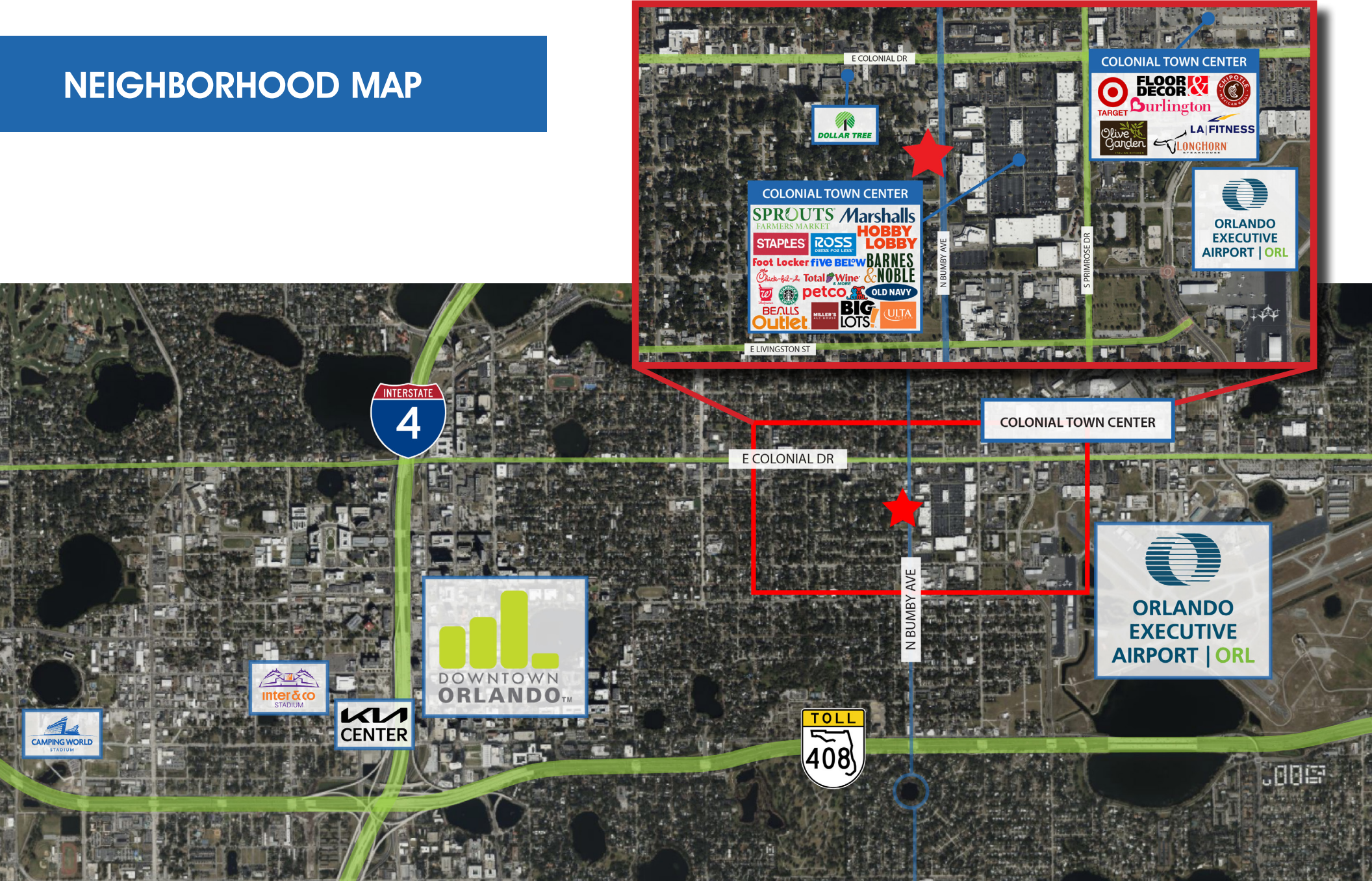

615 E. Colonial Dr., Orlando, FL 32803 Phone: 407.872.0209 www.FCPG.com

Information furnished regarding the subject property is believed to be accurate, but no guarantee or representation is made. References to square footage are approximate. This offering is subject to errors, omissions, prior sale or lease or withdrawal without notice. ©2024 First Capital Property Group, Inc., Licensed Real Estate Brokers & Managers.