

LOCATION MAP (N.T.S.)

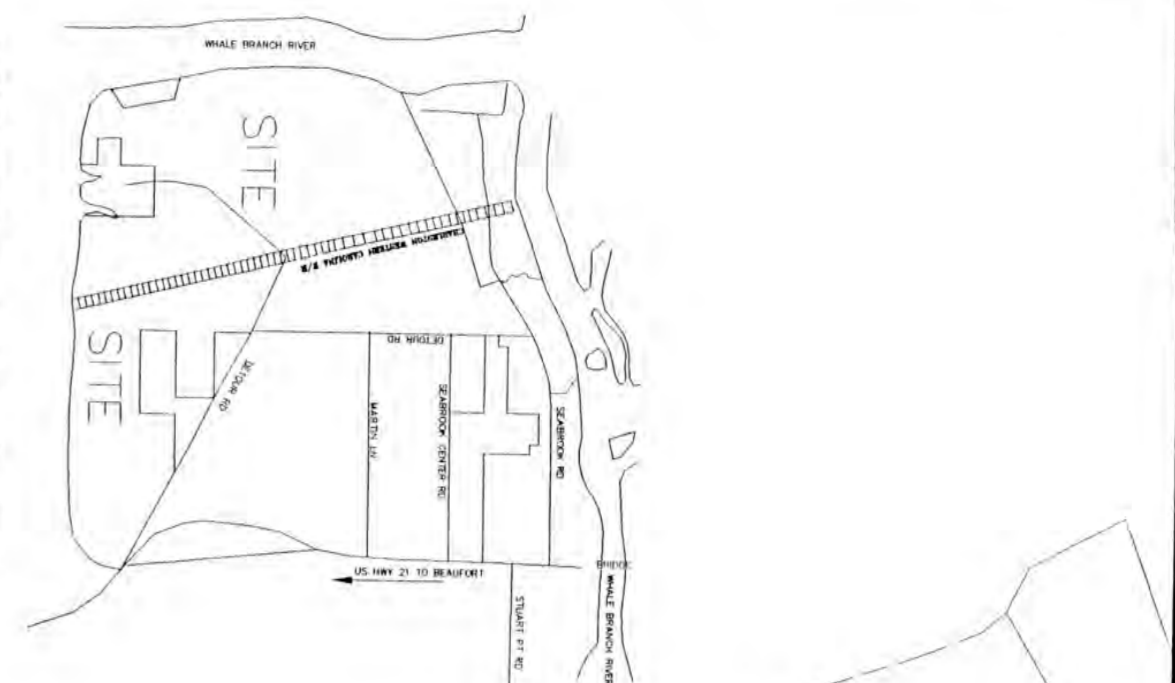

- REFERENCES:
- 1) T.M.S. 100-0013-46, 47, 48, 48A, 49, 49, 52
 - 2) T.M.S. 100-0013-10
 - 3) PLAT BY R. D. TROGSON, JR. BEAUFORT COUNTY R.M.C. OFFICE DATED 06/28/87 LAST REVISED 06/16/88
 - 4) PLAT BY R. D. TROGSON, JR. BEAUFORT COUNTY R.M.C. OFFICE DATED 07/21/78
 - 5) PLAT BY R. D. TROGSON, JR. BEAUFORT COUNTY R.M.C. OFFICE DATED 06/28/87 LAST REVISED 04/11/79
 - 6) PLAT BY R. D. TROGSON, JR. BEAUFORT COUNTY R.M.C. OFFICE DATED 02/09/77 LAST REVISED 04/11/79
 - 7) PLAT BY R. D. TROGSON, JR. BEAUFORT COUNTY R.M.C. OFFICE DATED 04/26/83
 - 8) PLAT BY HOBSON SURVEYING ASSOCIATES BEAUFORT COUNTY R.M.C. OFFICE DATED 06/28/83
 - 9) PLAT BY W. COUNTY R.M.C. OFFICE BEAUFORT COUNTY R.M.C. OFFICE DATED 06/28/88
 - 10) PLAT BY DAVID S. YOUNG BEAUFORT COUNTY R.M.C. OFFICE DATED 06/28/88
 - 11) WETLANDS FLAGGED AND DELINEATED BY NEWMARK ENVIRONMENTAL AND APPROVED BY BEAUFORT COUNTY R.M.C. OFFICE ON 6/9/06. SURVEY COPIES OF ENGINEERS ON WETLANDS PLAT BY GASQUE DATED 5/24/06.

- NOTES:
- 1) BEARINGS SHOWN HEREON ARE MAGNETIC AND AS SUCH ARE SUBJECT TO LOCAL ATTRACTION.
 - 2) ON COORDINATE METHOD.
 - 3) INDICATIONS OF NEIGHBORING LOTS ARE FROM SURFACE REFERENCES ONLY AND ARE NOT CERTIFIABLE.
 - 4) THIS PLAT REPRESENTS A SURVEY BASED ON THE LISTED REFERENCES ONLY AND IS NOT THE RESULT OF A TITLE SEARCH.
 - 5) CERTIFICATIONS ARE NOT TRANSFERABLE TO ADDITIONAL REFERENCES.
 - 6) BEFORE ANY DESIGN OR CONSTRUCTION ACTION ON THIS SITE IS STARTED FLOOD ZONE INFORMATION MUST BE VERIFIED BY BEAUFORT COUNTY BUILDING CODES.
 - 7) THIS PROPERTY APPEARS TO LIE IN FLOOD ZONES 7C & A-11 EL. 13.00' AS DETERMINED BY F.E.M.A. FIRM COM-PANEL NUMBER 450025 DATED 09/29/88 (NOOK DATE 11/04/92).
 - 8) THERE ARE UNDEVELOPED DIRT ROADS AND DITCHES OVER AND ACROSS SUBJECT PROPERTY.
 - 9) CONSERVATION EASEMENT BEING FILED CONTEMPORANEOUSLY ALONG A 20 ACRE RESIDENTIAL DEVELOPMENT WITH 16 UNITS TO BE LOCATED IN THE WESTERN AREA AS SHOWN ON EXHIBIT C TO THE CONSERVATION EASEMENT.

GASQUE & ASSOCIATES INC.
LAND SURVEYORS - PLANNERS
 28 PROFESSIONAL VILLAGE CIRCLE, BEAUFORT, S.C.
 P. O. BOX 1363, BEAUFORT, S.C.
 (843) 522-1798

THIS PLAT IS COMPRISED AND IS ONLY INTENDED FOR THE USE OF THE ENTRY OR PERSON(S) SHOWN HERE ON.

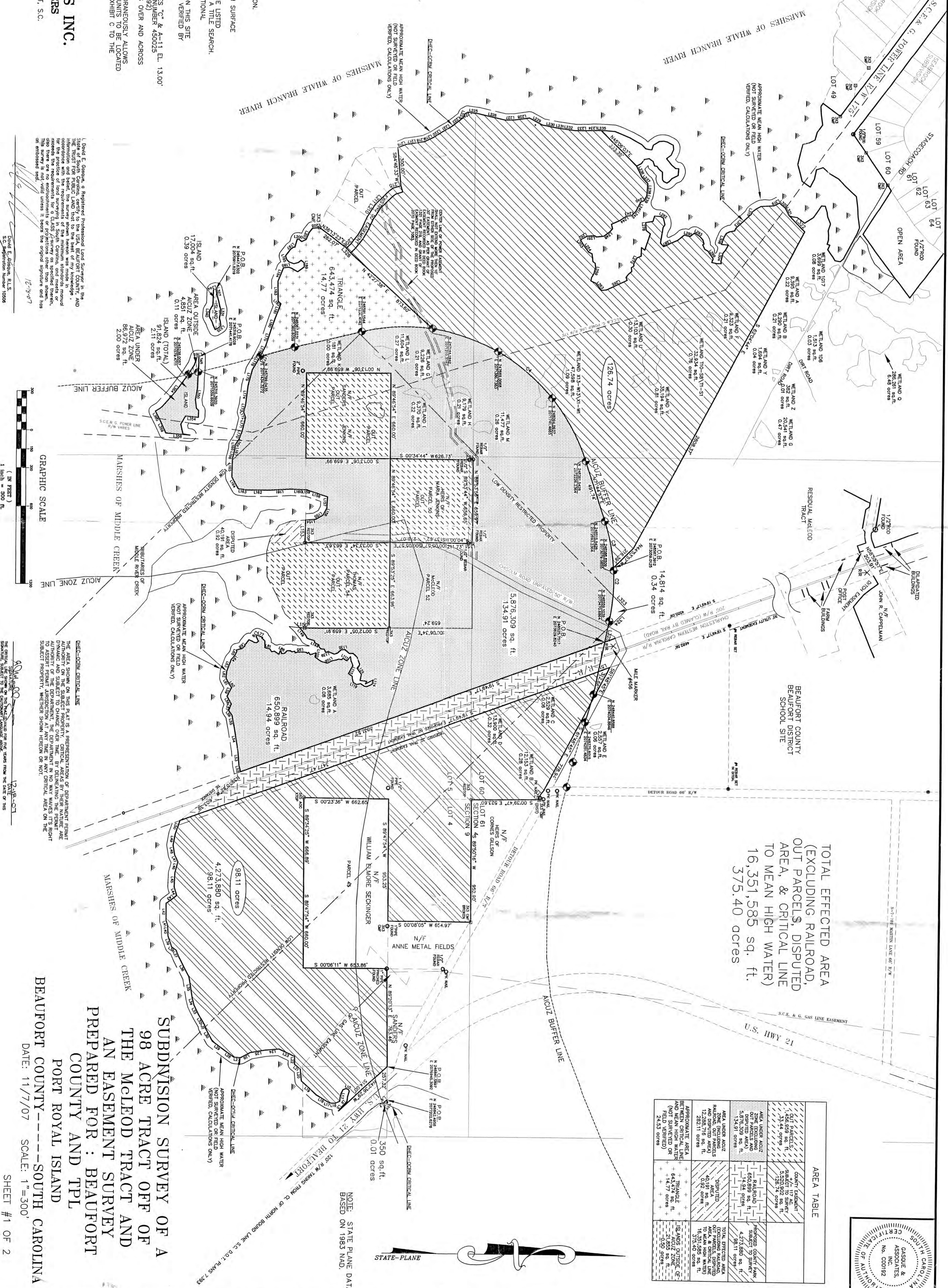

TOTAL EFFECTED AREA
 (EXCLUDING RAILROAD,
 OUT PARCELS, DISPUTED
 AREA, & CRITICAL LINE
 TO MEAN HIGH WATER)
 16,351,585 sq. ft.
 375.40 acres

AREA TABLE	ACRES	SQ. FT.
APPROXIMATE AREA OF SUBJECT PROPERTY	16,351.585	16,351,585
APPROXIMATE AREA OF SUBJECT PROPERTY EXCLUDING RAILROAD, OUT PARCELS, DISPUTED AREA, & CRITICAL LINE TO MEAN HIGH WATER	16,351.585	16,351,585
APPROXIMATE AREA OF SUBJECT PROPERTY EXCLUDING RAILROAD, OUT PARCELS, DISPUTED AREA, & CRITICAL LINE TO MEAN HIGH WATER AND MEAN HIGH WATER	16,351.585	16,351,585
APPROXIMATE AREA OF SUBJECT PROPERTY EXCLUDING RAILROAD, OUT PARCELS, DISPUTED AREA, & CRITICAL LINE TO MEAN HIGH WATER AND MEAN HIGH WATER AND MEAN HIGH WATER AND MEAN HIGH WATER	16,351.585	16,351,585

**SUBDIVISION SURVEY OF A
 98 ACRE TRACT OFF OF
 THE MCLEOD TRACT AND
 AN EASEMENT SURVEY
 PREPARED FOR: BEAUFORT
 COUNTY AND TPL
 PORT ROYAL ISLAND
 BEAUFORT COUNTY - SOUTH CAROLINA
 DATE: 11/7/07 SCALE: 1"=300'**

SHEET #1 OF 2
 SHEET #2 OF 2
 SHEET #3 OF 2

DATE: 11/7/07 SCALE: 1"=300'

DATE: 11/7/07 SCALE: 1"=300'

DATE: 11/7/07 SCALE: 1"=300'

DATE: 11/7/07 SCALE: 1"=300'