

**FOR  
LEASE**

# CHURCH/OFFICE/RETAIL SPACE FOR LEASE

**6827 N. ORANGE BLOSSOM TRAIL ORLANDO, FL**



## **PROPERTY HIGHLIGHTS**

- 16,945 SF Shopping Center on busy HW 441
- 1.93 Acre site zoned C-1 with 4/1000 parking ratio (Orange County)
- Curb cut for easy access from either direction from the highway
- Building and pylon signage, glass store front entry, new LED lighting
- Close to Rose Ave, Maitland Blvd, Edgewater Drive, Lee Rd and 429 located on HW 441 in Lockhart
- Units 1 & 2: 2,725 SF Former Church. *Rent is \$5,500 NNN*
- Unit 3: 1350 SF Retail Unit Former Spa. *Rent is \$2,500 NNN.*
- Unit 5: 1,350 SF Retail Unit Former Barber. *Rent is \$2,500 NNN*
- Unit 7: 2,050 SF Former Church: *Rent is \$4,100 NNN*

**5-10 Year Lease Terms (see broker for details)**

This information is from sources we deem reliable and is subject to prior sale, lease, withdrawal without notice, or change in prices, rates, or conditions. No representation is made as to the accuracy of any information furnished.

## **CONTACT**

Vincent F. Wolle, CCIM, SIOR  
407.448.1823 *mobile*  
CREManager@Gmail.com

**Results Real Estate Partners, LLC**  
*Licensed Commercial Real Estate Brokers*  
108 Commerce Street, Suite 200  
Lake Mary, Florida 32746

407.647.0200 *main*  
407.647.0205 *fax*

**www.ResultsREPartners.com**



**FOR  
LEASE**

# CHURCH/OFFICE/RETAIL SPACE FOR LEASE

**6827 N. ORANGE BLOSSOM TRAIL ORLANDO, FL**

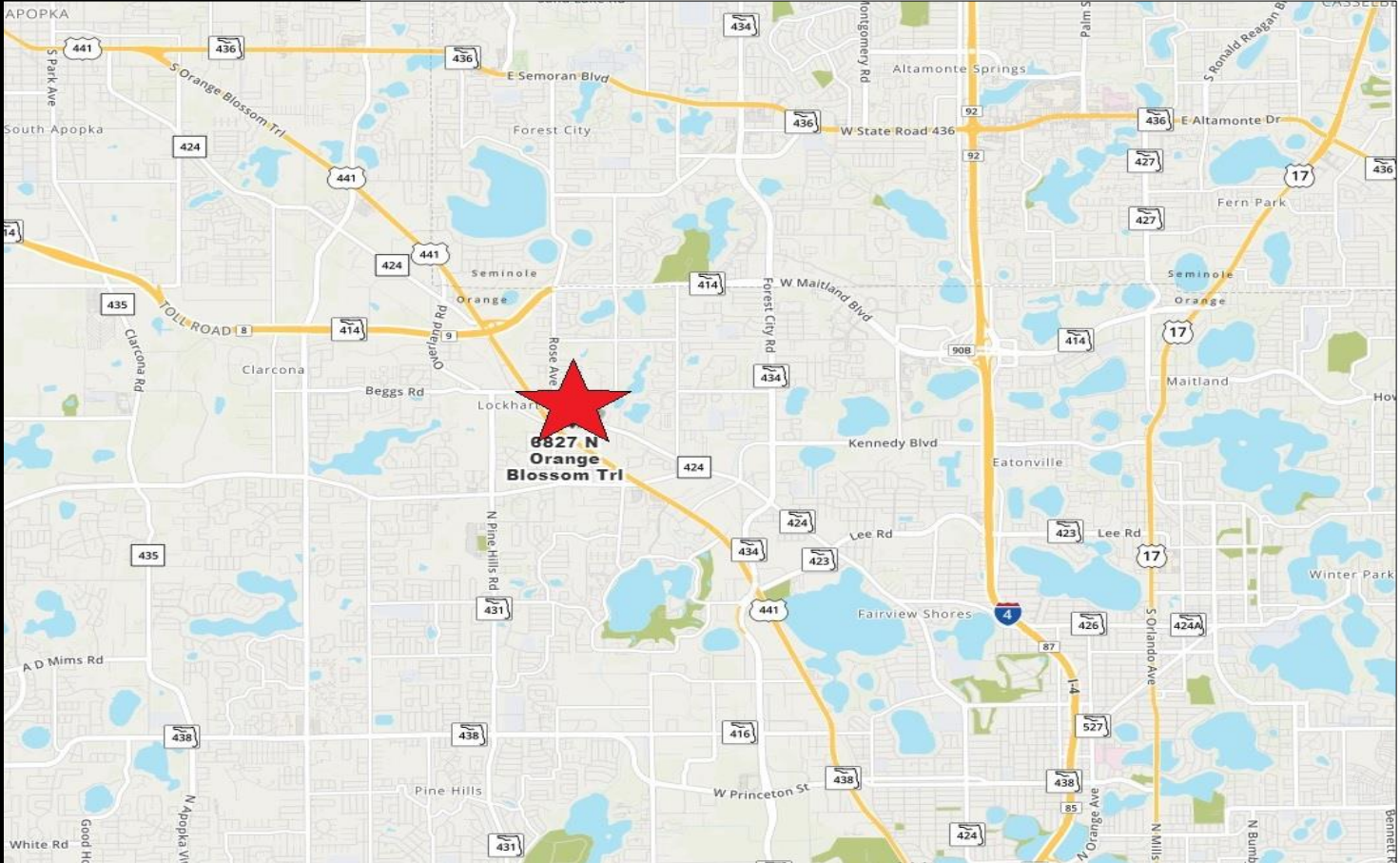

## CONTACT

Vincent F. Wolle, CCIM, SIOR  
407.448.1823 *mobile*  
CREManager@Gmail.com

**Results Real Estate Partners, LLC**  
*Licensed Commercial Real Estate Brokers*  
108 Commerce Street, Suite 200  
Lake Mary, Florida 32746

407.647.0200 *main*  
407.647.0205 *fax*

[www.ResultsREPartners.com](http://www.ResultsREPartners.com)



This information is from sources we deem reliable and is subject to prior sale, lease, withdrawal without notice, or change in prices, rates, or conditions. No representation is made as to the accuracy of any information furnished.

**FOR  
LEASE**

# CHURCH/OFFICE/RETAIL SPACE FOR LEASE

**6827 N. ORANGE BLOSSOM TRAIL ORLANDO, FL**

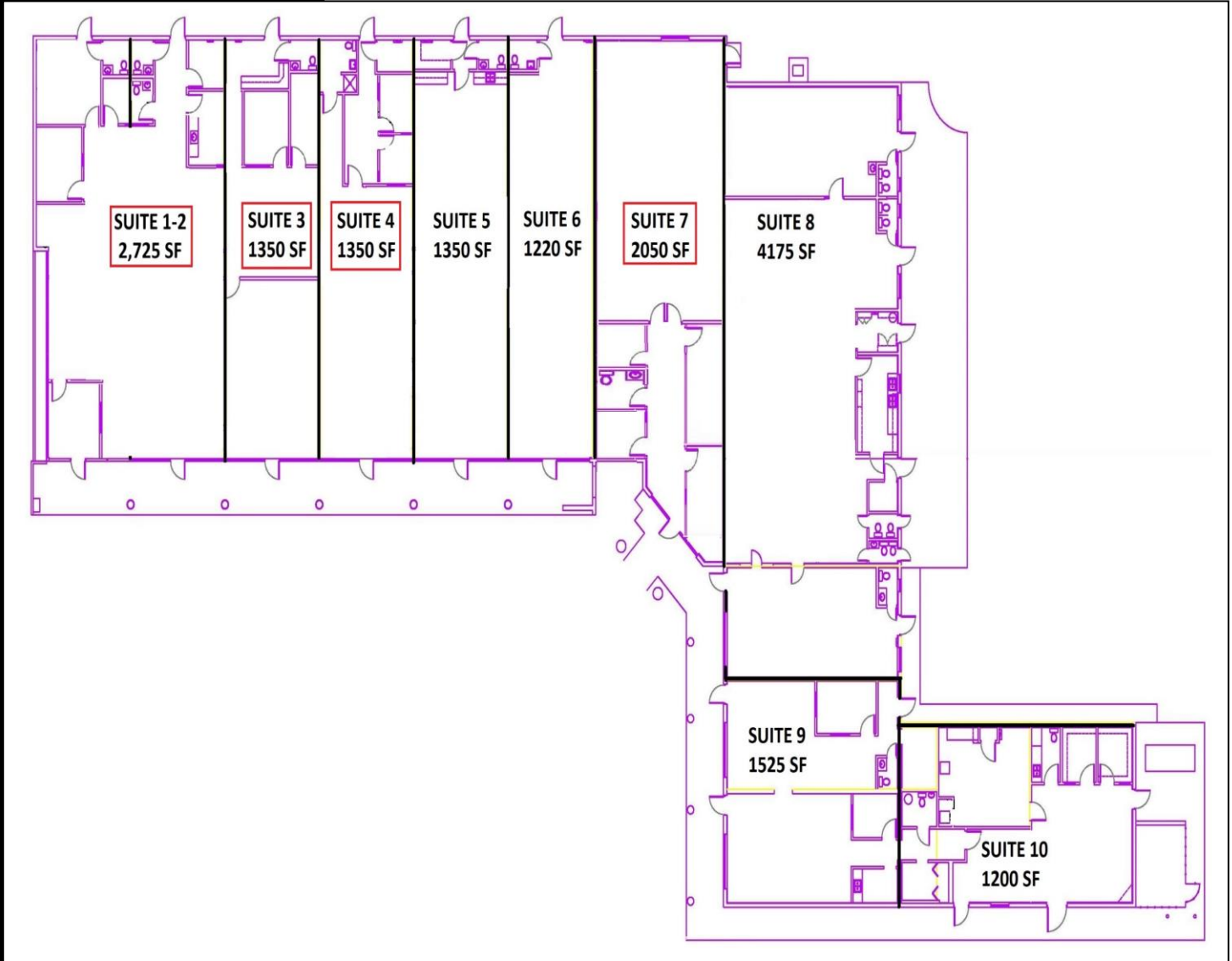

## CONTACT

Vincent F. Wolle, CCIM, SIOR  
407.448.1823 *mobile*  
CREManager@Gmail.com

### Results Real Estate Partners, LLC

*Licensed Commercial Real Estate Brokers*  
108 Commerce Street, Suite 200  
Lake Mary, Florida 32746

407.647.0200 *main*  
407.647.0205 *fax*

[www.ResultsREPartners.com](http://www.ResultsREPartners.com)



This information is from sources we deem reliable and is subject to prior sale, lease, withdrawal without notice, or change in prices, rates, or conditions. No representation is made as to the accuracy of any information furnished.