

# PRIME COMMERCIAL SPACE AVAILABLE

2334 S. Semoran Blvd  
Orlando, FL 32822



FOR LEASE



# PROPERTY DESCRIPTION

Prime retail spaces are available now for lease. The units are brand new construction (2024) and are available for a variety of retail/professional office uses.

## Property Highlights

- The spaces range from 750 SF up to 1,250 SF.
- The property is approximately six miles from Orlando International Airport and from Downtown Orlando.
- Abundant parking available in front of suites
- Direct access to property from S. Semoran Boulevard (State Road 436; 59,500 AADT)

## Site Details

- **Address:** 2334 South Semoran Boulevard Orlando, FL 32822
- **Use:** Retail and Professional Office (no restaurants)
- **Signage:** Monument and Facade Signage
- **Delivery:** Space will be delivered in warm grey shell condition (restrooms stubbed out)
- **Rates:** Call for Rates

# PROPERTY PHOTOS



## AVAILABLE FLOOR PLANS

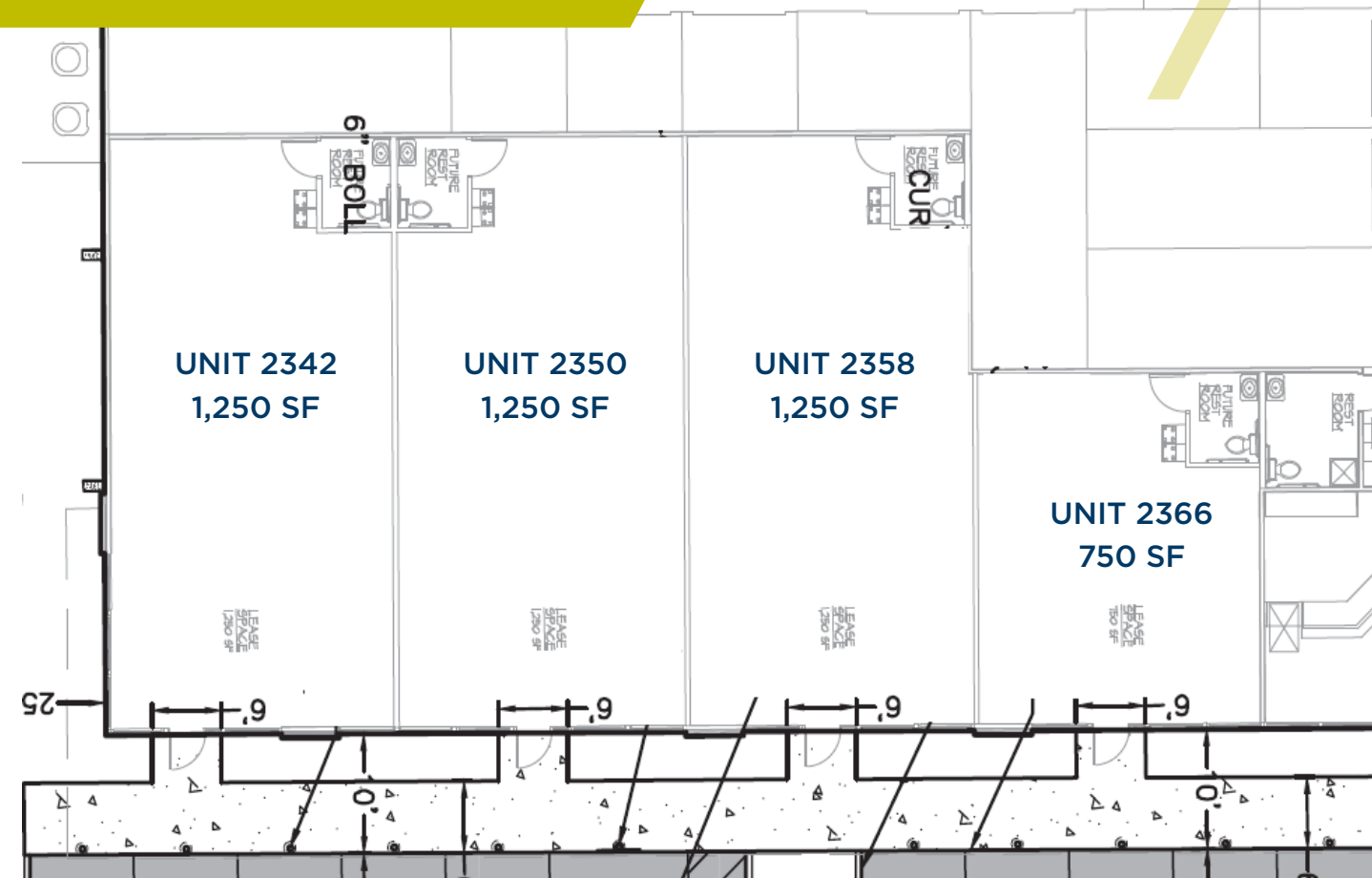

## MONUMENT AND FACADE SIGNAGE



## WARM GREY SHELL DELIVERY

# NEARBY AMENITIES



## AREA DEMOGRAPHICS



### POPULATION

1 Miles	24,866
3 Miles	127,595
5 Miles	285,991



### AVERAGE HH INCOME

1 Miles	\$61,490
3 Miles	\$70,379
5 Miles	\$87,371



### MEDIAN HOME VALUE

1 Miles	\$190,300
3 Miles	\$246,709
5 Miles	\$291,375

For more information, please contact:

**AMY FOOTE**  
Senior Associate  
Direct +1 407 541 4411  
Mobile +1 407 451 5171  
amy.foote@cushwake.com

**GLEN JAFFEE**  
Senior Director  
Direct +1 407 541 4408  
Mobile +1 407 353 3426  
glen.jaffee@cushwake.com



©2024 Cushman & Wakefield. All rights reserved. The information contained in this communication is strictly confidential. This information has been obtained from sources believed to be reliable but has not been verified. NO WARRANTY OR REPRESENTATION, EXPRESS OR IMPLIED, IS MADE AS TO THE CONDITION OF THE PROPERTY (OR PROPERTIES) REFERENCED HEREIN OR AS TO THE ACCURACY OR COMPLETENESS OF THE INFORMATION CONTAINED HEREIN, AND SAME IS SUBMITTED SUBJECT TO ERRORS, OMISSIONS, CHANGE OF PRICE, RENTAL OR OTHER CONDITIONS, WITHDRAWAL WITHOUT NOTICE, AND TO ANY SPECIAL LISTING CONDITIONS IMPOSED BY THE PROPERTY OWNER(S). ANY PROJECTIONS, OPINIONS OR ESTIMATES ARE SUBJECT TO UNCERTAINTY AND DO NOT SIGNIFY CURRENT OR FUTURE PROPERTY PERFORMANCE.