



**2402 CLARK ST.**  
18,600 - 39,000 SF FOR LEASE

**PROPERTY FEATURES**

2402 Clark Street is a multi-tenant, grade level, warehouse building in the heavy industrial pocket of Apopka. The property is located near the intersection of N Orange Blossom Trail and Maitland Blvd (SR 414) which provides convenient access to I-4, and the newly completed 429 Beltway. Recent renovations include fully reconditioned office with new flooring, paint, and large breakroom.

**1-2 ACRES OF OUTDOOR STORAGE AVAILABLE NEARBY**



PROPERTY SPECIFICATIONS	UNIT 1	UNIT 3
AVAILABLE SPACE	18,600 +/- SF	20,400 +/- SF
OFFICE	4,150 +/- SF	1,356 +/- SF
MEZZANINE	4,000 +/- SF	
OVERHEAD DOORS	2 - 10' x 10' 1 - 14' x 12'	3 - 14' x 12' 1 - 14' x 14' 1 - 8' x 10'
AVAILABLE	Now	November
MONTHLY RATE	\$19,462	\$21,345
FIRE SPRINKLERS		Installed
CLEAR HEIGHT		17'8" - 20'5"
ZONING		IND-4 Heavy Industrial
PARKING		Fully fenced and secured

\*Sales tax included

**FOR MORE INFORMATION, PLEASE CONTACT:**

JEROD FREELAND | 321.591.5404  
Jerod.Freeland@foundrycommercial.com  
Licensed Real Estate Broker

CHARLES ATTAWAY | 407.963.4064  
Charles.Attaway@foundrycommercial.com  
Licensed Real Estate Broker

# 2402 CLARK ST.

## FLOOR PLAN

### UNIT 1

### UNIT 3

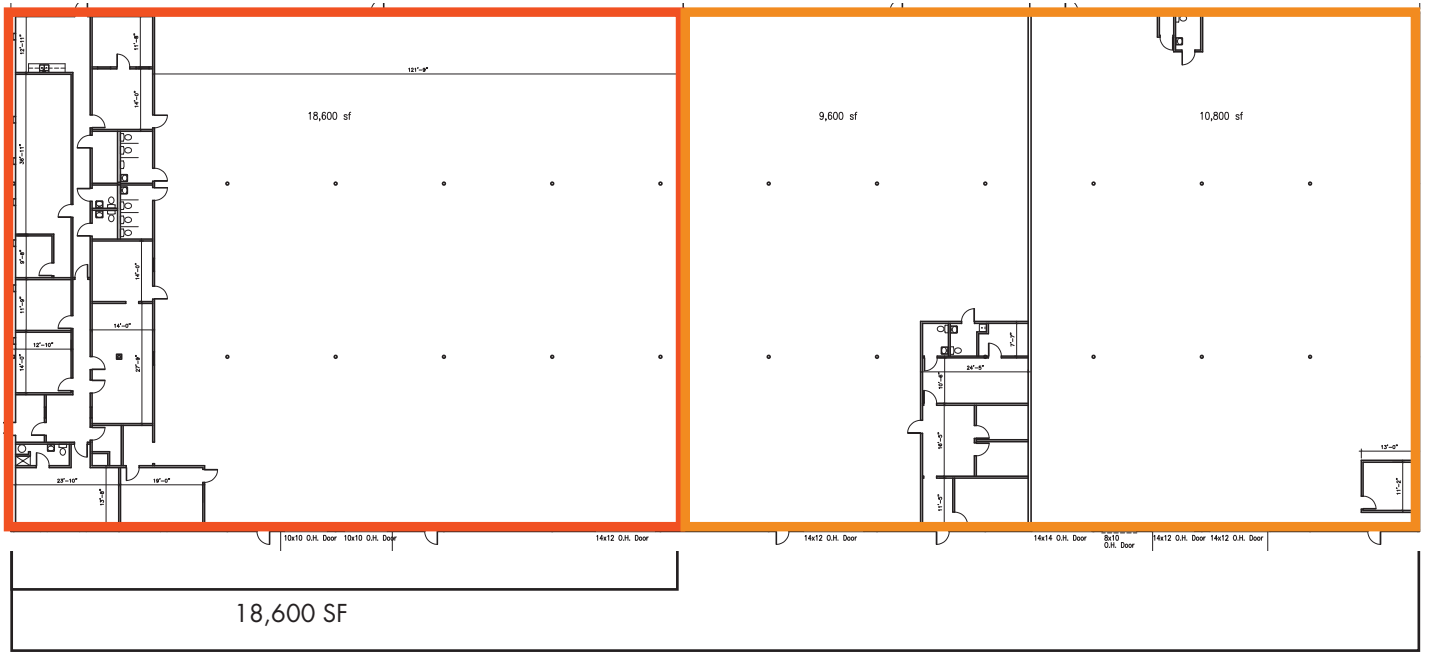

39,000 SF

## LOCATION

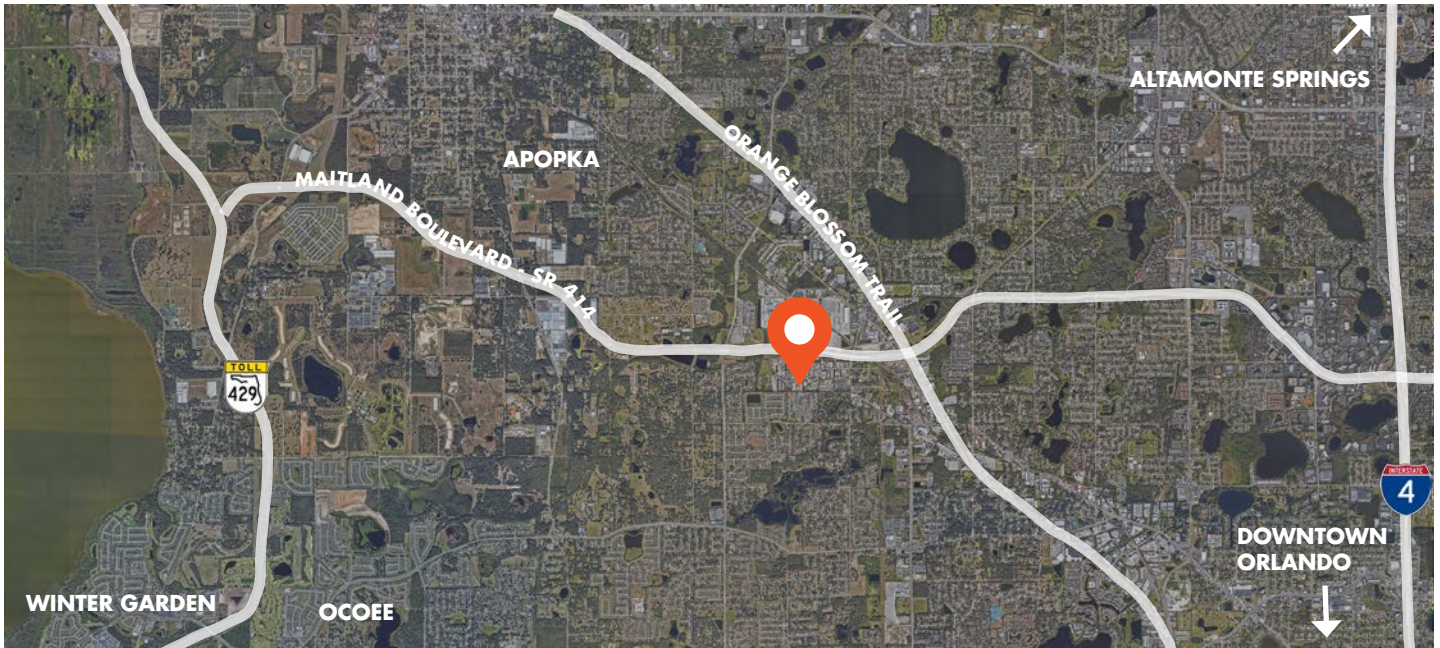

### FOR MORE INFORMATION, PLEASE CONTACT:

**JEROD FREELAND | 321.591.5404**  
 Jerod.Freeland@foundrycommercial.com  
 Licensed Real Estate Broker

**CHARLES ATTAWAY | 407.963.4064**  
 Charles.Attaway@foundrycommercial.com  
 Licensed Real Estate Broker



APOPKA, FL

±18,600 - 39,000 RSF AVAILABLE FOR LEASE

# 2402 CLARK ST.

## NEWLY RENOVATED OFFICE SPACE - UNIT 1



### FOR MORE INFORMATION, PLEASE CONTACT:

JEROD FREELAND | 321.591.5404  
Jerod.Freeland@foundrycommercial.com  
Licensed Real Estate Broker

CHARLES ATTAWAY | 407.963.4064  
Charles.Attaway@foundrycommercial.com  
Licensed Real Estate Broker

**FOUNDRY**  
COMMERCIAL

Although the information contained herein was provided by sources believed to be reliable, Foundry Commercial makes no representation, expressed or implied, as to its accuracy and said information is subject to errors, omissions or changes.

[foundrycommercial.com](https://foundrycommercial.com)