

# East Ponce Industrial Arts Building

3172 E Ponce DE Leon Ave | Scottdale, GA 30079

*"In the heart of the Rail Arts District"*



**NOW LEASING-MIX OF OFFICE, RETAIL, & INDUSTRIAL SUITES**

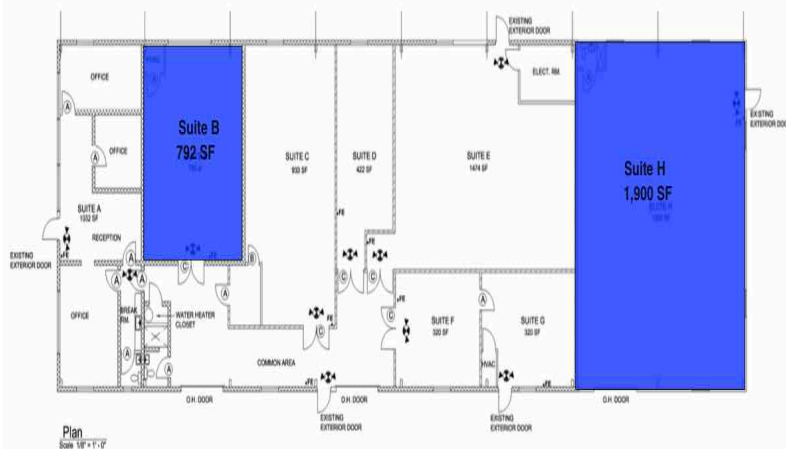

For more information, please contact:

Justin Dinerman CCIM, CPM  
404.631.6344  
justin@dinermangroup.com



1000 Circle 75 Parkway ,Suite 630, Atlanta, GA 30339

[www.dinermangroup.com](http://www.dinermangroup.com)

## Building Information

-8,000 SF building featuring a diverse mix of tenants and suites.

## Building Features

- Brick and steel construction
- Highly visible location at the intersection of East Ponce De Leon Ave and Paloma Dr.
- Ample parking
- Located along MARTA bus route
- Monument signage available
- Close to I-285, Decatur, Avondale Estates, and downtown Atlanta

## Suite Availabilities

- Suite H:** 1,900 SF warehouse with outside storage
- Suite E:** 792 SF former Martial Arts/ Dance Studio (available March 1, 2016)

# East Ponce Industrial Arts Building

3172 E Ponce DE Leon Ave | Scottdale, GA 30079

*"In the heart of the Rail Arts District"*

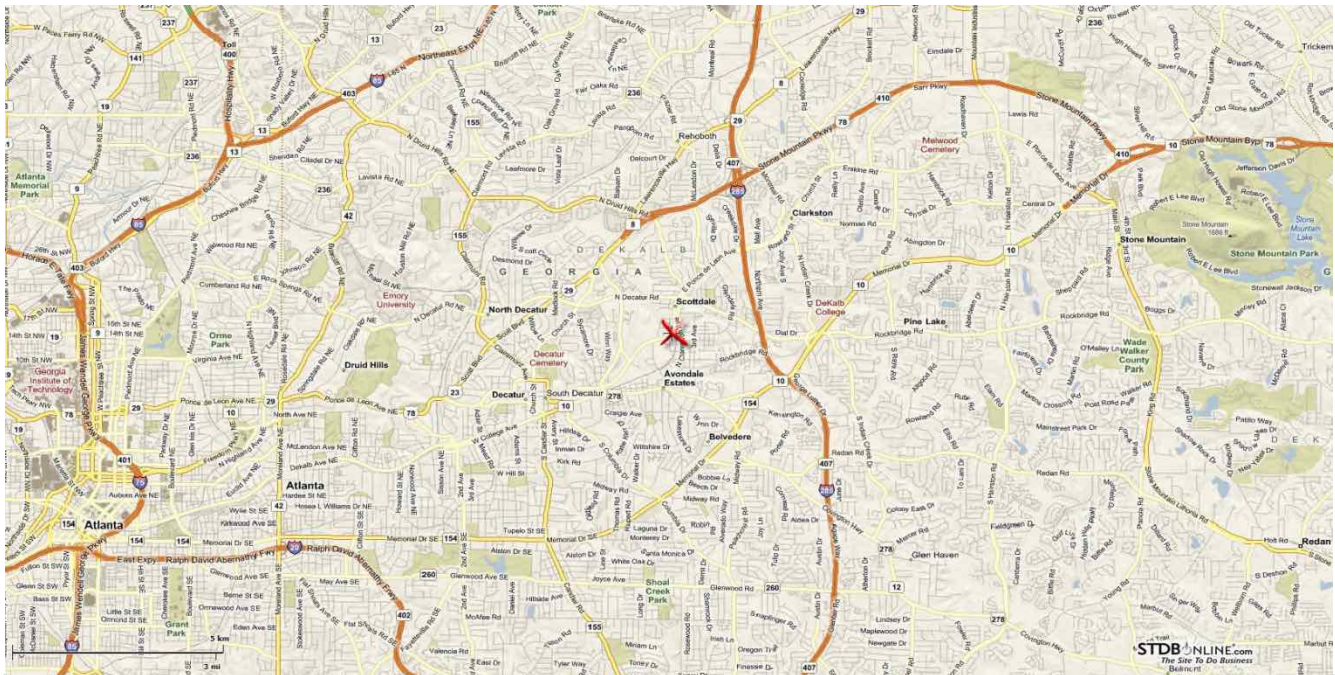

Close to I-285, Decatur, Avondale Estates, and downtown Atlanta



## Statistics & Demographics

- Population 271,733 (5 mile)
- Households 109,945 (5 mile)
- HH Inc. Avg. \$67,502 (5 mile)
- Avg. daily traffic count 15,000

## Building Tenancy Highlights

- Tapmania Tap Dance Instruction
- Mei Zhong Yang Style Taijiquan Association
- LifeLine Animal Project
- Radio Roasters



Justin Dinerman CCIM, CPM  
404.631.6344  
justin@dinermangroup.com