

UTILITY EASEMENT
ORB 853,
PAGE 2667

C.M.P.
INV.=10.35

C.M.P.
INV.=9.83

FIRC 1/2
LB 205

FIRC 1/2
LB 205

18" C.M.P.
INV.=8.4

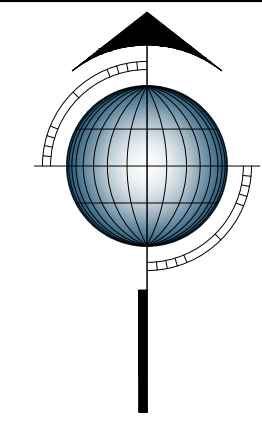

GIE
GRAHAM ENGINEERING SERVICES
DESIGN - PLAN - CONSULTING
251 CARL VINSON PARKWAY
WARNER ROBINS, GA. 31088
478-449-5820
grahamengineering.com

47th STREET
50' RIGHT OF WAY
25'± ASPHALT PAVING
(PLAT BOOK 24, PAGE 86)

U.S. HIGHWAY NO.1 (S.R.NO.5)
EDGE OF PAVEMENT
CONCRETE SIDEWALK
FLORIDA DEPARTMENT OF TRANSPORTATION
REVISED 3-21-2014

EDGE OF PAVEMENT
66'± ASPHALT PAVING
32'± ASPHALT PAVING
OLD DIXIE HIGHWAY
(PLAT BOOK 24, PAGE 86)

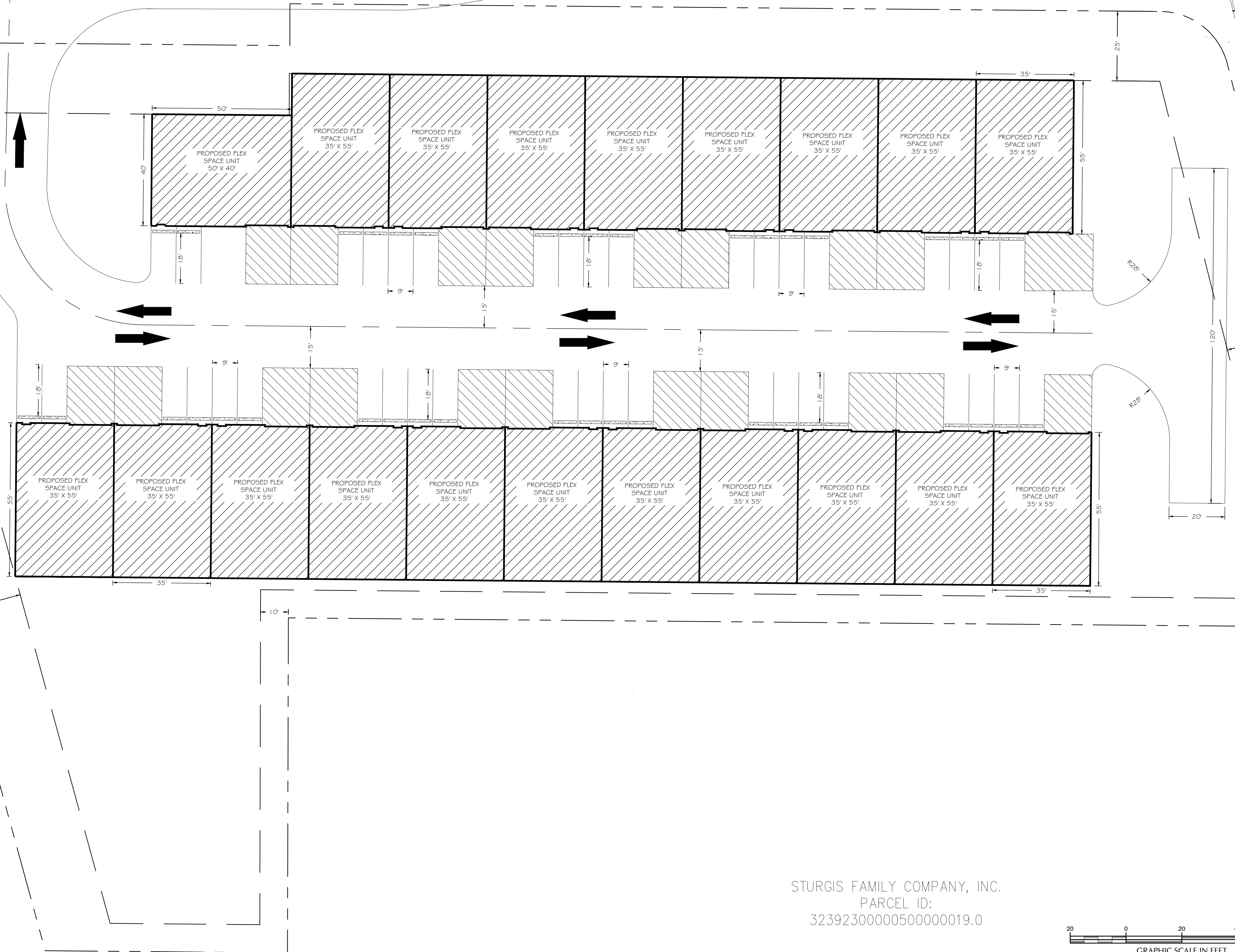

STURGIS FAMILY COMPANY, INC.
PARCEL ID:
32392300000500000019.0

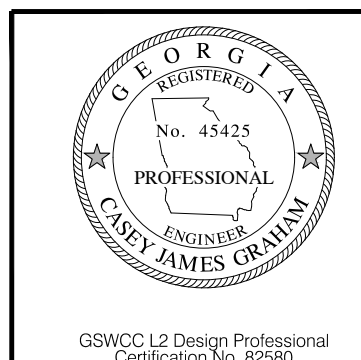
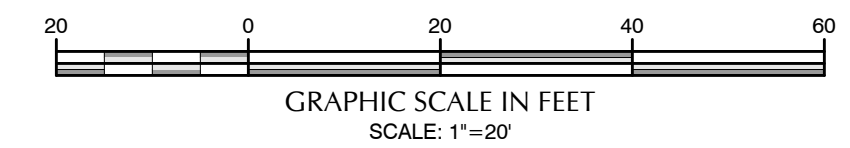

THIS DOCUMENT, AS AN INSTRUMENT OF SERVICE, IS THE PROPERTY OF GRAHAM ENGINEERING SERVICES, LLC. AND NO PART THEREOF MAY BE USED OR REPRODUCED IN WHOLE OR IN PART WITHOUT WRITTEN PERMISSION. COPYRIGHT AS DATED GRAHAM ENGINEERING SERVICES, LLC.

CONCEPTUAL PLAN FOR:
**FLEX SPACE AT
OLD DIXIE HWY & 47TH ST
INDIAN RIVER COUNTY, FL**

PN: FLEX SPACE
DN: CONCEPT
DRAWN BY: CJG
FIELD DATA BY:
FIELD DATE:
REVIEW BY:
DATE: 02.26.24
SCALE: 1"=20'

REVISIONS	DATE	COMMENT

SHEET
C001
CONCEPTUAL LAYOUT