

FOR LEASE: 5,192 SF WAREHOUSE BUILDING
\$9.25/SF

3 ROLL-UP DOORS | 400 SF FRONT OFFICE | M-1 ZONING



1729 COGSWELL ST
ROCKLEDGE, FL 32955



... OFFERING MEMORANDUM ...



SCAN FOR LISTING WEBSITE

OFFERED FOR LEASE AT:
\$4,000/month (\$9.25/sf)

Year Built:	1974
Zoning:	M1-Gen Industrial
Current Use:	Warehousing, Distribution & Trucking
Size:	5,192 sf
Office area:	400 sf
3-Phase Power:	No (available nearby)
Outside Storage Permitted:	No
Bay Doors:	(3) 10' x 10"
Ceilings:	10-12' Clear Height
Type:	Modified Gross Lease
Term:	Negotiable



Ideally located just off Barton Blvd





Open Warehouse Ready for a New Tenant!

Great opportunity to locate your business in a central industrial hub of Brevard County at a great rate at only \$9.25/sf.

This 5,192 sf warehouse is located just off Barton Blvd and only half-mile to US-1.

M-1 Zoning allows for a multitude of uses including manufacturing, automotive, storage and retail.

Features include 3 roll-up doors (10'x10'), 400 sf of separate office area, 10'-12' clear height ceilings.

3-Phase Power is nearby and available at Tenant expense.

Tenant responsibilities include all utilities, base rent and sales tax. Water usage over \$150/month will be pro-rated Tenant expense.



1729 COGSWELL ST, ROCKLEDGE, FL
5,192 SF | \$4,000/MOS LEASE | M-1 ZONING

BARTON BLVD

COGSWELL RD



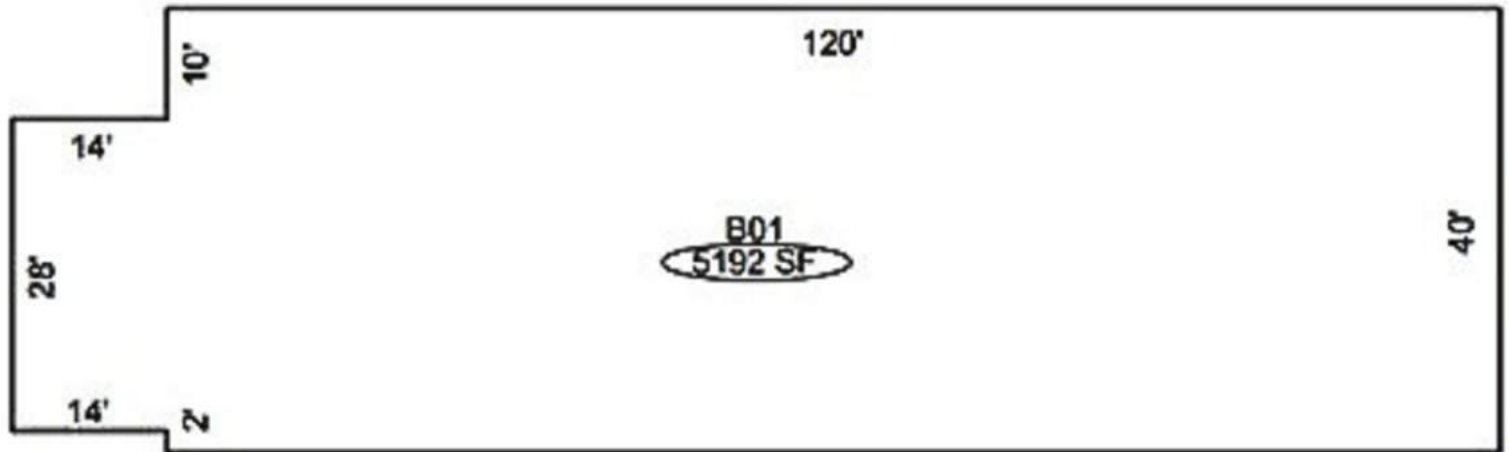







ZONING: M-1 (GENERAL INDUSTRIAL)

Link to City of Rockledge M-1 Code:

[https://library.municode.com/fl/rockledge/codes/land_development_regulations?
nodeId=LADERE_PTVIPLDIZO_S62.140MNEINDI_62.141IN](https://library.municode.com/fl/rockledge/codes/land_development_regulations?nodeId=LADERE_PTVIPLDIZO_S62.140MNEINDI_62.141IN)



Marketing information and the contents, except such information that is a matter of public record or is provided in sources available to the public, are of confidential nature. This OM has been prepared to provide summary information to prospective Buyers and to establish a preliminary level of interest. These materials do not constitute an offer, but only a solicitation of interest with respect to a possible sale of the property, which the Owner may consider. Information contained herein has been obtained through sources deemed reliable but not guaranteed. The information contained herein is not a substitute for a thorough due diligence investigation. Curri Commercial reserves the right to withdraw this solicitation at any time without prior notice. Statements contained herein which involve matters of opinion, whether or not identified to be that are not representations of fact. The price and terms of this offering may be subject to change at any time. Curri Commercial is not affiliated with, sponsored by, or endorsed by any commercial tenant or lessee identified in this marketing package. The presence of any corporation's logo or name is not intended to indicate or imply affiliation with, or sponsorship or endorsement by, said corporation.



SCAN FOR LISTING WEBSITE

EXCLUSIVELY LISTED BY:

KAREN D'ALBERTO **JOHN CURRI**
Realtor® Realtor®

VP/Principal
321.622.3196
f1st.karen@gmail.com

Owner/CEO
321-961-4487
john@curriproperties.com

