

# For Lease

# Lincoln Park at SouthPark

8511 - 8523 Commodity Circle | Orlando, FL 32819



**61,686± sf available**  
**Will subdivide**

8511 - Suite 300

61,686± RSF

Available 07/01/25

**AVISON  
YOUNG**

**Greg Morrison, CCIM, SIOR**

Principal

407.440.6640

[greg.morrison@avisonyoung.com](mailto:greg.morrison@avisonyoung.com)

**Patrick Morrison**

Vice President

407.440.6649

[patrick.morrison@avisonyoung.com](mailto:patrick.morrison@avisonyoung.com)



## Introduction

Lincoln Park at SouthPark is a first-class office campus located off of John Young Parkway in Orlando, Florida. The campus features two single-story office buildings and offers immediate access to major thoroughfares and excellent exposure.

### PROPERTY HIGHLIGHTS

**EASY ACCESS TO INTERSTATE-4,  
S.R. 528 AND THE FLORIDA TURNPIKE**

**EV CHARGING STATIONS ON-SITE**

**LOCATED MINUTES FROM ORLANDO  
INTERNATIONAL AIRPORT**

**BUILDING SIGNAGE AND  
MONUMENT SIGNAGE AVAILABLE**

**OPEN PLAN WITH  
PERIMETER OFFICES**

**OUTSIDE SEATING AREAS**

**12 FOOT CLEAR HEIGHT WITH FLOOR  
TO CEILING GLASS IN-PLACE**

**6/1,000 SF PARKING RATIO**

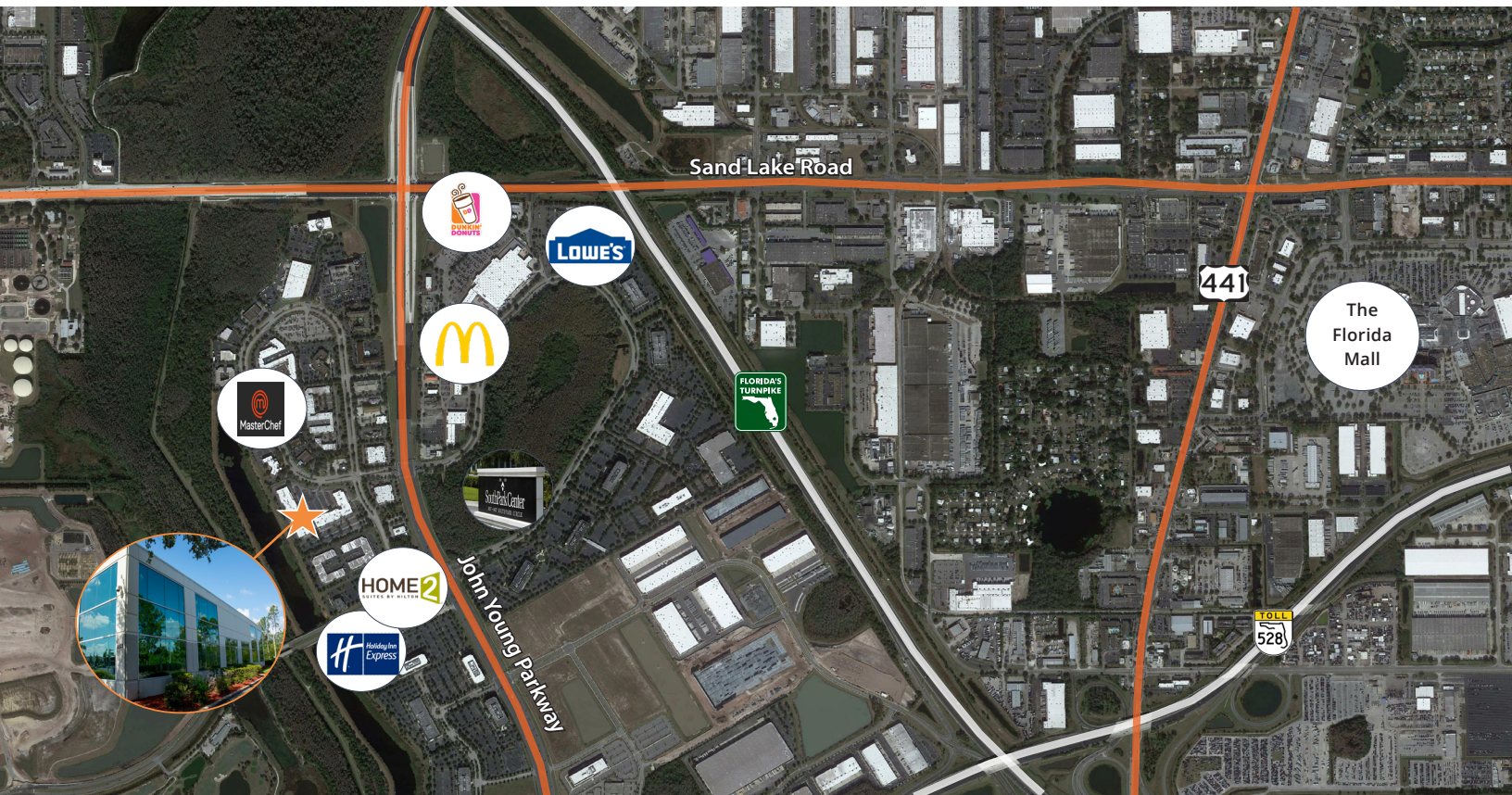

# Photos



**AVISON  
YOUNG**

**Greg Morrison, CCIM, SIOR**  
Principal  
407.440.6640  
greg.morrison@avisonyoung.com

**Patrick Morrison**  
Vice President  
407.440.6649  
patrick.morrison@avisonyoung.com

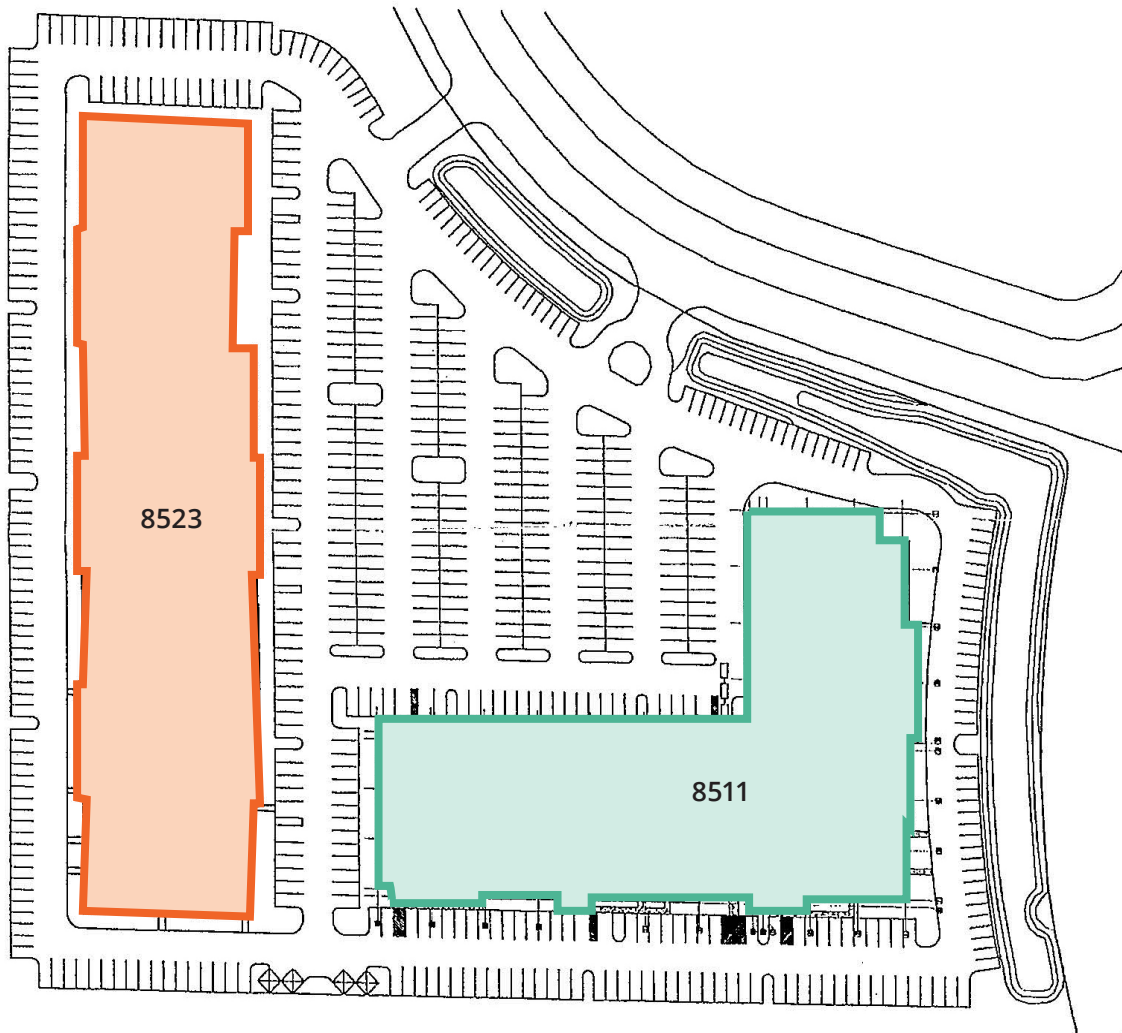

- Six (6) EV Charging Stations

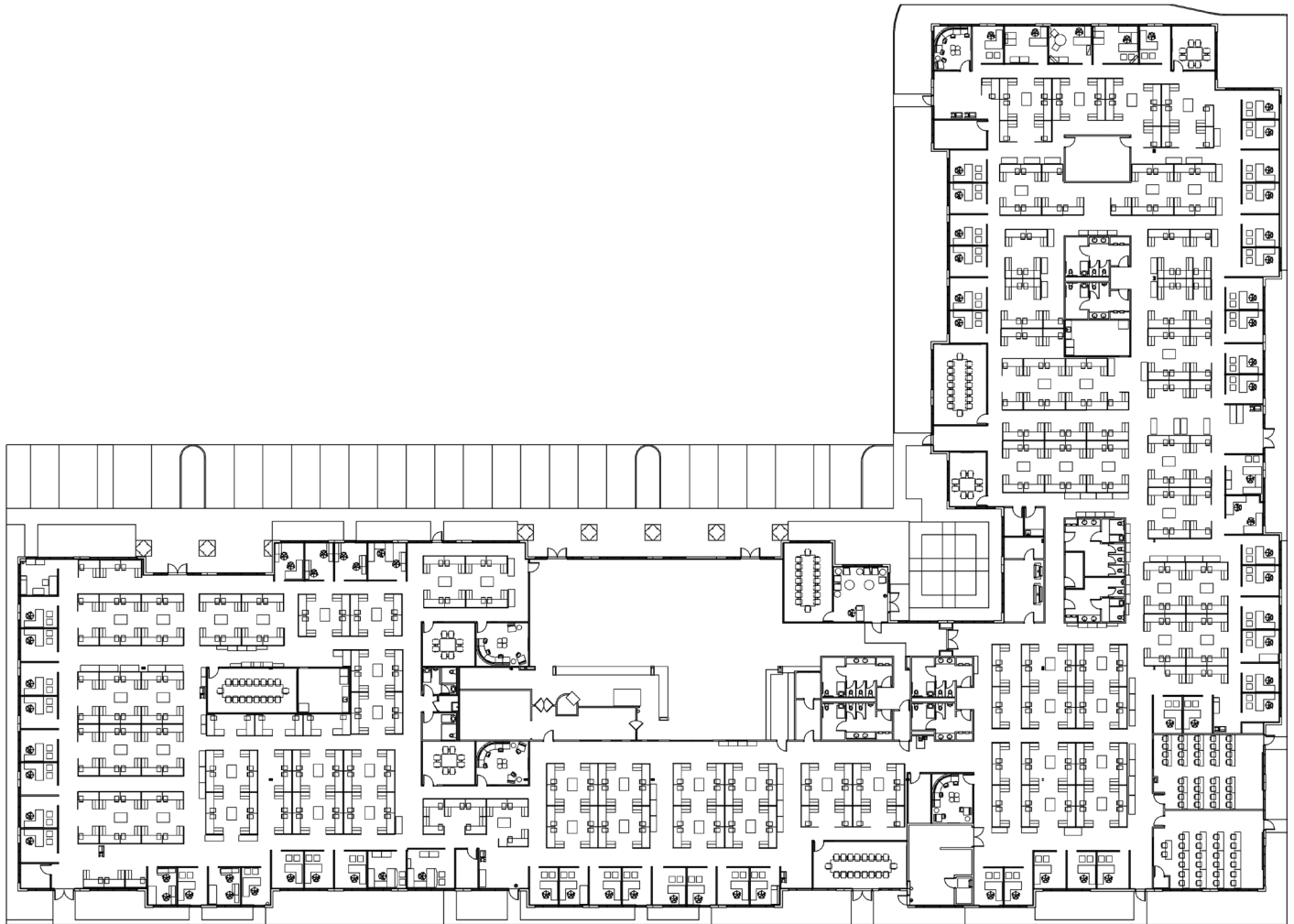

Available 07/01/25