

# 35 Berkshire Dr Unit 2

Crystal Lake, IL 60014

# For Lease

MLS #12127122

RETAIL



RETAIL

1,200 SF

\$1,950/MO (GROSS) \$19.50 PSF

### Retail Space

1,200 SF retail space available in popular Coventry Plaza. Come join Birds & Beasts Pet Store, Dairy Queen, Boost Mobile, Piano Trends and Blue Smoke Barbecue Supply store.

Good visibility and demographics. New parking lot and new pole signage available at tenant expense.

**Unit 2:** 1,200 SF former cleaners and owner will “vanilla box” the space for new tenant. \$1,950/mo. Gross.

Demographics	1 Mile	3 Miles	5 Miles
Total Population	6,462	62,206	135,035
Average HH Income	\$87,511	\$122,016	\$141,065

### Specifications

Description:	Retail - Strip Center
Size:	24,000 SF
Year Built:	1985
HVAC System:	GFA/ Central Air
Electrical:	200 amp
Sprinklers:	No
Washrooms:	1
Ceiling Height:	12 ft
Parking:	Common / Lighted
Sewer/Water:	City
Zoning:	B1 PUD
CAM & Taxes	Included in Rent
PIN #:	19-08-426-010

[CLICK HERE TO VIEW OUR WEBSITE](#)

No warranty or representation is made as to the accuracy of the foregoing information. Terms of sale or lease and availability are subject to change or withdrawal without notice. This document is for information purposes only. No offer of sub-agency is being made.



www.PremierCommercialRealty.com | 847.854.2300 | 9225 S. Route 31, Lake in the Hills, IL 60156

Senior Broker  
**Bruce Kaplan**

BruceK@PremierCommercialRealty.com  
O: 847.854.2300 xx20 C: 847.507.1759

35 Berkshire Dr Unit 2  
Crystal Lake, IL 60014

For Lease

RETAIL

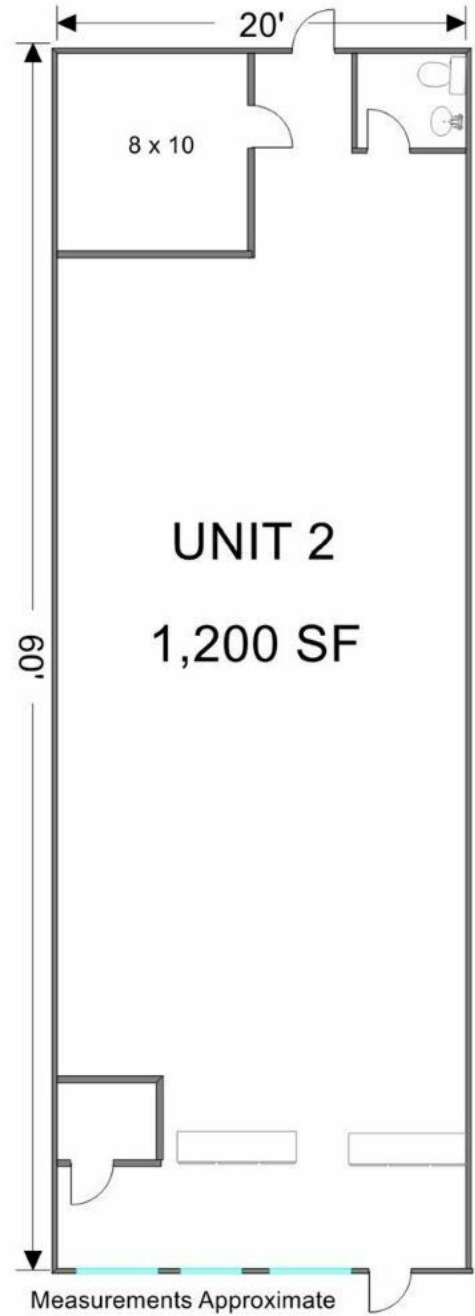

[CLICK HERE TO VIEW OUR WEBSITE](#)

No warranty or representation is made as to the accuracy of the foregoing information. Terms of sale or lease and availability are subject to change or withdrawal without notice. This document is for information purposes only. No offer of sub-agency is being made.



[www.PremierCommercialRealty.com](http://www.PremierCommercialRealty.com) | 847.854.2300 | 9225 S. Route 31, Lake in the Hills, IL 60156

Senior Broker  
**Bruce Kaplan**  
BruceK@PremierCommercialRealty.com  
O: 847.854.2300 xx20 C: 847.507.1759