

Hillsborough Ave Commercial Building for Sale or Lease

4401 E. Hillsborough Ave., Tampa, FL 33610

EXECUTIVE SUMMARY



Summary:

Sale price:	\$1,095,000.
Lease rate:	\$15 PSF, NNN plus CAM
Availability:	Immediate
Space Size:	5,000 SF
Lot size:	0.47 acre
Parking:	Fenced yard.
Ceiling Heights:	12' +/-
Location:	City of Tampa
Roll Up Doors:	5 GRADE LEVEL
Construction:	Concrete Block
Taxes (2023):	\$6,108.97
Power:	Three Phase
Utilities:	Water - City of Tampa Septic System Electric: Tampa Electric
Zoning:	CI/Commercial Intensive
Traffic Counts:	Over 44,000 AADT

Overview:

GREAT VISIBILITY along Hillsborough Avenue and centrally located near the Seminole Hard Rock Hotel and Casino!! This free-standing building is close to Interstate 4, US 301 and Interstates 275/75 providing good access to Pinellas County and the rest of Tampa Bay. This property has great visibility with over 44,000 average traffic counts/day along Hillsborough Avenue. The property features Commercial intensive (CI) zoning with a Future Land Use of Community Commercial-35/2.0 FAR. This zoning/land use provides for numerous uses and possibilities. This free standing building has 12' clear heights and features a fenced yard providing for ample parking or storage. This property is perfect for a retail user, warehouse user or anyone looking for a high visibility commercial property.

FLU-Community Commercial-35/2.0 FAR

Potential City of Tampa Grants available

Located in an Opportunity Zone

Bill Besselieu, CCIM
Mobile/Direct: 813-263-5854
besselieu@gmail.com

Greg Andretta, SIOR
813-263-4833
greg@andrettaproperties.com

Andretta Properties
Licensed Real Estate Broker
550 N. Reo St. #300 Tampa, FL 33609
Office: 813-889-0889
www.andrettaproperties.com

Hillsborough Ave. Commercial Building for Sale or Lease

4401 E. Hillsborough Ave., Tampa, FL 33610

PICTURES



Bill Besselieu, CCIM
Mobile/Direct: 813-263-5854
besselieu@gmail.com

Greg Andretta, SIOR
813-263-4833
greg@andrettaproperties.com

Andretta Properties
Licensed Real Estate Broker
550 N. Reo St. #300 Tampa, FL 33609
Office: 813-889-0889
www.andrettaproperties.com

Hillsborough Ave. Commercial Building for Sale or Lease

4401 E. Hillsborough Ave., Tampa, FL 33610

FLOOR PLAN

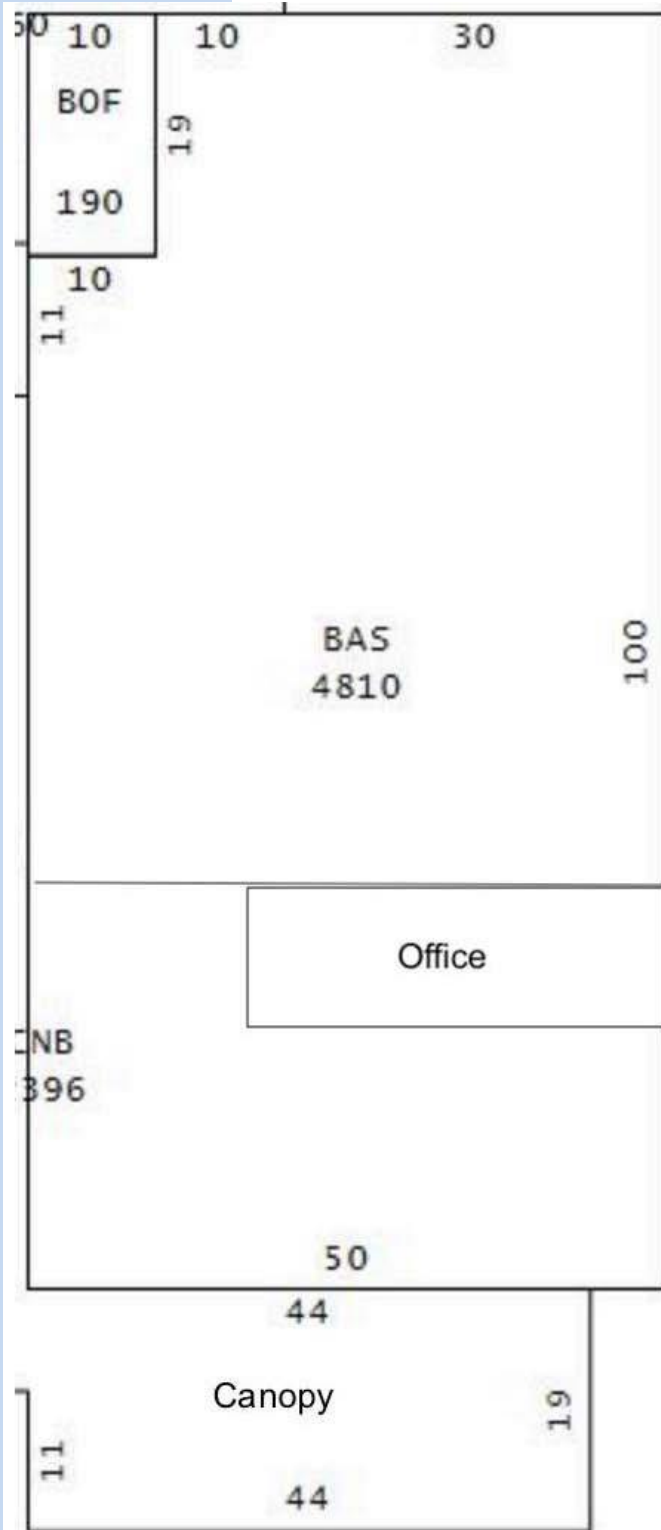

FLOOR PLAN -
SUBJECT TO
VERIFICATION

Bill Besselieu, CCIM
Mobile/Direct: 813-263-5854
besselieu@gmail.com

Greg Andretta, SIOR
813-263-4833
greg@andrettaproperties.com

Andretta Properties
Licensed Real Estate Broker
550 N. Reo St. #300 Tampa, FL 33609
Office: 813-889-0889
www.andrettaproperties.com

