

ZONING-M1

PROJECT: 07D02
 DATE: 03/01/07
 SCALE: 1"=30'
 DRAWN BY: PEL

REVISIONS:

I HEREBY CERTIFY THAT THESE PLANS WERE DESIGNED UNDER MY DIRECT SUPERVISION.

Mitchell J. Van Beek

12/19/07

MITCHELL T. VAN BEEK
 PROFESSIONAL ENGINEER
 FLORIDA PE NUMBER 60983

PLACE OF BUSINESS
 WAGNER CONSTRUCTION COMPANY, LLC
 1903 GREENLEAF LANE
 LEESBURG, FLORIDA 34748
 TELEPHONE (352) 728-2221
 FACSIMILE (352) 728-6670
 WWW.WAGNERFLORIDA.COM

WAGNER

CONSTRUCTION COMPANY, LLC
 1903 GREENLEAF LANE
 LEESBURG, FLORIDA 34748
 TELEPHONE (352) 728-2221
 WWW.WAGNERFLORIDA.COM

PROPOSED BUILDING AND IMPROVEMENTS FOR:

LEESBURG COMMONS
 LOT 1 GREENLEAF LANE
 LEESBURG, FLORIDA
 OVERALL SITE LAYOUT BLDG 1A/1B

© WAGNER CONSTRUCTION COMPANY, LLC - DESIGNER.
 ENGINEER, ARCHITECT OR CONTRACTOR HEREBY EXPRESSLY
 RELEASES THIS COMPANY FROM LIABILITY AND OTHER
 OBLIGATIONS FOR ANY AND ALL ERRORS, OMISSIONS,
 MISTAKES OR NEGLIGENCE IN THESE PLANS. THE ENGINEER
 OR ARCHITECT SHALL BE RESPONSIBLE FOR OBTAINING
 ANY FORMS OR PERMITS NECESSARY WITHOUT FIRST
 OBTAINING THE EXPRESS WRITTEN PERMISSION OF WAGNER
 CONSTRUCTION COMPANY, LLC. NO PART OF THESE PLANS
 SHALL BE REPRODUCED OR TRANSMITTED IN ANY FORM OR
 BY ANY MEANS, ELECTRONIC OR MECHANICAL, WITHOUT THE
 EXPRESS WRITTEN PERMISSION OF WAGNER CONSTRUCTION
 COMPANY, LLC.

C2.1

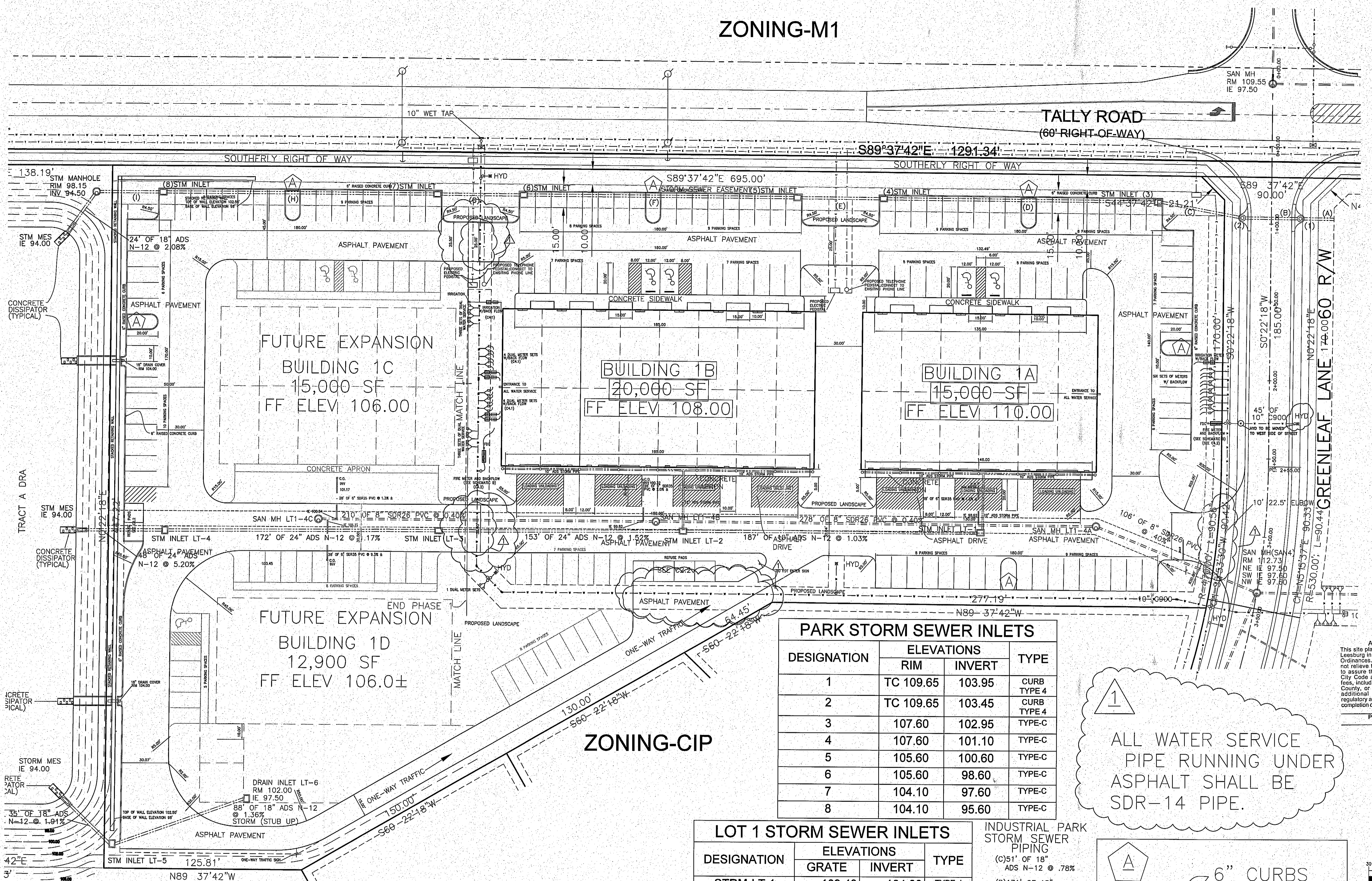

PARK STORM SEWER INLETS

DESIGNATION	ELEVATIONS		TYPE
	RIM	INVERT	
1	TC 109.65	103.95	CURB TYPE 4
2	TC 109.65	103.45	CURB TYPE 4
3	107.60	102.95	TYPE-C
4	107.60	101.10	TYPE-C
5	105.60	100.60	TYPE-C
6	105.60	98.60	TYPE-C
7	104.10	97.60	TYPE-C
8	104.10	95.60	TYPE-C

LOT 1 STORM SEWER INLETS

DESIGNATION	ELEVATIONS		TYPE
	GRATE	INVERT	
STRM-LT-1	109.40	104.00	TYPE-J
STRM-LT-2	107.30	101.50	TYPE-J
STRM-LT-3	105.60	99.00	TYPE-J
STRM-LT-4	105.00	95.70	TYPE-D
STRM-LT-5	104.50	96.30	TYPE-D
STRM-LT-6	102.00	97.50	TYPE-C

SAN-SEWER MAN HOLES

DESIGNATION	ELEVATIONS			TYPE
	RIM	INVERT	INVERT	
SAN-MH-LT4-A	109.70	SE 98.92	NW 99.02	PRE-CAST
SAN-MH-LT4-B	107.50	NE 100.15	NW 100.25	PRE-CAST
SAN-MH-LT4-C	105.50	NE 101.09		PRE-CAST

1
 ALL WATER SERVICE PIPE RUNNING UNDER ASPHALT SHALL BE SDR-14 PIPE.

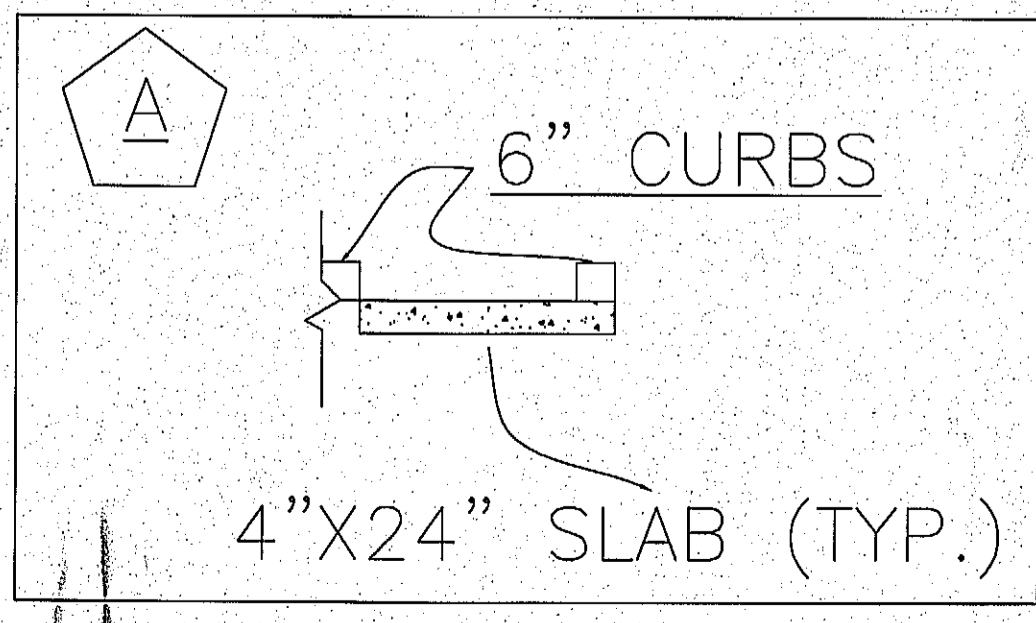

APPROVED SITE PLAN
 This site plan has been approved by the City of Leesburg in accordance with the City's Code of Ordinances. The approval of the site plan does not relieve the applicant from the responsibility to assure that the current requirements of the City Code are met; from paying all applicable fees, including impact fees due to the City, the County, or any other governmental body; and additional permits from other governmental regulatory agencies when necessary for the completion of this project.
 See also
 Planning and Storm Management
 3815

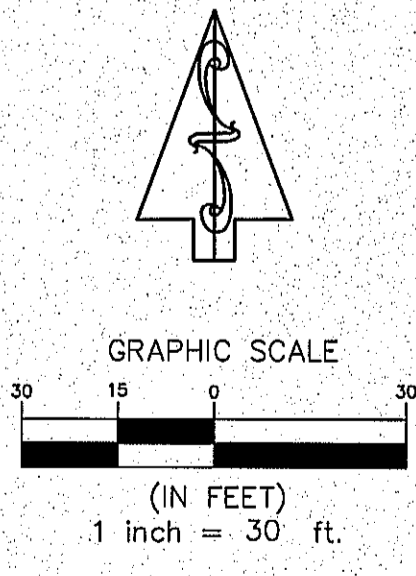

THIS PROJECT WILL BE DEVELOPED UNDER ENVIRONMENTAL RESOURCE PERMIT (PERMIT NO. 40-069-109290-1) AS GRANTED BY THE ST. JOHNS RIVER WATER MANAGEMENT DISTRICT