



Altamonte Capital Center



MEDICAL / OFFICE SPACE FOR LEASE

249 & 251 Maitland Ave., Altamonte Springs, FL 32701

Contact: Dan Van Nada, CCIM
Vice President of Brokerage Services

E: Dan@FCPG.com
P: 407.872.0177 ext. 117

Contact: Ben Kuykendall
Sales & Leasing Associate

E: Ben@FCPG.com
P: 407.872.0177 ext. 131

For Lease: Inquire For Rate, Full Service

± 430 - 8,678 RSF Available

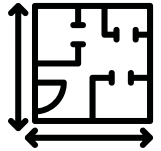

FLEXIBLE SUITE LAYOUTS AVAILABLE

Under new management & ownership: extensive building renovations recently completed

On-site parking with a ratio of 7 / 1,000



Prominent monument signage available

Strategically located just South of high-traffic Semoran Blvd / SR 436 (AADT 62,000) and 4 minutes from I-4 interchange

Varied suite layouts available for high degree of flexibility and customization

Within 1 mile of Florida Hospital, Uptown Altamonte / Cranes Roost, Altamonte Mall, Sunrail Station and Eastmonte Park

DEMOGRAPHICS

2024	 Total Population	 Total Households	 Average HH Income
1 Mile	9,239	4,528	\$155,676
3 Miles	99,588	45,108	\$115,733
5 Miles	271,966	118,408	\$114,077

615 E. Colonial Dr., Orlando, FL 32803 Phone: 407.872.0209 www.FCPG.com

Information furnished regarding the subject property is believed to be accurate, but no guarantee or representation is made. References to square footage are approximate. This offering is subject to errors, omissions, prior sale or lease or withdrawal without notice. ©2024 First Capital Property Group, Inc., Licensed Real Estate Brokers & Managers.

LOCATION

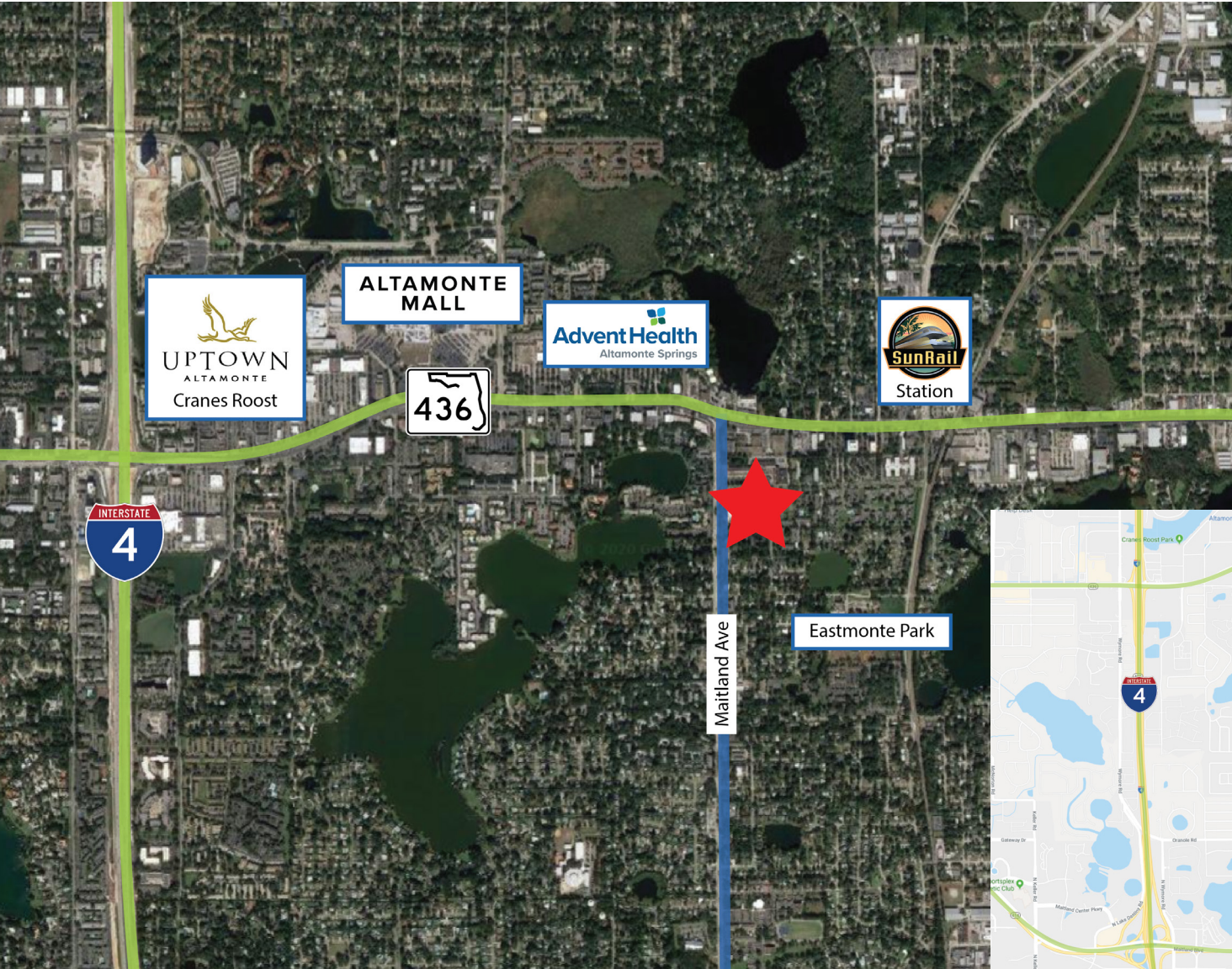

\$114,077
AVERAGE HH INCOME
WITHIN 5 MILE RADIUS



118,408
HOUSEHOLDS
WITHIN 5 MILE RADIUS

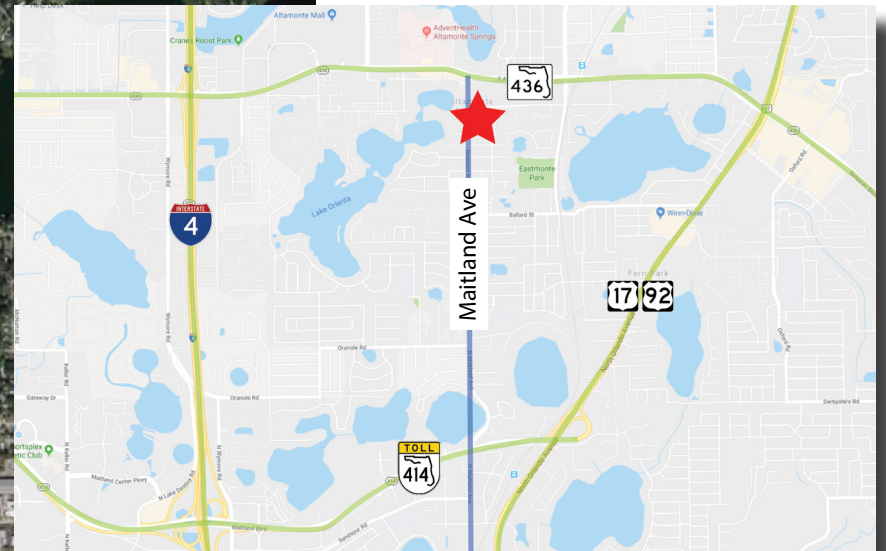

■ 615 E. Colonial Dr., Orlando, FL 32803 ■ Phone: 407.872.0209 ■ www.FCPG.com ■

Information furnished regarding the subject property is believed to be accurate, but no guarantee or representation is made. References to square footage are approximate. This offering is subject to errors, omissions, prior sale or lease or withdrawal without notice. ©2024 First Capital Property Group, Inc., Licensed Real Estate Brokers & Managers.

AVAILABLE IMMEDIATELY

Building 249

Suite 3100: 1,981 RSF

Suite 3200: 1,982 RSF

Suite 3100 / 3200: 3,963 RSF

Building 251

Suite 101: 1,755 RSF

Suite 103: 437 RSF

Suite 104: 888 RSF

Suite 105: 439 RSF

Suite 106: 870 RSF

Suite 107: 430 RSF

Suite 108: 462 RSF

Suite 109: 1,769 RSF

First Floor: 8,678 RSF

Suite 304: 1,039 RSF

Floorplans Available by Request.

■ 615 E. Colonial Dr., Orlando, FL 32803 ■ Phone: 407.872.0209 ■ www.FCPG.com ■

Information furnished regarding the subject property is believed to be accurate, but no guarantee or representation is made. References to square footage are approximate. This offering is subject to errors, omissions, prior sale or lease or withdrawal without notice. ©2024 First Capital Property Group, Inc., Licensed Real Estate Brokers & Managers.