

Hillsborough Ave Commercial Building for Lease

4401 E. Hillsborough Ave., Tampa, FL 33610

EXECUTIVE SUMMARY



Summary:

Lease rate:	\$15 PSF, NNN plus CAM
Availability:	Immediate
Space Size:	5,000 SF
Parking	Fenced yard.
Ceiling Heights:	12' +/-
Location:	City of Tampa
Roll Up Doors	5 GRADE LEVEL
Construction:	Concrete Block
Taxes (2023):	\$6,108.97
Power:	Three Phase
Utilities	Water - City of Tampa Septic System Electric: Tampa Electric
Zoning:	CI/Commercial Intensive
Traffic Counts:	Over 44,000 AADT

Overview:

GREAT VISIBILITY along Hillsborough Avenue and centrally located near the Seminole Hard Rock Hotel and Casino!! This free-standing building is close to Interstate 4, US 301 and Interstates 275/75 providing good access to Pinellas County and the rest of Tampa Bay. This property has great visibility with over 44,000 average traffic counts/day along Hillsborough Avenue. The property features Commercial intensive (CI) zoning with a Future Land Use of Community Commercial-35/2.0 FAR. This zoning/land use provides for numerous uses and possibilities. This free standing building has 12' clear heights and features a fenced yard providing for ample parking or storage. This property is perfect for a retail user, warehouse user or anyone looking for a high visibility commercial property.

FLU-Community Commercial-35/2.0 FAR

Bill Besselieu, CCIM
Mobile/Direct: 813-263-5854
besselieu@gmail.com

Greg Andretta, SIOR
813-263-4833
greg@andrettaproperties.com

Andretta Properties
Licensed Real Estate Broker
550 N. Reo St. #300 Tampa, FL 33609
Office: 813-889-0889
www.andrettaproperties.com

Hillsborough Ave. Commercial Building for Lease

4401 E. Hillsborough Ave., Tampa, FL 33610



PICTURES



Bill Besselieu, CCIM
Mobile/Direct: 813-263-5854
besselieu@gmail.com

Greg Andretta, SIOR
813-263-4833
greg@andrettaproperties.com

Andretta Properties
Licensed Real Estate Broker
550 N. Reo St. #300 Tampa, FL 33609
Office: 813-889-0889
www.andrettaproperties.com

Hillsborough Ave. Commercial Building for Lease

4401 E. Hillsborough Ave., Tampa, FL 33610

FLOOR PLAN

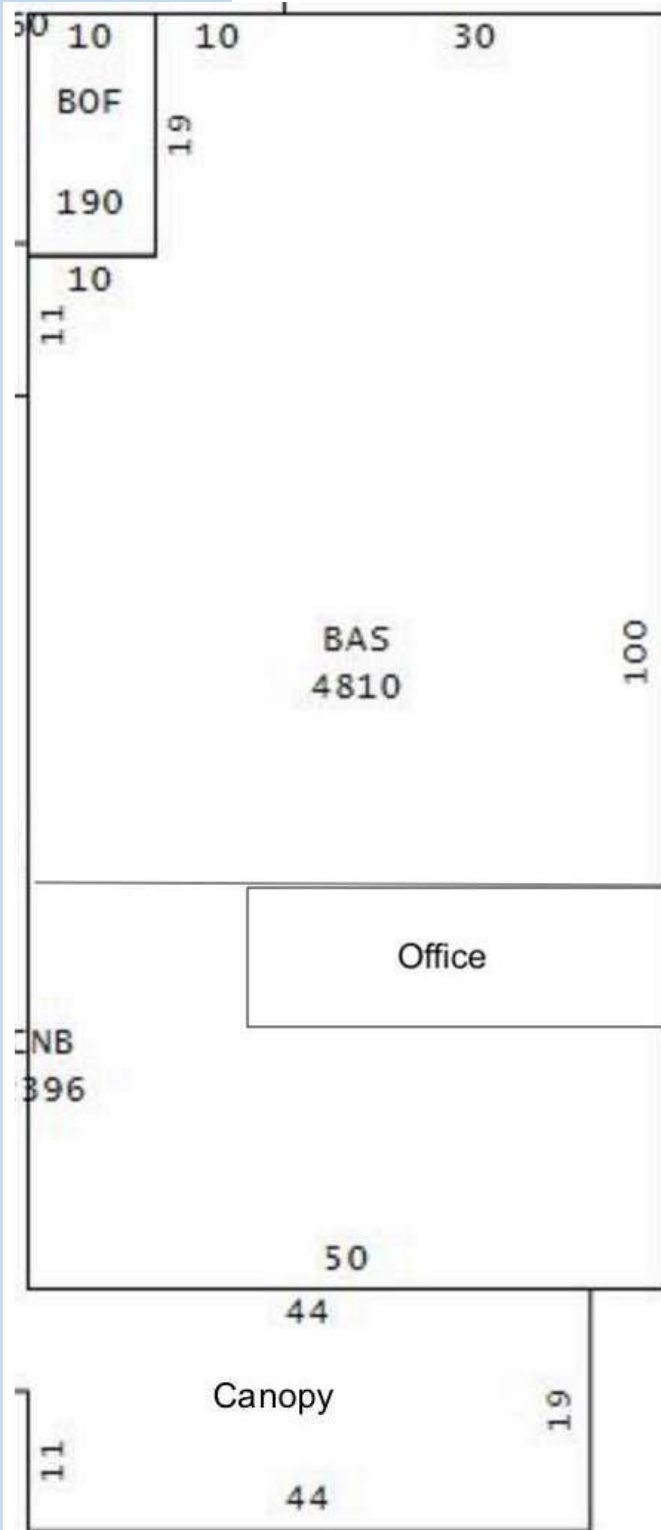

FLOOR PLAN -
SUBJECT TO
VERIFICATION

Bill Besselieu, CCIM
Mobile/Direct: 813-263-5854
besselieu@gmail.com

Greg Andretta, SIOR
813-263-4833
greg@andrettaproperties.com

Andretta Properties
Licensed Real Estate Broker
550 N. Reo St. #300 Tampa, FL 33609
Office: 813-889-0889
www.andrettaproperties.com

Hillsborough Ave. Commercial Building for Lease

4401 E. Hillsborough Ave., Tampa, FL 33610

AERIAL & AREA MAP

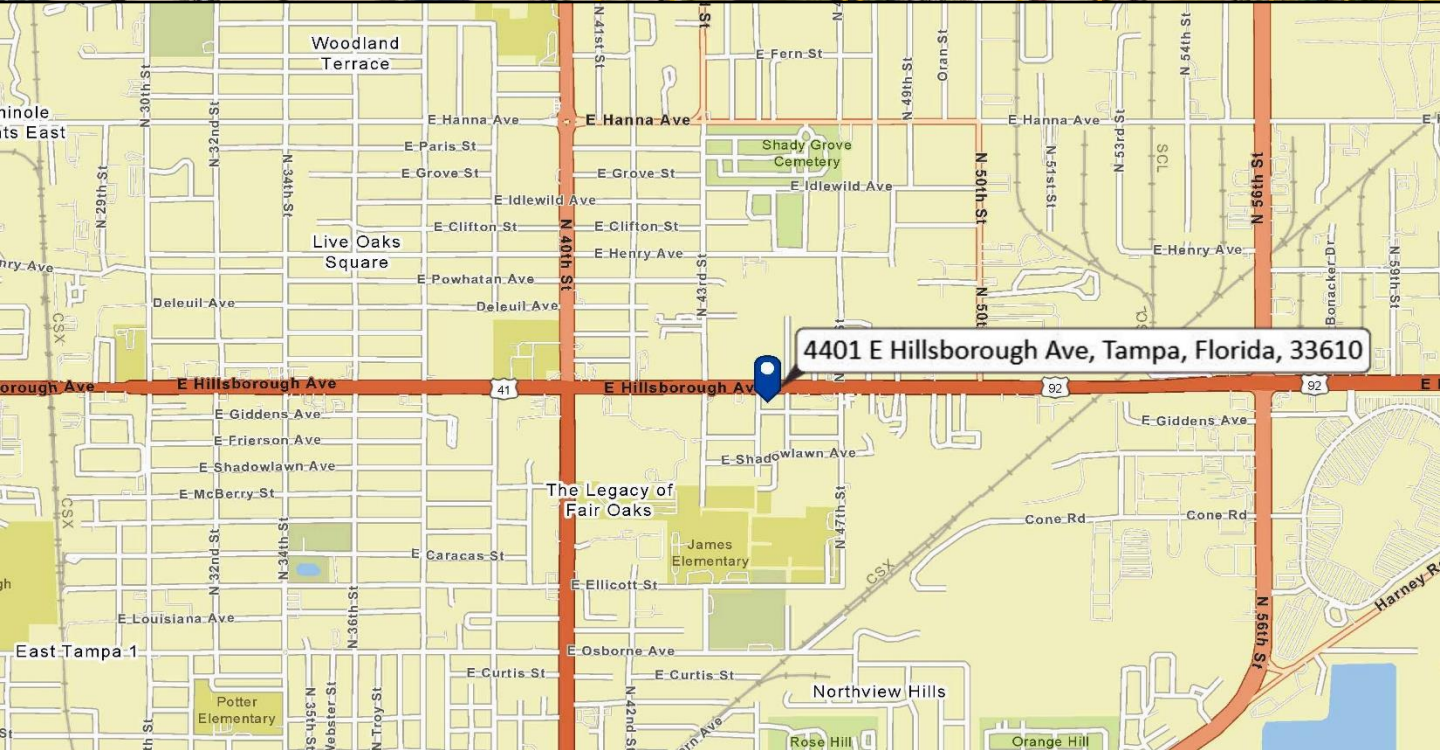

Bill Besselieu, CCIM
Mobile/Direct: 813-263-5854
besselieu@gmail.com

Greg Andretta, SIOR
813-263-4833
greg@andrettaproperties.com

Andretta Properties
Licensed Real Estate Broker
550 N. Reo St. #300 Tampa, FL 33609
Office: 813-889-0889
www.andrettaproperties.com

All information furnished regarding property for sale, rental, financing or projections of income & expenses is from sources deemed reliable. No warranty or representation is made as to the accuracy thereof, and it is subject to errors, omissions, change of price, rental or other conditions prior to sale, financing or withdrawal without notice. Neither the Owner or Andretta Properties, nor any of its respective directors, officers, affiliates or representatives make any representation or warranty, expressed or implied, as to the accuracy or completeness of this Memorandum or any of its contents, and no legal commitment or obligation shall arise by reason of your receipt of this Memorandum or use of its contents, and you are to rely solely on your investigations and inspections of the Property in evaluating a possible purchase of the real property.