

FLYING S RANCH & AIRPARK RESIDENTIAL DEVELOPMENT WITH AIRPARK

KENANSVILLE, FL | OSCEOLA COUNTY

381.5 ± ACRES TOTAL





Flying S Ranch is a Centrally Located Proposed Rural Airpark & Equestrian Community

The Only Proposed Development of its Type In Florida!

- **Prime fly-in development** location with short flight times to Vero Beach (10 minutes), Kissimmee/Orlando (10 minutes), Melbourne (15 minutes), and Miami (45 minutes).
- **Close proximity to** FlightSafety International's Vero Beach Learning Center and the Piper Aircraft manufacturing facility.
- **Existing FAA and FDOT approved** 100 ± ft wide, 3,200 ± ft length turf runway, a highly desirable airstrip for the rapidly growing sport aviation community.
- **Extensive runway drainage** systems allow for takeoff and landing in rain.
- **Designated** as a private airport.
- **On the Miami sectional** as Flying "S" Ranch.

Proposed Airpark Residential Community with Private Hangers

Proposed Meeting Hall, Equestrian Olympic Events Area, Recreation, Lake & Bridle Paths

Flexible Entitlements Allow Either Hybrid Airpark/Equestrian Development or an Exclusively Aviation Development

PROPOSED PLAT

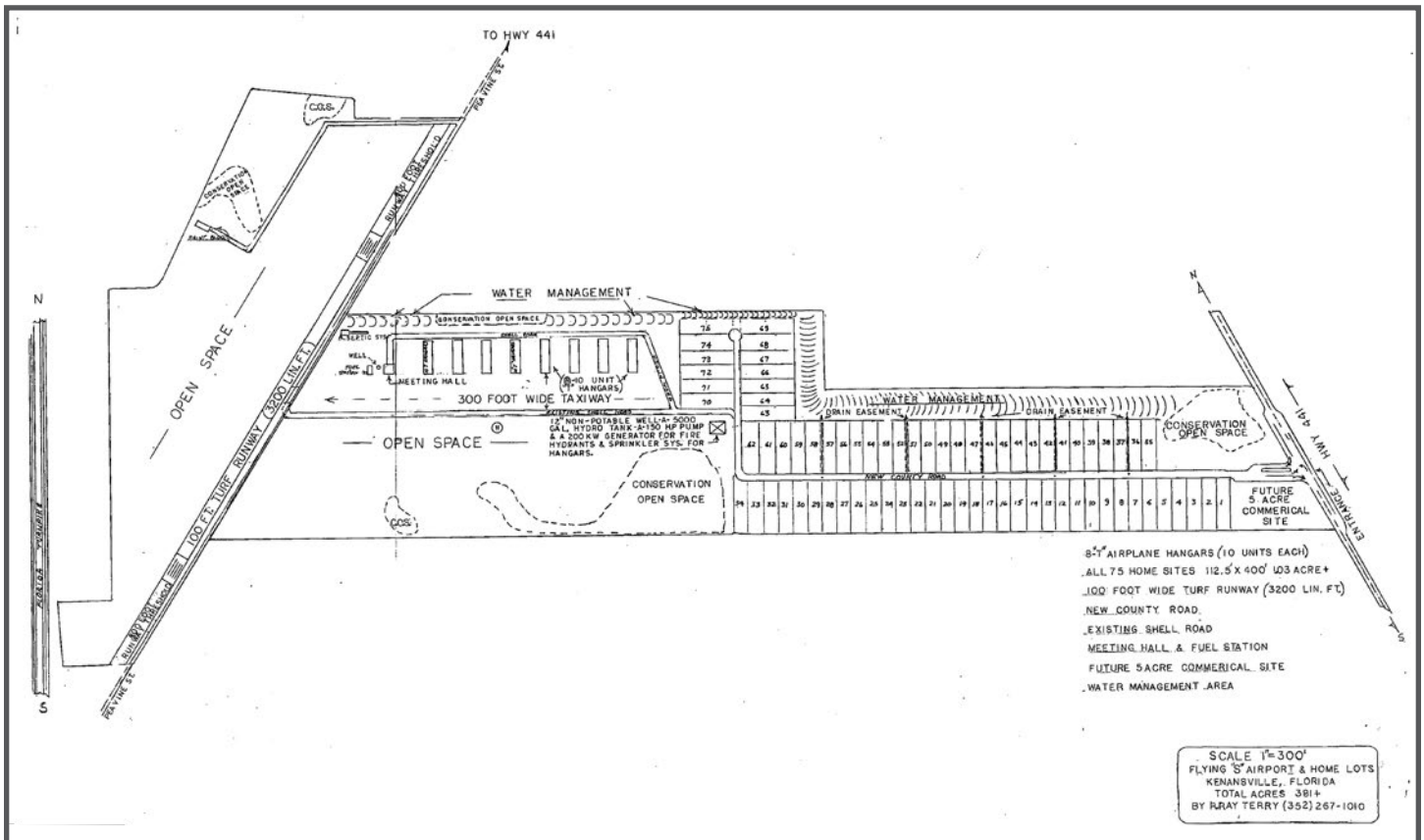

SPECIFICATIONS & FEATURES

Acres: 381.5 ± acres

Sale Price: \$4,200,000

Price per Acre: \$10,485

Permitted Lots: "Planned Residential Development" designation; proposes 75 single-family residential estate homes

County: Osceola

Site Address: 1470 Kenansville Road, Kenansville, FL 34739

Nearest Intersection: US 441 & CR 523 (South Canoe Creek Road)

Road Frontage:

1,250 ± ft on US 441 (entrance)

480 ± ft on Florida's Turnpike (visibility)

Utilities & Water Source: Private well, septic system

FLU: Rural/Agricultural

This unique concept for a rural airpark development will be designed for those seeking a rural retreat focused on access by air. Home designs will be varied, creating a neighborhood with semi-rural character. Private hangars and a 100 ± ft wide, 3,200 ± ft length FAA and FDOT approved turf runway only begin the amenities of this community concept.

Zoning: Planned Residential Development

Uplands/Wetlands: 353 ± acres uplands; 30.5 ± acres wetlands

COA or HOA: None current

- Homeowners association to be established with the Architectural Review Authority
- Will approve the design standards of the homes and accessory structures within the community
- Will enforce the covenants and deed restrictions regarding the use of personal aircraft and community taxiways

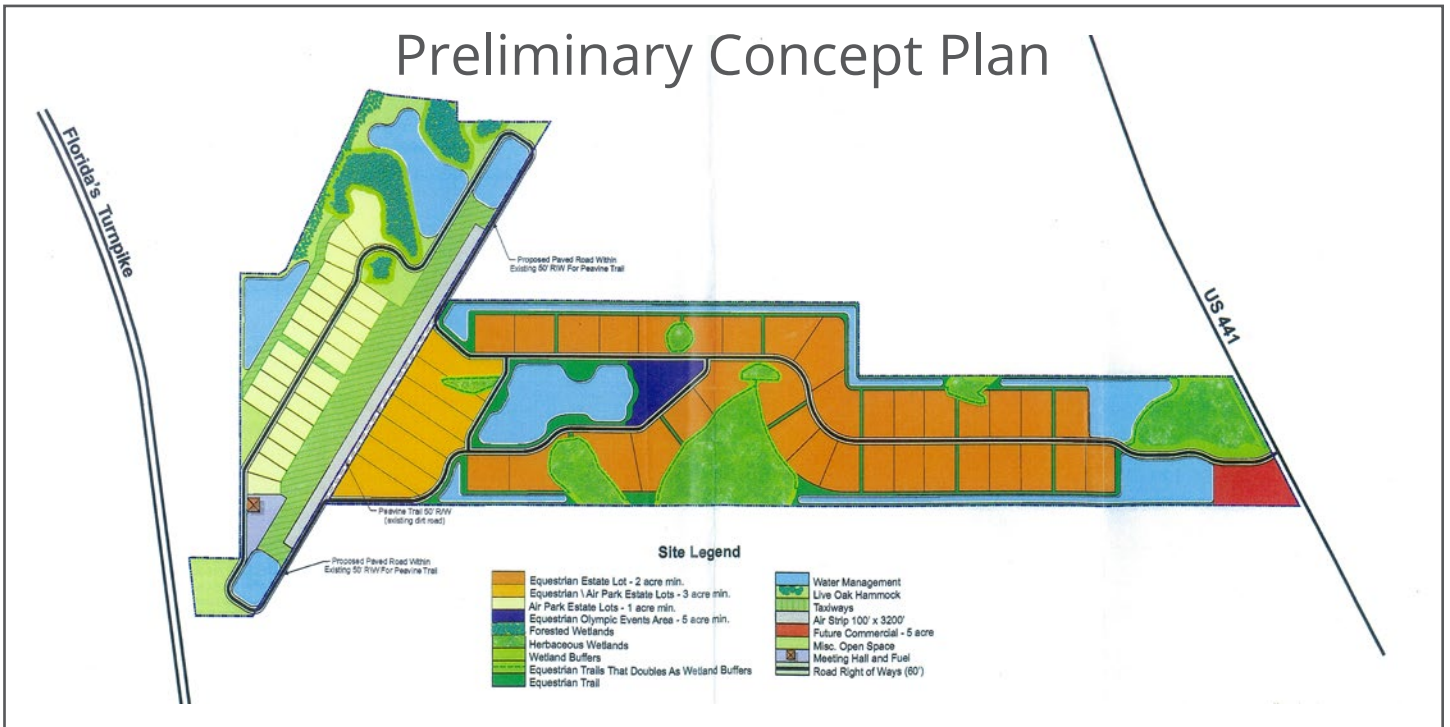
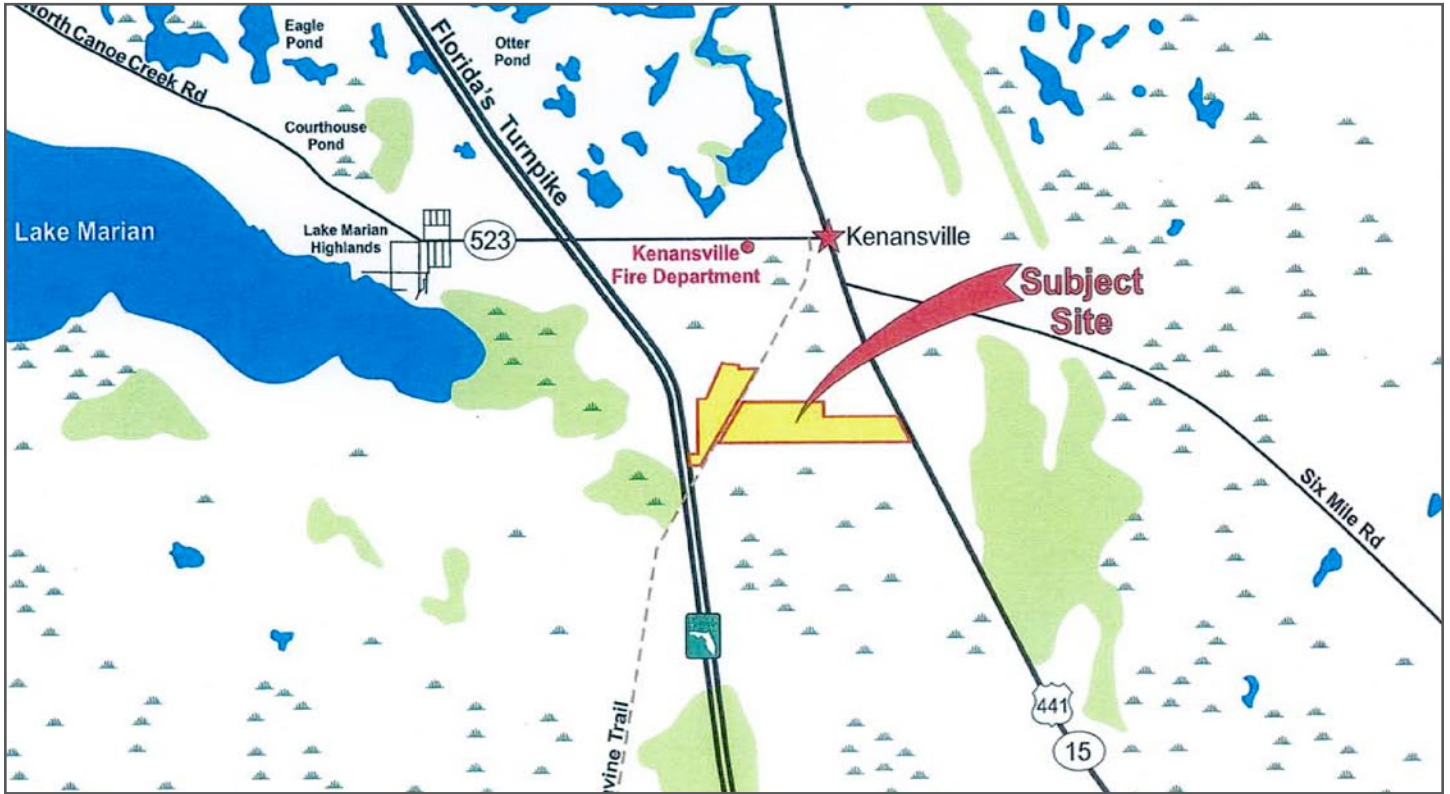

Unique Rural Airpark Residential Community!

Proposed Detached Single-Family Residential Estate Homes & Meeting Hall

Existing 100 ± ft Wide, 3,200 ± ft of Turf Runway • 800 ± ft Runway Threshold

Proposed Private Hangars & On-Site Fuel Tank

LOCATION & DRIVING DIRECTIONS

Parcel IDs:

24-3-0-33-0-000-0050; 22-3-0-33-0-000-0011
 22-3-0-33-0-000-0010; 23-3-0-33-0-000-0017
 23-3-0-33-0-000-0030

GPS Location: 27.856615, -80.978808
 (North Tip on US 441)

Driving Directions:

- From Yeehaw Junction, take US 441 north about 12 miles.
- Property will be on the left.

Showing Instructions: Contact the listing agents to learn more or schedule a showing time.

Drive Times 20-40-60 Min.

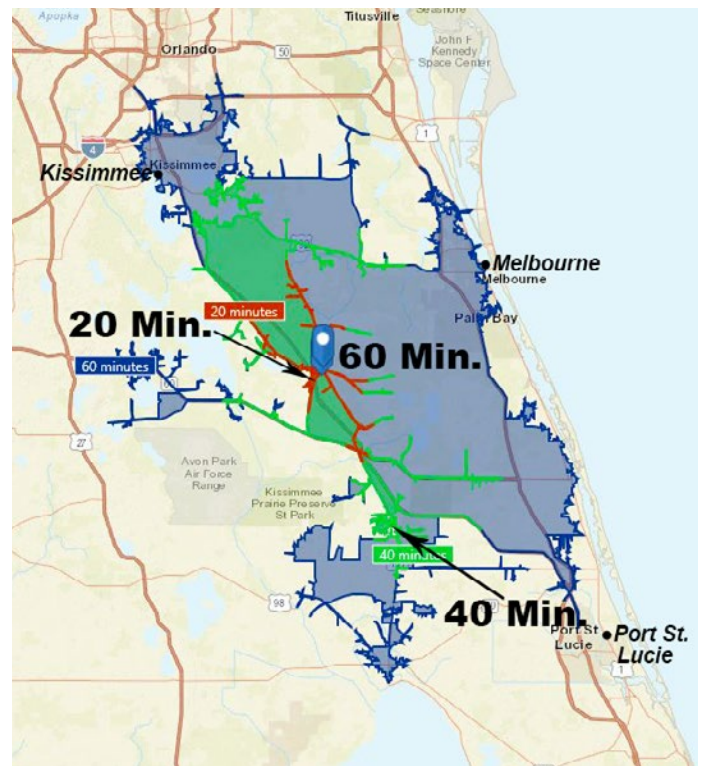

- 10 ± Miles To Florida's Turnpike Exit
- 10 ± Miles to SR 60, a 4-Lane Coast-To-Coast Highway Connecting Vero Beach To Tampa
- 10 ± Miles To Yeehaw Junction (SR 60 & Florida's Turnpike)







Existing FAA & FDOT Approved 3,200 ± ft Turf Runway





1723 Bartow Rd
Lakeland, FL 33801

381.5 ± Acres • Proposed Rural Airpark Residential Community
Existing 100 ± ft Wide, 3,200 ± ft of Turf Runway • 800 ± ft Runway Threshold
Proposed Private Hangars with Fuel Tank On-Site

Visit SVNsaunders.com & Search For: Airpark

Clay Taylor, ALC 863.774.3532 | clay.taylor@svn.com
David Hitchcock, ALC, CCIM 863.272.7155 | david.hitchcock@svn.com
Daniel L. Tatro, J.D. 352.408.2282 | dan@dltcommercial.com



LAKELAND OFFICE:
1723 Bartow Rd.
Lakeland, FL 33801
863.648.1528 - Main Office

LAKE CITY OFFICE:
356 NW Lake City Avenue
Lake City, FL 32055
386.438.5896

©2019 SVN | Saunders Ralston Dantzler Real Estate. All SVN® Offices Independently Owned and Operated
Saunders Ralston Dantzler Real Estate is regarded as an authority on all types of Florida land and
conservation easements, transacting over \$2.5 billion in sales since 1996. Offering land, forestry, and
conservation easement real estate services through Saunders Ralston Dantzler Real Estate and the
Saunders Real Estate Forestry Group, the Saunders team of land professionals offers advisory and
transactional services through their home office in Lakeland, FL, the North Florida office in Lake City,
FL, and the South Georgia office in Thomasville, GA. We provide services to land and commercial clients
through our commercial real estate brokerage, Saunders Ralston Dantzler Real Estate.



051817-A