

AIRPORT INDUSTRIAL PARK

BUILDING 14 – 5207 / 5209 RIO VISTA AVENUE
TAMPA, FL 33634

INDUSTRIAL/OFFICE FOR LEASE
12,000 SF



AVAILABLE IMMEDIATELY



PROPERTY FEATURES

- Includes +/- 1,820 SF of Finished Office Space
- Includes +/- 10,180 SF of Warehouse
- 3 Dock High Doors / 1 Ramp
- Clear Height: 16'
- Sprinklered Building
- Located Across from Tampa International Airport
- Internet Available through Brighthouse and/or Verizon Fios

Owned And Managed By



PETER LAWRENCE COMMERCIAL REAL ESTATE, INC.



For more information, please contact:

JULIA SILVA RETTIG
Director
(813) 204 5332
Julia.rettig@cushwake.com

JEFF LAMM
Director
(813) 204 5376
Jeff.lamm@cushwake.com

SCOTT PEEK
Associate
(813) 204 5364
Scott.peek@cushwake.com

CUSHMAN & WAKEFIELD OF FLORIDA, INC.
One Tampa City Center, Suite 3600
Tampa, Florida 33602-5813
www.cushmanwakefield.com

The depiction in the included photograph of any person, entity, sign, logo or property, other than Cushman & Wakefield's (C&W) client and the property offered by C&W, is incidental only, and is not intended to connote any affiliation, connection, association, sponsorship or approval by or between that which is incidentally depicted and C&W or its client. This listing shall not be deemed an offer to lease, sublease or sell such property; and, in the event of any transaction for such property, no commission shall be earned by or payable to any cooperating broker except if otherwise provided pursuant to the express terms, rates and conditions of C&W's agreement with its principal, if, as and when such commission (if any) is actually received from such principal. (A copy of the rates and conditions referred to above with respect to this property is available upon request.)

AIRPORT INDUSTRIAL PARK

5207 / 5209 RIO VISTA AVENUE

12,000 SF
AVAILABLE

SITE PLAN

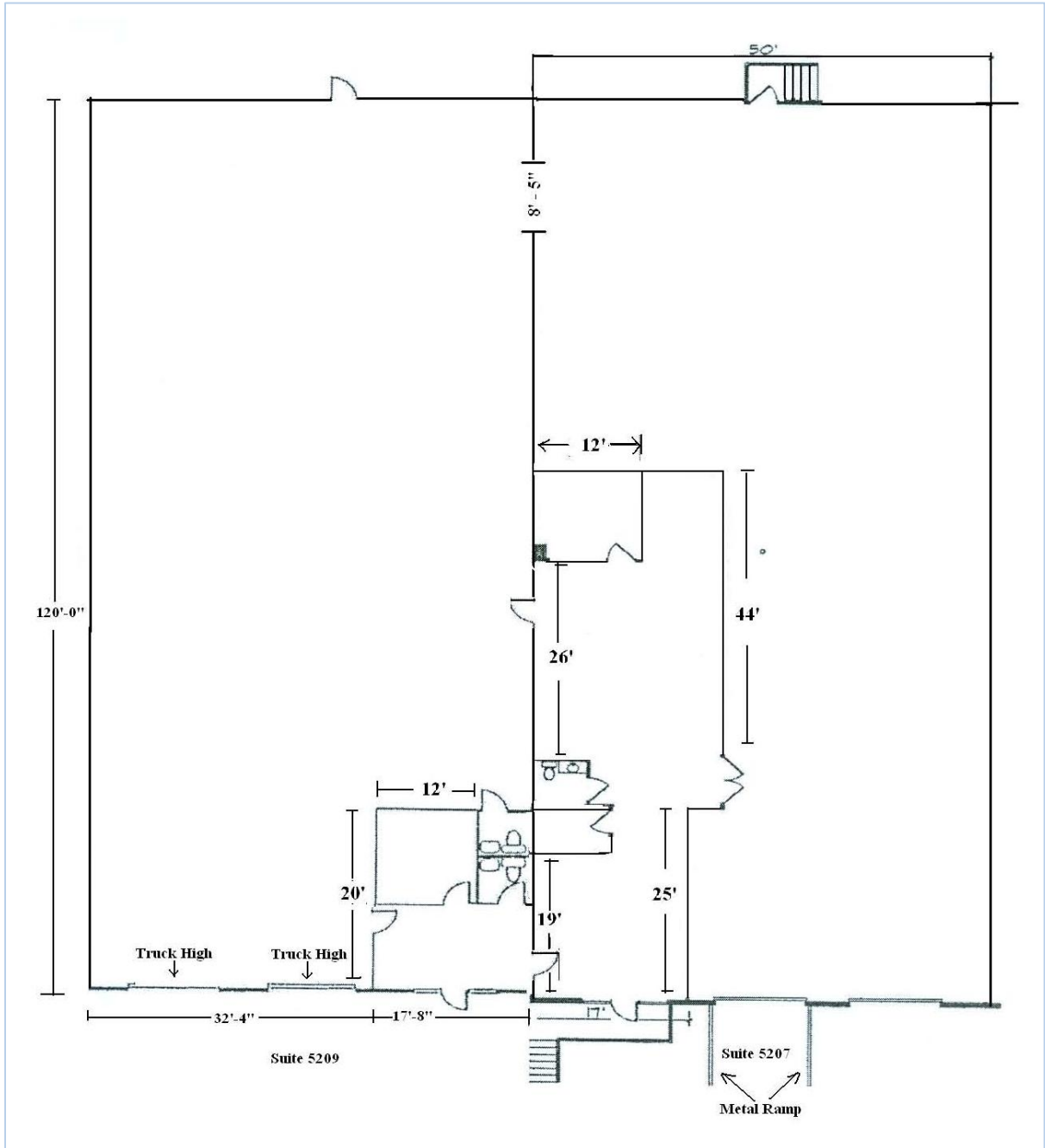

Airport Industrial Park
5207 / 5209 Rio Vista Avenue
Tampa, FL 33634
12,000 Square Feet

For more information, please contact:

JULIA SILVA RETTIG
Director
(813) 204 5332
julia.rettig@cushwake.com

JEFF LAMM
Director
(813) 204 5376
jeff.lamm@cushwake.com

SCOTT PEEK
Associate
(813) 204 5364
scott.peek@cushwake.com

CUSHMAN & WAKEFIELD OF FLORIDA, INC.
One Tampa City Center, Suite 3600
Tampa, Florida 33602-5813
www.cushmanwakefield.com

The depiction in the included photograph of any person, entity, sign, logo or property, other than Cushman & Wakefield's (C&W) client and the property offered by C&W, is incidental only, and is not intended to connote any affiliation, connection, association, sponsorship or approval by or between that which is incidentally depicted and C&W or its client. This listing shall not be deemed an offer to lease, sublease or sell such property; and, in the event of any transaction for such property, no commission shall be earned by or payable to any cooperating broker except if otherwise provided pursuant to the express terms, rates and conditions of C&W's agreement with its principal, if, as and when such commission (if any) is actually received from such principal. (A copy of the rates and conditions referred to above with respect to this property is available upon request.)