

15 Morgan Street, Unit 2
Crystal Lake, IL 60014

For Lease

MLS #12080160

LIGHT INDUSTRIAL



LIGHT INDUSTRIAL 2,670 SF

\$2,002.50 /MO. (GROSS) \$9. PSF

LIGHT INDUSTRIAL SPACE
± 2,670 SF

One space available in this multi-tenant building. Ideal for contractors, small trades or storage. Close to downtown Crystal Lake and Route 176.

UNIT 2: ±2,670 SF heated warehouse/shop with 8'x9' DID and new bathroom. \$2,002.50 /mo. Gross. CAM and taxes included.

Specifications

Building Size:	9,679 SF
Year Built:	1942
HVAC System:	GFA (heat)
Electrical:	200 amp 3 phase
Sprinklers:	No
Washrooms:	1 ADA
Ceiling Height:	9 ft
Parking:	Common
DID's:	(1) 8'x9'
Floor Drains:	No
Sewer/Water:	City
Zoning:	ML
CAM & Taxes	Included
PIN #:	14-33-381-009

[CLICK HERE TO VIEW OUR WEBSITE](#)

No warranty or representation is made as to the accuracy of the foregoing information. Terms of sale or lease and availability are subject to change or withdrawal without notice. This document is for information purposes only. No offer of sub-agency is being made.



www.PremierCommercialRealty.com | 847.854.2300 | 9225 S. Route 31, Lake in the Hills, IL 60156

VP / Designated Managing Broker
Heather Schweitzer
HeatherS@PremierCommercialRealty.com
O: 847.854.2300 x15 C: 815.236.9816

15 Morgan Street, Unit 2

Crystal Lake, IL 60014

For Lease

LIGHT INDUSTRIAL

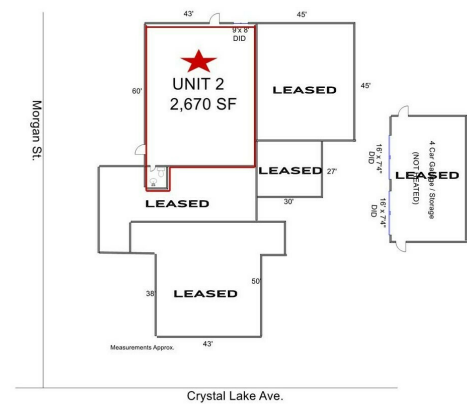

[CLICK HERE TO VIEW OUR WEBSITE](#)

No warranty or representation is made as to the accuracy of the foregoing information. Terms of sale or lease and availability are subject to change or withdrawal without notice. This document is for information purposes only. No offer of sub-agency is being made.



www.PremierCommercialRealty.com | 847.854.2300 | 9225 S. Route 31, Lake in the Hills, IL 60156

VP / Designated Managing Broker
Heather Schweitzer
HeatherS@PremierCommercialRealty.com
O: 847.854.2300 x15 C: 815.236.9816