

STREET RETAIL FOR LEASE

Retail at the Center of SE Palm Bay • 3565 Jupiter Blvd SE Palm Bay, FL 32909



OFFERING SUMMARY

Available SF:	1,152 SF
Lease Rate:	\$18.00 SF/yr (\$4.00/sf NNN)
Lot Size:	2.12 Acres
Year Built:	2007
Building Size:	15,970 SF
Zoning:	NC
Market:	South Brevard
Submarket:	Palm Bay

PROPERTY OVERVIEW

Great corner retail plaza.
Ample parking.
Easy access via Jupiter and Emerson.
Conveniently located amid high-density residential neighborhoods

Spaces delivered as a vanilla shell

LOCATION OVERVIEW

Located on the NE corner of Emerson Dr. SE and Jupiter Blvd. SE one of Palm Bay's largest intersections surrounded by dense residential housing.

JEFFERY T. ROBISON, CCIM

President | Broker
321.722.0707 X13
jeff@teamlbr.com

J. BLAKE ROBISON

Retail Sales And Leasing Advisor
321.722.0707 X18
blake@teamlbr.com

VITOR DE SOUSA, CCIM

Retail Sales & Leasing
321.722.0707 X15
vitor@teamlbr.com

Lightle Beckner Robison, Inc.

321.722.0707 • teamlbr.com
70 W. Hibiscus Blvd.,
Melbourne, FL 32901

Information contained herein has been obtained through sources deemed reliable but cannot be guaranteed as to its accuracy. A purchaser or lessee is expected to verify all information to his/her own satisfaction. Zoning information subject to change and not warranted. Always confirm current requirements with local governing agencies.

ADDITIONAL PHOTOS

Retail at the Center of SE Palm Bay • 3565 Jupiter Blvd SE Palm Bay, FL 32909

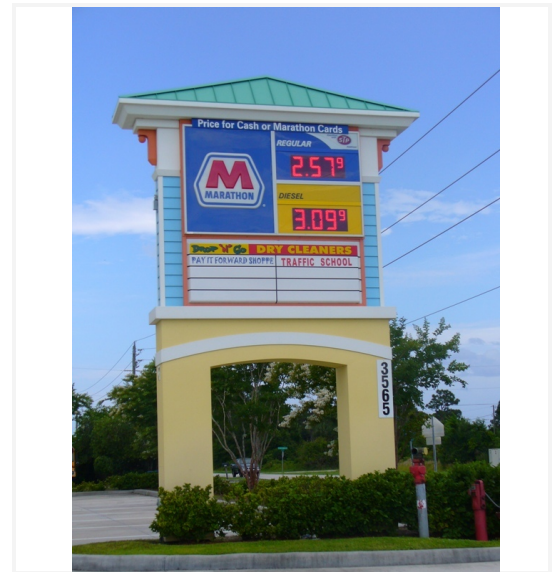

JEFFERY T. ROBISON, CCIM

President | Broker
321.722.0707 X13
jeff@teamlbr.com

J. BLAKE ROBISON

Retail Sales And Leasing Advisor
321.722.0707 X18
blake@teamlbr.com

VITOR DE SOUSA, CCIM

Retail Sales & Leasing
321.722.0707 X15
vitor@teamlbr.com

Lightle Beckner Robison, Inc.

321.722.0707 • teamlbr.com
70 W. Hibiscus Blvd.,
Melbourne, FL 32901

Information contained herein has been obtained through sources deemed reliable but cannot be guaranteed as to its accuracy. A purchaser or lessee is expected to verify all information to his/her own satisfaction. Zoning information subject to change and not warranted. Always confirm current requirements with local governing agencies.

AVAILABLE SPACES

Retail at the Center of SE Palm Bay • 3565 Jupiter Blvd SE Palm Bay, FL 32909

LEASE TYPE | \$4.00/sf NNN

TOTAL SPACE | 1,152 SF

LEASE TERM | Negotiable

LEASE RATE | \$18.00 SF/yr

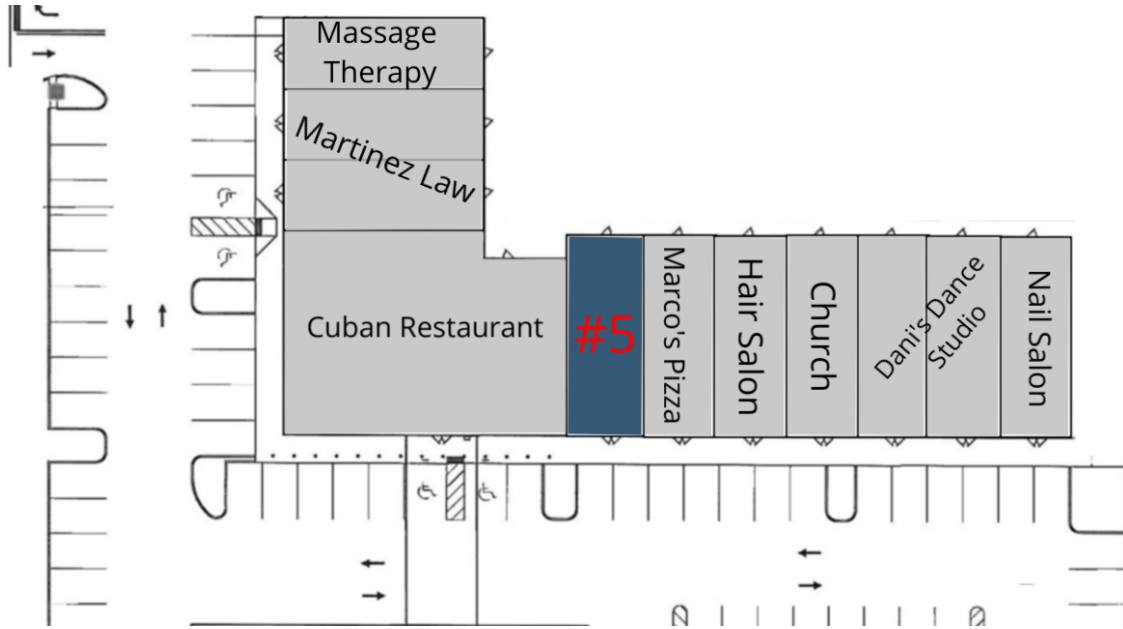

UNAVAILABLE

AVAILABLE

SUITE	TENANT	SIZE	TYPE	RATE
#5	Available	1,152 SF	\$4.00/sf NNN	\$18.00 SF/yr

JEFFERY T. ROBISON, CCIM

President | Broker
321.722.0707 X13
jeff@teamlbr.com

J. BLAKE ROBISON

Retail Sales And Leasing Advisor
321.722.0707 X18
blake@teamlbr.com

VITOR DE SOUSA, CCIM

Retail Sales & Leasing
321.722.0707 X15
vitor@teamlbr.com

Lightle Beckner Robison, Inc.

321.722.0707 • teamlbr.com
70 W. Hibiscus Blvd.,
Melbourne, FL 32901

Information contained herein has been obtained through sources deemed reliable but cannot be guaranteed as to its accuracy. A purchaser or lessee is expected to verify all information to his/her own satisfaction. Zoning information subject to change and not warranted. Always confirm current requirements with local governing agencies.

LOCATION MAPS

Retail at the Center of SE Palm Bay • 3565 Jupiter Blvd SE Palm Bay, FL 32909

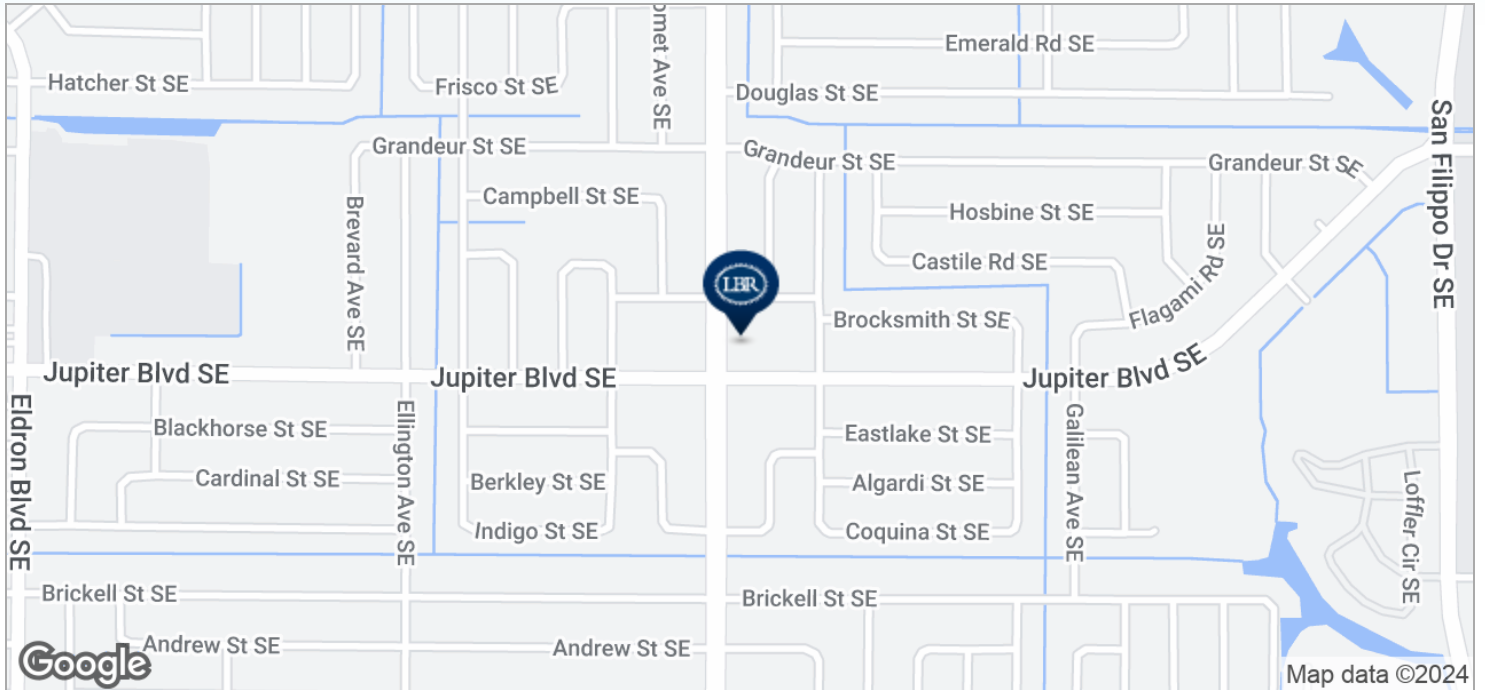

JEFFERY T. ROBISON, CCIM

President | Broker
321.722.0707 X13
jeff@teamlbr.com

J. BLAKE ROBISON

Retail Sales And Leasing Advisor
321.722.0707 X18
blake@teamlbr.com

VITOR DE SOUSA, CCIM

Retail Sales & Leasing
321.722.0707 X15
vitor@teamlbr.com

Lightle Beckner Robison, Inc.

321.722.0707 • teamlbr.com
70 W. Hibiscus Blvd.,
Melbourne, FL 32901

Information contained herein has been obtained through sources deemed reliable but cannot be guaranteed as to its accuracy. A purchaser or lessee is expected to verify all information to his/her own satisfaction. Zoning information subject to change and not warranted. Always confirm current requirements with local governing agencies.

DEMOGRAPHICS MAP

Retail at the Center of SE Palm Bay • 3565 Jupiter Blvd SE Palm Bay, FL 32909

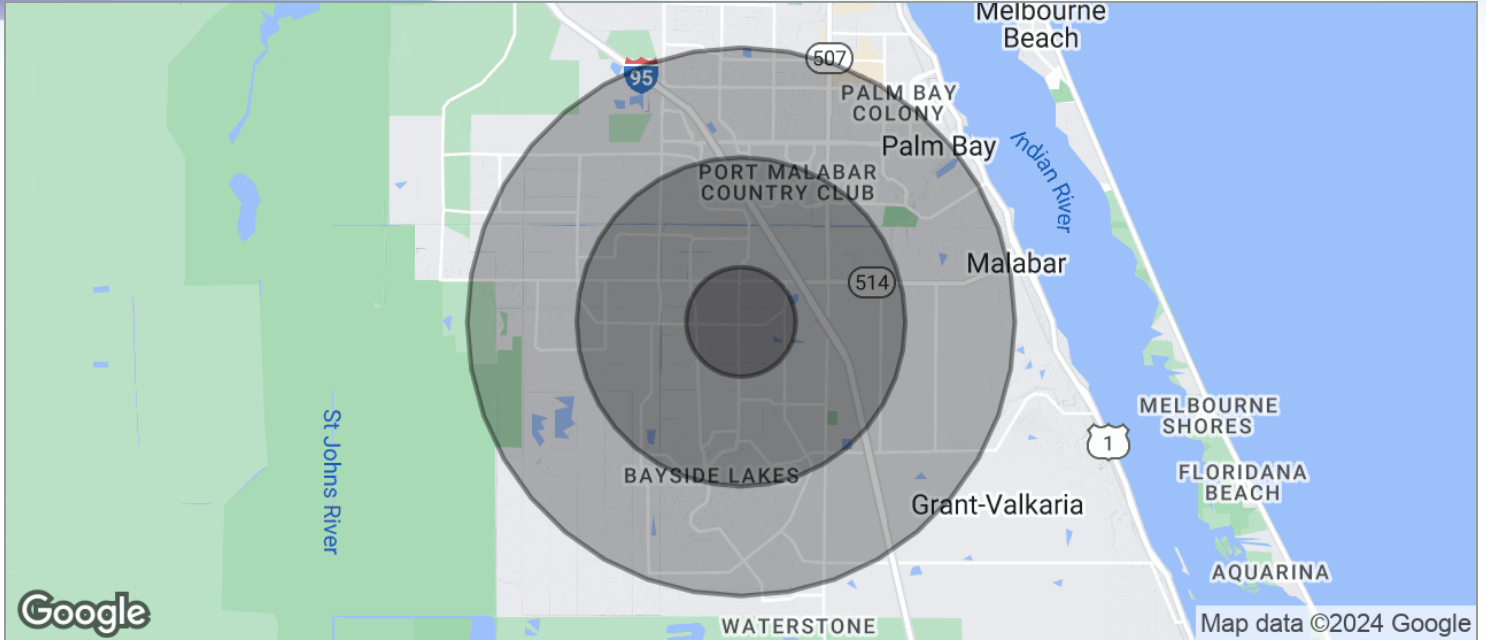

POPULATION	1 MILE	3 MILES	5 MILES
TOTAL POPULATION	4,904	44,437	107,509
MEDIAN AGE	38.5	39.5	39.9
MEDIAN AGE (MALE)	37.7	37.8	37.6
MEDIAN AGE (FEMALE)	38.9	41.3	42.0
HOUSEHOLDS & INCOME	1 MILE	3 MILES	5 MILES
TOTAL HOUSEHOLDS	1,766	16,216	40,815
# OF PERSONS PER HH	2.8	2.7	2.6
AVERAGE HH INCOME	\$51,414	\$55,363	\$55,856
AVERAGE HOUSE VALUE		\$178,927	\$182,423

* Demographic data derived from 2020 ACS - US Census

JEFFERY T. ROBISON, CCIM

President | Broker
321.722.0707 X13
jeff@teamlbr.com

J. BLAKE ROBISON

Retail Sales And Leasing Advisor
321.722.0707 X18
blake@teamlbr.com

VITOR DE SOUSA, CCIM

Retail Sales & Leasing
321.722.0707 X15
vitor@teamlbr.com

Lightle Beckner Robison, Inc.

321.722.0707 • teamlbr.com
70 W. Hibiscus Blvd.,
Melbourne, FL 32901

Information contained herein has been obtained through sources deemed reliable but cannot be guaranteed as to its accuracy. A purchaser or lessee is expected to verify all information to his/her own satisfaction. Zoning information subject to change and not warranted. Always confirm current requirements with local governing agencies.