

# 603 Central Florida Parkway

603 Central Florida Parkway, Orlando, Florida 32824

## FOR LEASE

UP TO 20,000 SF SPACE  
AND 1.5 AC INDUSTRIAL YARD



RAIL LINE

CENTRAL FLORIDA PARKWAY



CUSHMAN &  
WAKEFIELD

# 603 Central Florida Parkway

603 Central Florida Parkway, Orlando, Florida 32824

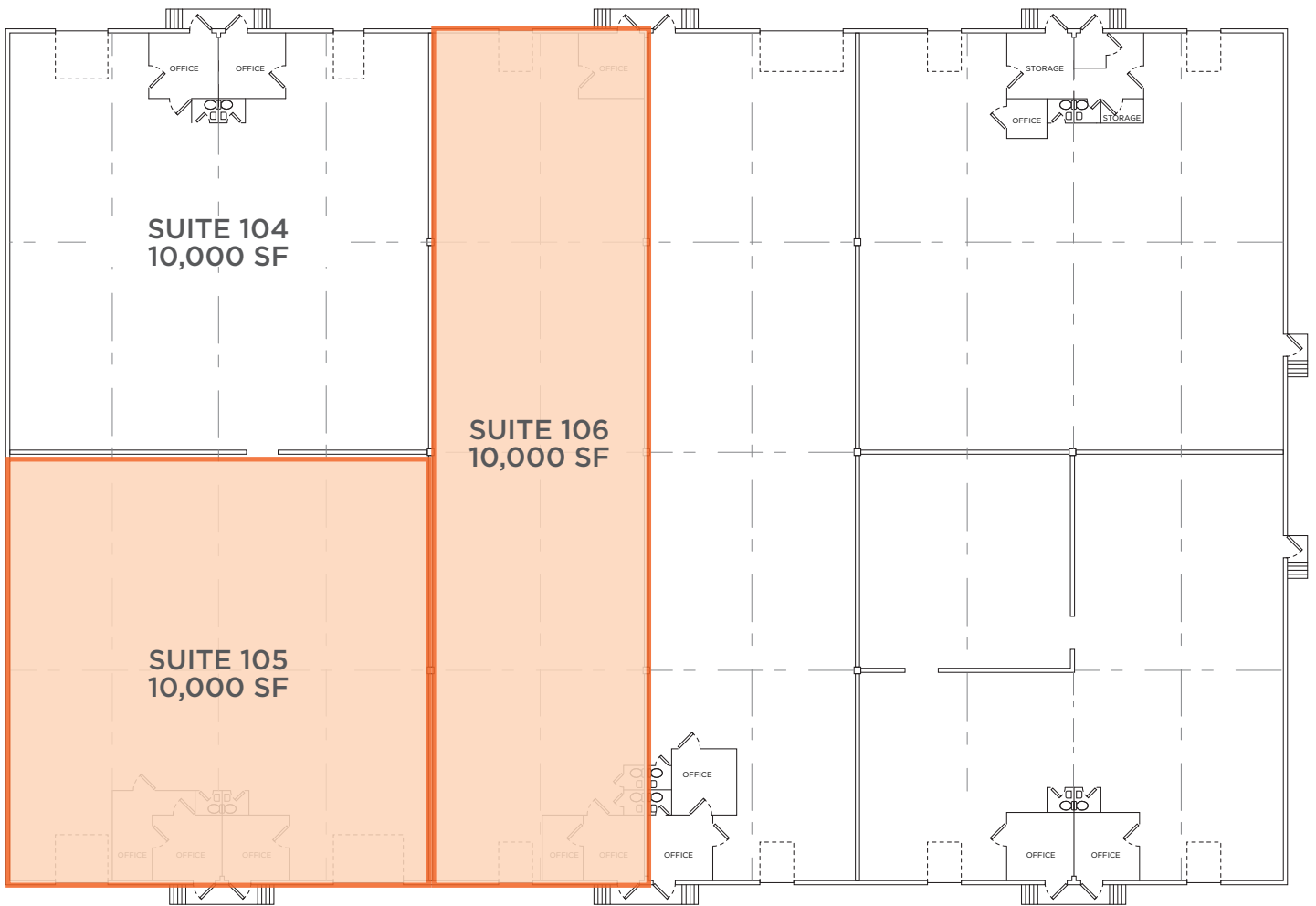

## SPACE HIGHLIGHTS

**UNDISCLOSED**

ASKING RATE

**\$4.73 PSF**

OPEX\*

**3-PHASE**

POWER

**UP TO 20,000 SF**

AVAILABLE SF

**CROSS DOCK**

LOADING CONFIGURATION

**1980**

YEAR BUILT

**6 (9'x10')**

DOCK DOORS

**I-4**

ZONING

**30 DAYS**

AVAILABILITY

*\*Denotes Estimated Operating Expenses for 2024*

# 603 Central Florida Parkway

603 Central Florida Parkway, Orlando, Florida 32824



## OUTSIDE STORAGE HIGHLIGHTS

---

**1.5 ACRES**  
OUTSIDE STORAGE

**\$5,000/AC/MONTH**  
ASKING RATE

**IMMEDIATELY**  
AVAILABILITY

**4.85 ACRES**  
TOTAL SITE SIZE

**I-4**  
ZONING

# 603 Central Florida Parkway

603 Central Florida Parkway, Orlando, Florida 32824

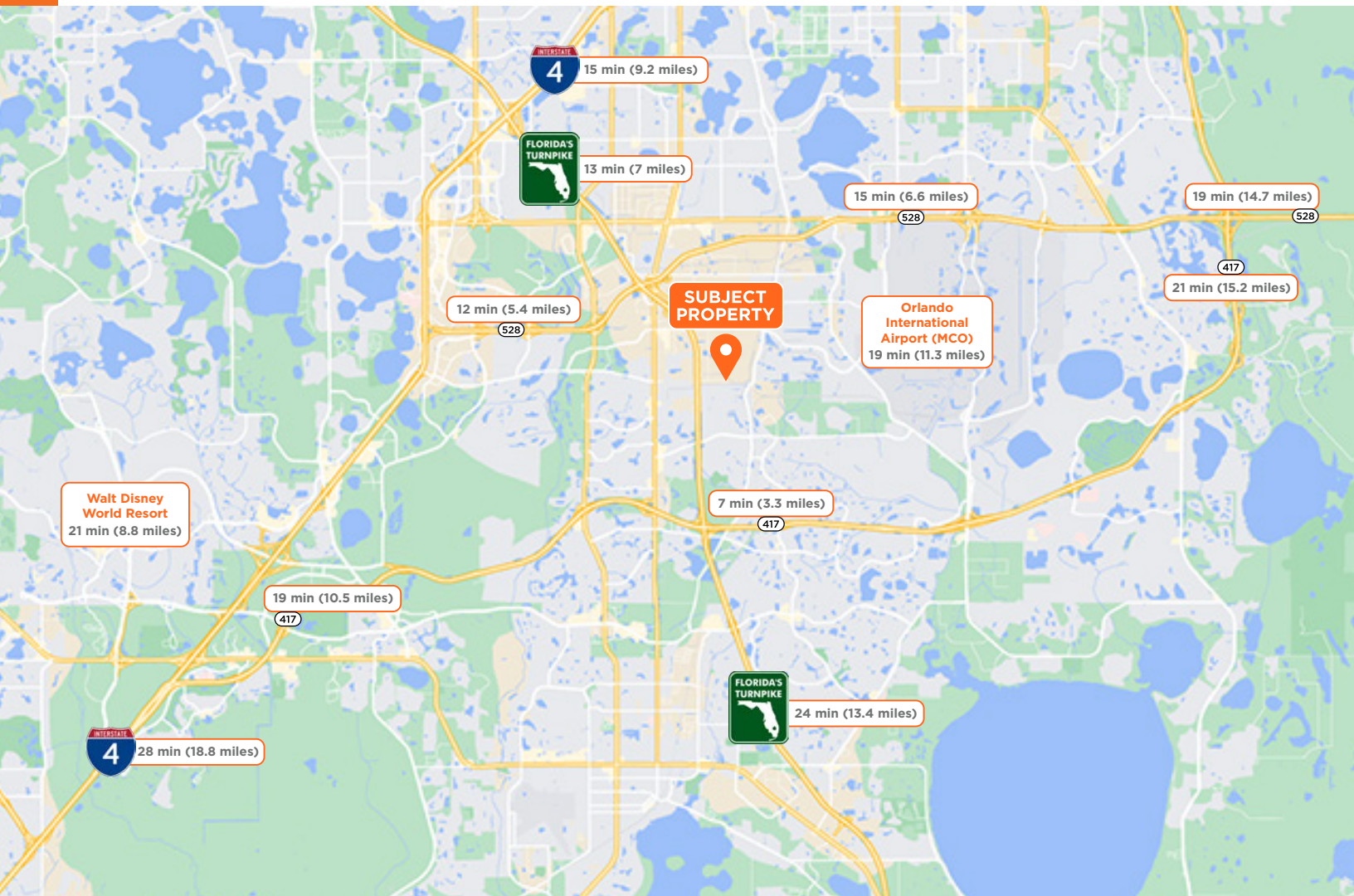

## FOR MORE INFORMATION, CONTACT:

### JARED BONSHIRE, SIOR

Executive Managing Director  
+1 407 541 4414  
jared.bonshire@cushwake.com

### DAVID PEREZ

Executive Managing Director  
+1 407 541 4435  
david.perez@cushwake.com

### TAYLOR ZAMBITO

Senior Director  
+1 407 541 4409  
taylor.zambito@cushwake.com

### RYAN HUBBARD

Director  
+1 407 541 4390  
ryan.hubbard@cushwake.com

20 N. Orange Avenue Suite 300  
Orlando, FL 32801  
United States  
+1 407 841 8000  
[cushmanwakefield.com](http://cushmanwakefield.com)



©2024 Cushman & Wakefield. All rights reserved. The information contained in this communication is strictly confidential. This information has been obtained from sources believed to be reliable but has not been verified. NO WARRANTY OR REPRESENTATION, EXPRESS OR IMPLIED, IS MADE AS TO THE CONDITION OF THE PROPERTY (OR PROPERTIES) REFERENCED HEREIN OR AS TO THE ACCURACY OR COMPLETENESS OF THE INFORMATION CONTAINED HEREIN, AND SAME IS SUBMITTED SUBJECT TO ERRORS, OMISSIONS, CHANGE OF PRICE, RENTAL OR OTHER CONDITIONS, WITHDRAWAL WITHOUT NOTICE, AND TO ANY SPECIAL LISTING CONDITIONS IMPOSED BY THE PROPERTY OWNER(S). ANY PROJECTIONS, OPINIONS OR ESTIMATES ARE SUBJECT TO UNCERTAINTY AND DO NOT SIGNIFY CURRENT OR FUTURE PROPERTY PERFORMANCE.