



2402 CLARK ST.
18,600 - 39,000 SF FOR LEASE

PROPERTY FEATURES

2402 Clark Street is a multi-tenant, grade level, warehouse building in the heavy industrial pocket of Apopka. The property is located near the intersection of N Orange Blossom Trail and Maitland Blvd (SR 414) which provides convenient access to I-4, and the newly completed 429 Beltway. Recent renovations include fully reconditioned office with new flooring, paint, and large breakroom.

1-2 ACRES OF OUTDOOR STORAGE AVAILABLE NEARBY



PROPERTY SPECIFICATIONS	UNIT 1	UNIT 3
ADDRESS	2402 Clark St, Apopka, FL 32703	2402 Clark St, Apopka, FL 32703
AVAILABLE SPACE	18,600 +/- SF	20,400 +/- SF
OFFICE	4,150 +/- SF	1,356 +/- SF
MEZZANINE	4,000 +/- SF	
OVERHEAD DOORS	2 - 10' x 10' 1 - 14' x 12'	3 - 14' x 12' 1 - 14' x 14' 1 - 8' x 10'
AVAILABLE	Now	November
FIRE SPRINKLERS		Installed
CLEAR HEIGHT		17'8" - 20'5"
PARKING	Fully fenced and secured	

FOR MORE INFORMATION, PLEASE CONTACT:

JEROD FREELAND | 321.591.5404
Jerod.Freeland@foundrycommercial.com
Licensed Real Estate Broker

CHARLES ATTAWAY | 407.963.4064
Charles.Attaway@foundrycommercial.com
Licensed Real Estate Broker

2402 CLARK ST.

FLOOR PLAN

UNIT 1

UNIT 3

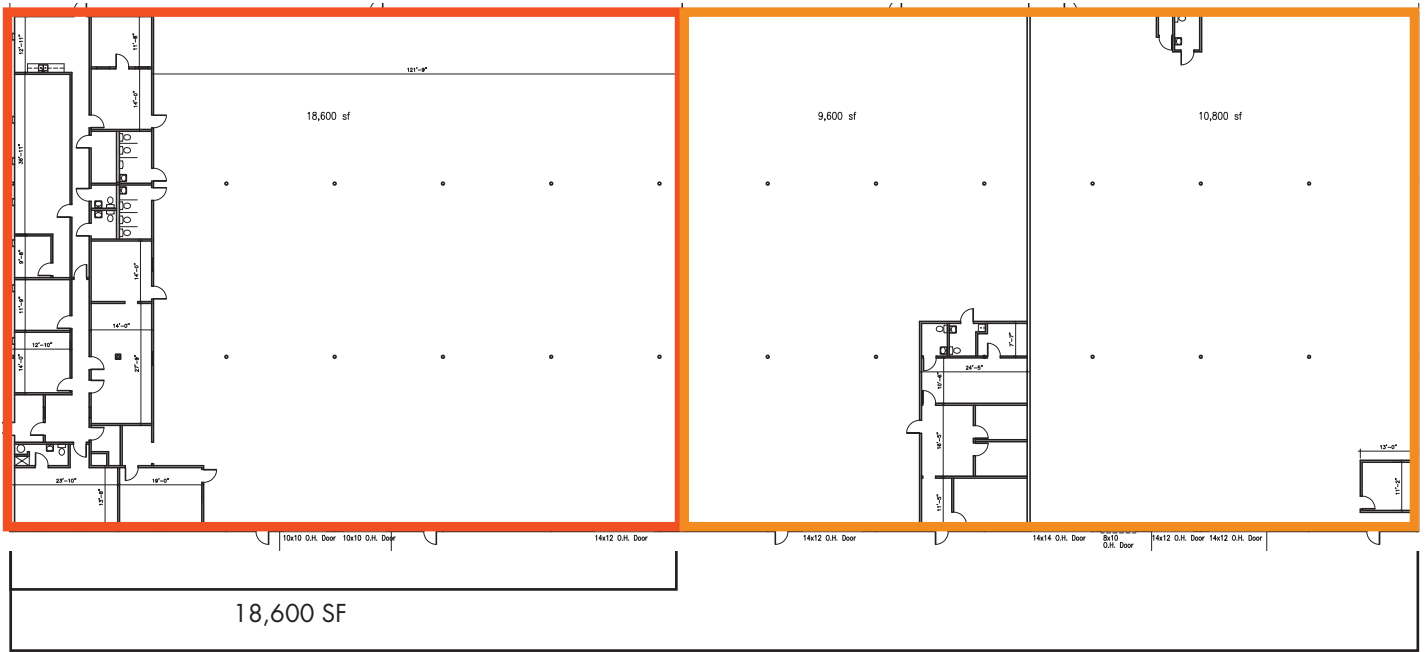

39,000 SF

LOCATION

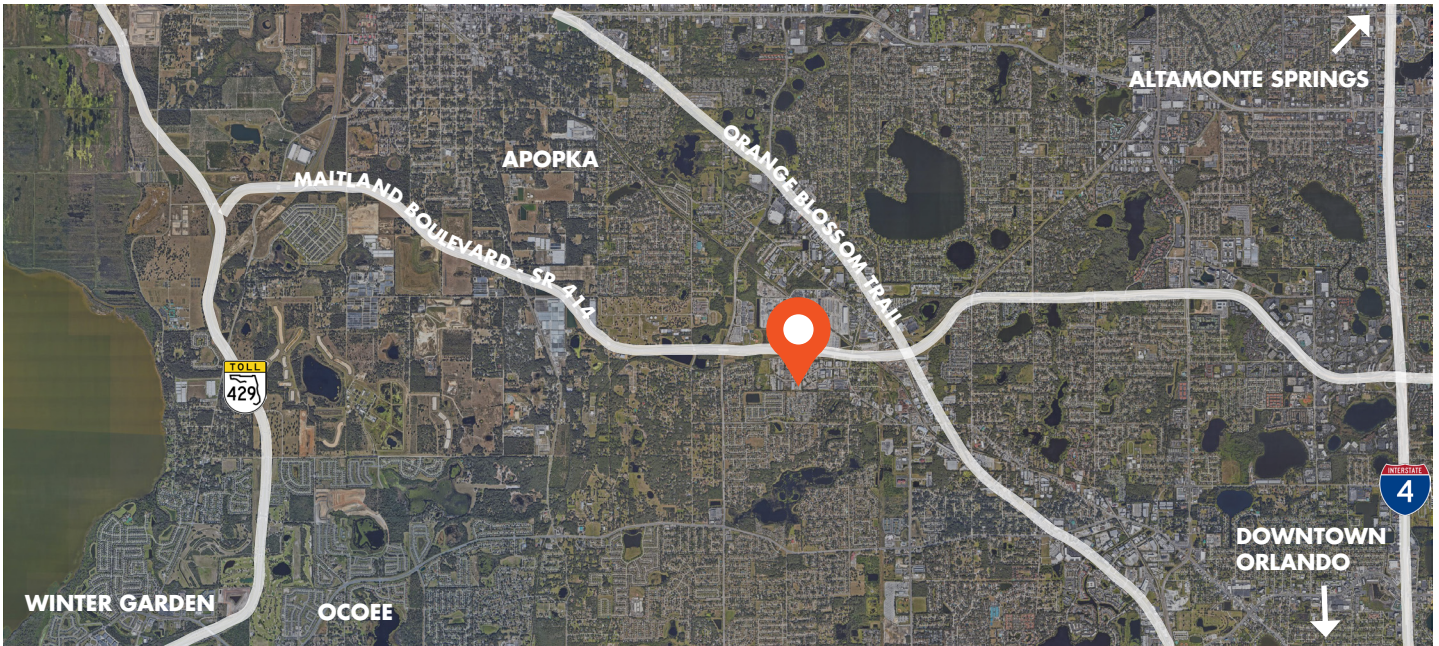

FOR MORE INFORMATION, PLEASE CONTACT:

JEROD FREELAND | 321.591.5404
 Jerod.Freeland@foundrycommercial.com
 Licensed Real Estate Broker

CHARLES ATTAWAY | 407.963.4064
 Charles.Attaway@foundrycommercial.com
 Licensed Real Estate Broker



APOPKA, FL

±18,600 - 39,000 RSF AVAILABLE FOR LEASE

2402 CLARK ST.

NEWLY RENOVATED OFFICE SPACE - UNIT 1



FOR MORE INFORMATION, PLEASE CONTACT:

JEROD FREELAND | 321.591.5404
Jerod.Freeland@foundrycommercial.com
Licensed Real Estate Broker

CHARLES ATTAWAY | 407.963.4064
Charles.Attaway@foundrycommercial.com
Licensed Real Estate Broker

FOUNDRY
COMMERCIAL

Although the information contained herein was provided by sources believed to be reliable, Foundry Commercial makes no representation, expressed or implied, as to its accuracy and said information is subject to errors, omissions or changes.

foundrycommercial.com