

For Lease

Newly Renovated Office Building

1,077 - 3,675 SF | \$27.00 / SF Full Service



1500 Lee Road

Orlando, Florida 32810

Property Highlights

- Customize your space to fit your needs in this newly renovated office building
- Suites range from 1,100± SF to 10,500± SF
- Located directly on Lee Road (SR 423), one of Orlando's main thoroughfares (41,500 VPD)
- Conveniently located 1 mile west of I-4 (149,000 VPD) - allows access to entire Orlando MSA
- Close proximity to Starbucks, Home Depot, Walmart, Foxtail Coffee, Tesla, Christner's Steakhouse
- Lighted parking lot with 67 spaces
- Strong internet connectivity - building wired for high speed
- Secure 24/7 access
- Dedicated exterior entrances for each first floor suite
- Monument signage on Lee Road

AVAILABLE SPACES

Space	Lease Rate	Size (SF)
Suite 1	\$27.00 SF/yr	1,551
Suite 2	\$27.00 SF/yr	3,406
Suite 3	\$27.00 SF/yr	1,557
Suite 4	\$27.00 SF/yr	1,101
Suite 5	\$27.00 SF/yr	1,077
Suite 6 & Flex Space	\$27.00 SF/yr	1,871

For more information

Al Fishalow

O: 407 949 0731
afishalow@realvest.com

Jeffrey Bloom, CCIM

O: 407 949 0709
jbloom@realvest.com

Hillary S. Bressler

O: 407 949 0729
hbressler@realvest.com

First Floor



Second Floor

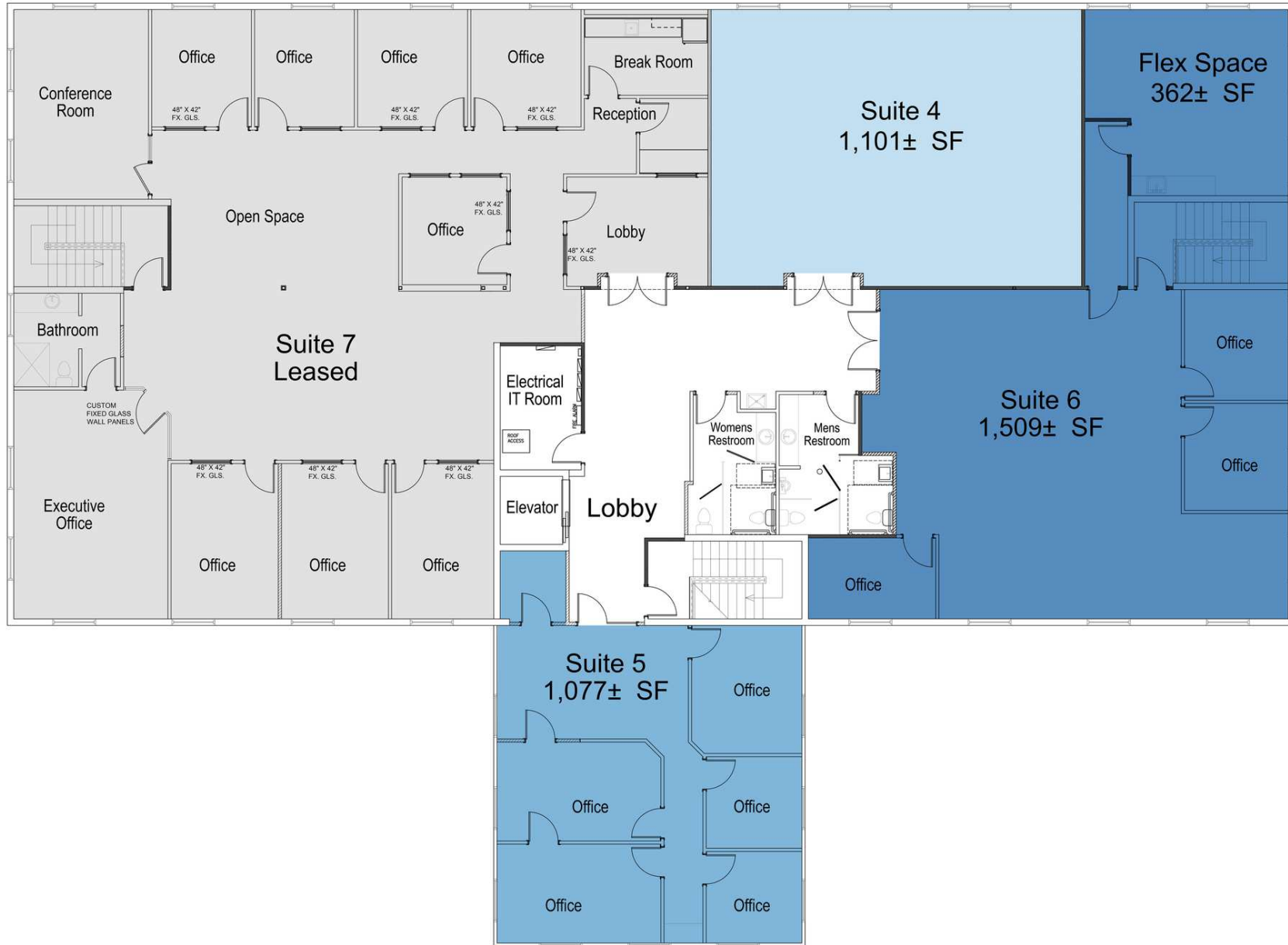

Retailer Map



Map data ©2024 Google Imagery ©2024 Airbus, Maxar Technologies

Location Maps

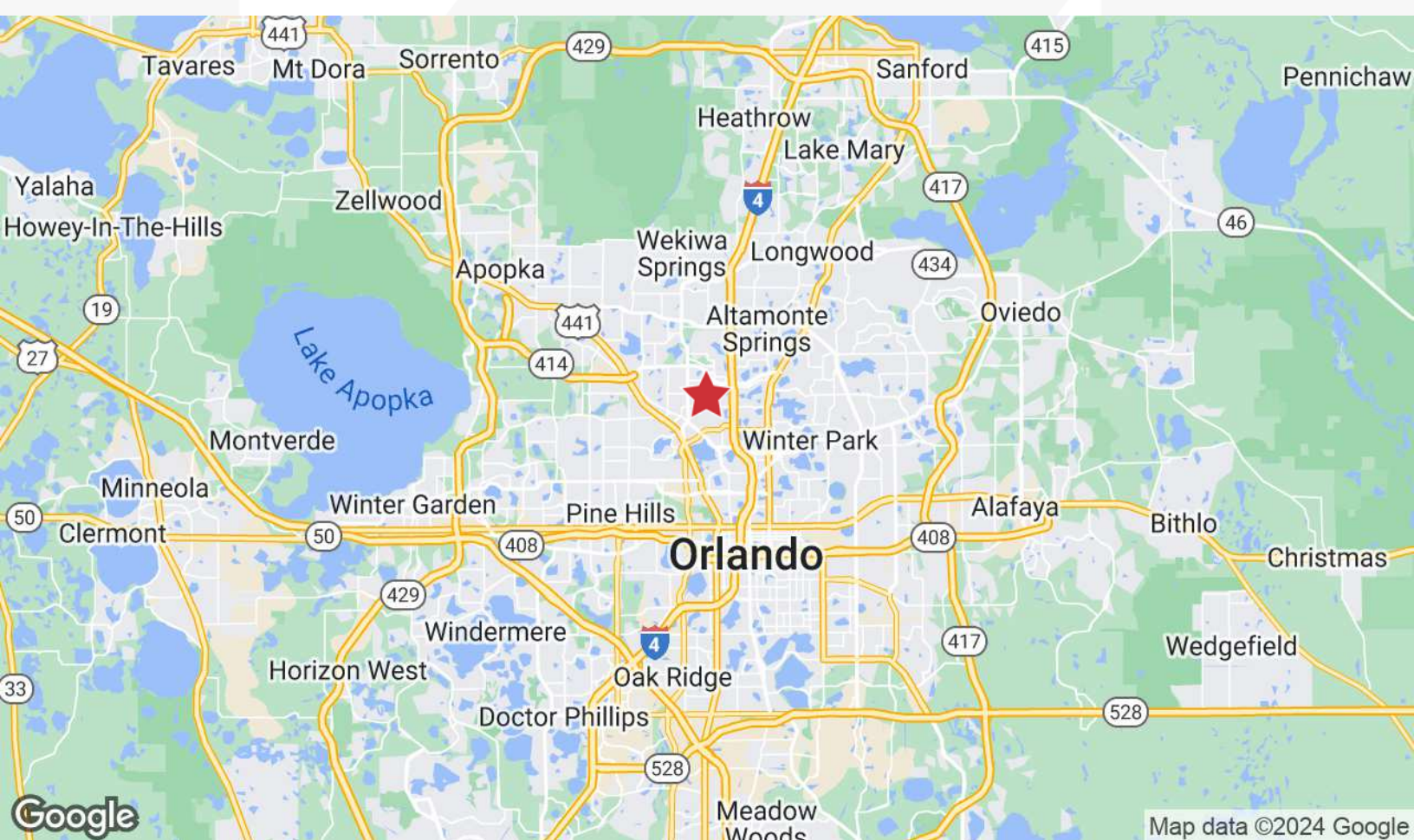
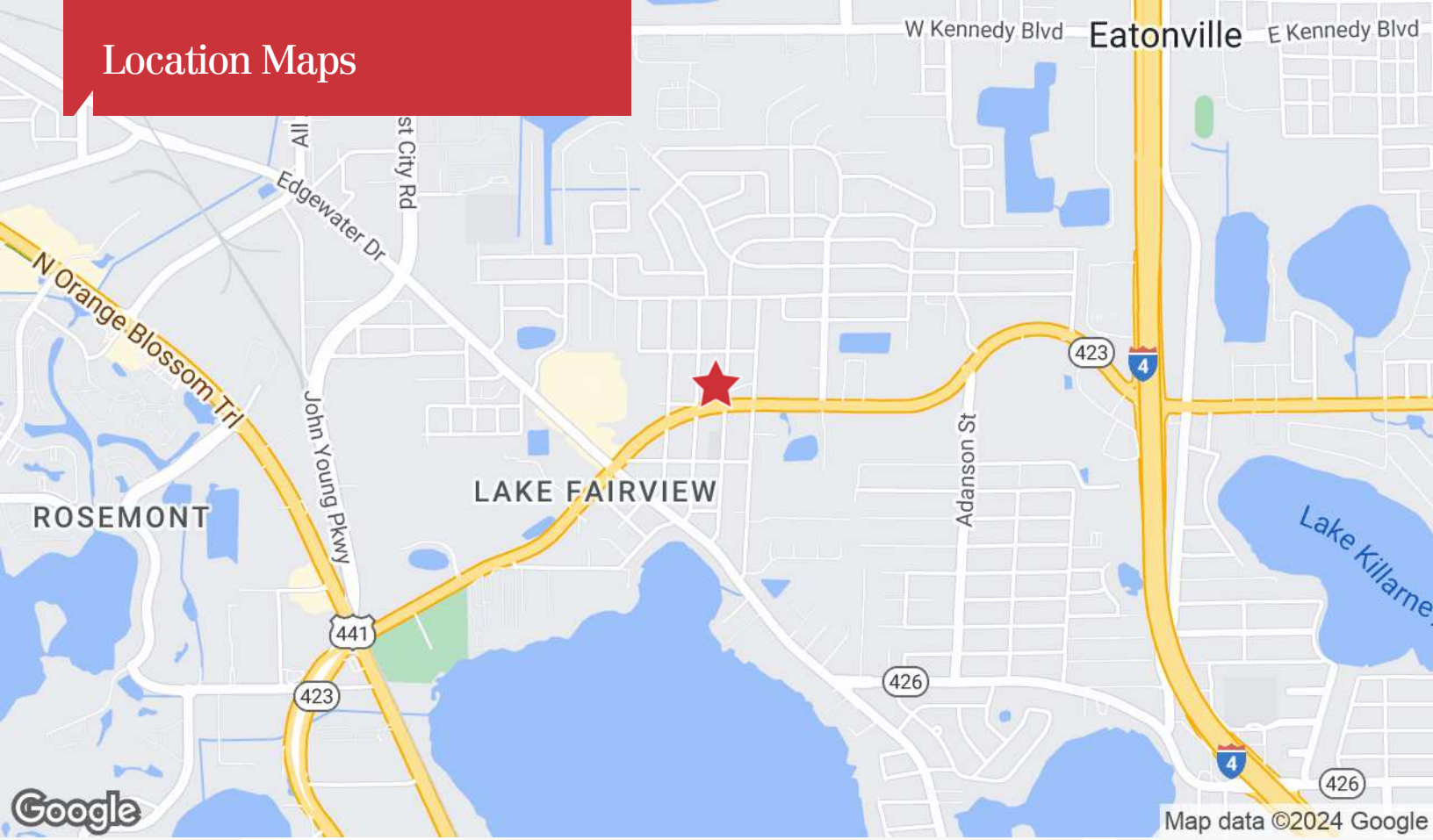

Demographics

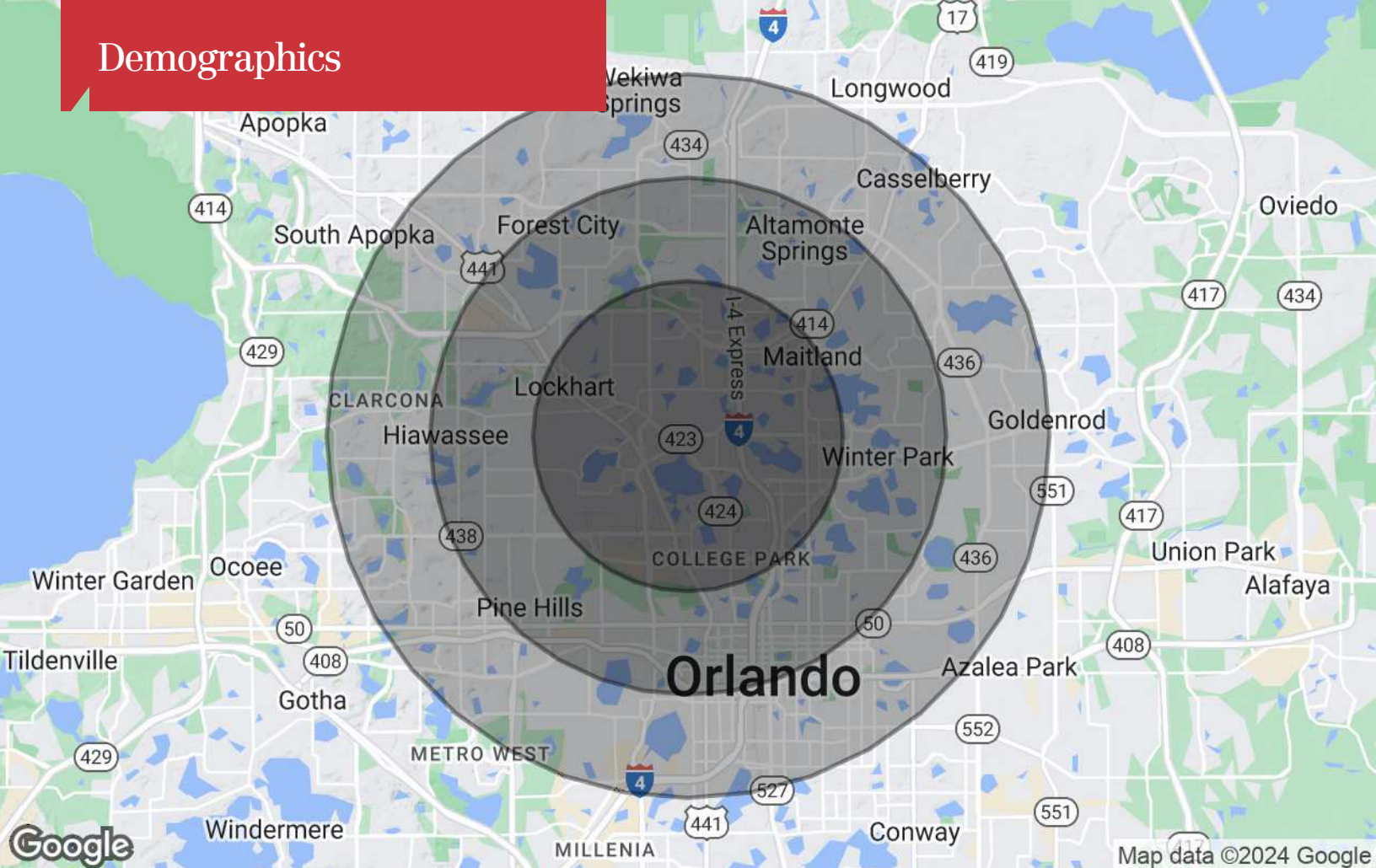

Population

	3 Miles	5 Miles	7 Miles
TOTAL POPULATION	90,732	281,948	546,399
MEDIAN AGE	40	40	40
MEDIAN AGE (MALE)	39	39	39
MEDIAN AGE (FEMALE)	41	41	41

Households & Income

	3 Miles	5 Miles	7 Miles
TOTAL HOUSEHOLDS	39,047	117,260	221,592
# OF PERSONS PER HH	2.3	2.4	2.5
AVERAGE HH INCOME	\$92,859	\$100,663	\$94,816
AVERAGE HOUSE VALUE	\$422,468	\$448,574	\$414,348

* Demographic data derived from 2020 ACS - US Census