

COLLIER PARK OF COMMERCE

PROFESSIONAL OFFICE



FOR LEASE

3050 HORSESHOE DRIVE, NAPLES, FL 34104



ON-SITE PROPERTY MANAGEMENT

CONTACT

DAVE WALLACE, CCIM, SIOR
Senior Vice President
239.659.1447 x218
dave.wallace@creconsultants.com

DAVID WALLACE
Senior Associate
239.659.1447 x223
david.wallace@creconsultants.com

12140 Carissa Commerce Ct, Suite 102
Fort Myers, FL 33966
1100 Fifth Ave. S, Suite 404
Naples, FL 34102

AVAILABLE:

BUILDING	UNIT	SIZE (SF)
B	231 <i>Available 7/31/2024</i>	4,444

LEASE RATE: Call for Rate

LOCATION: Located just north of Radio Road, adjacent to the Naples Municipal Airport. This property provides tenants with a central location, excellent accessibility and good visibility, with many amenities in the immediate area.

ZONING: BP - Business Park District (Collier County)

Collier Park of Commerce is owned and managed by the Adler Group, which owns and manages an extensive real estate portfolio of properties in the Southeast United States. Adler Group professionals possess a deep understanding of the CRE industry and are extremely responsive to their tenants' needs.

The information contained herein was obtained from sources believed reliable. CRE Consultants makes no guarantees, warranties or representations as to the completeness or accuracy thereof, and is subject to errors, omissions, change of price or conditions prior to sale or lease, or withdrawal without notice. 05/14/24

COLLIER PARK OF COMMERCE

PROFESSIONAL OFFICE



FOR LEASE

3050 HORSESHOE DRIVE, NAPLES, FL 34104

BUILDING 3050-A

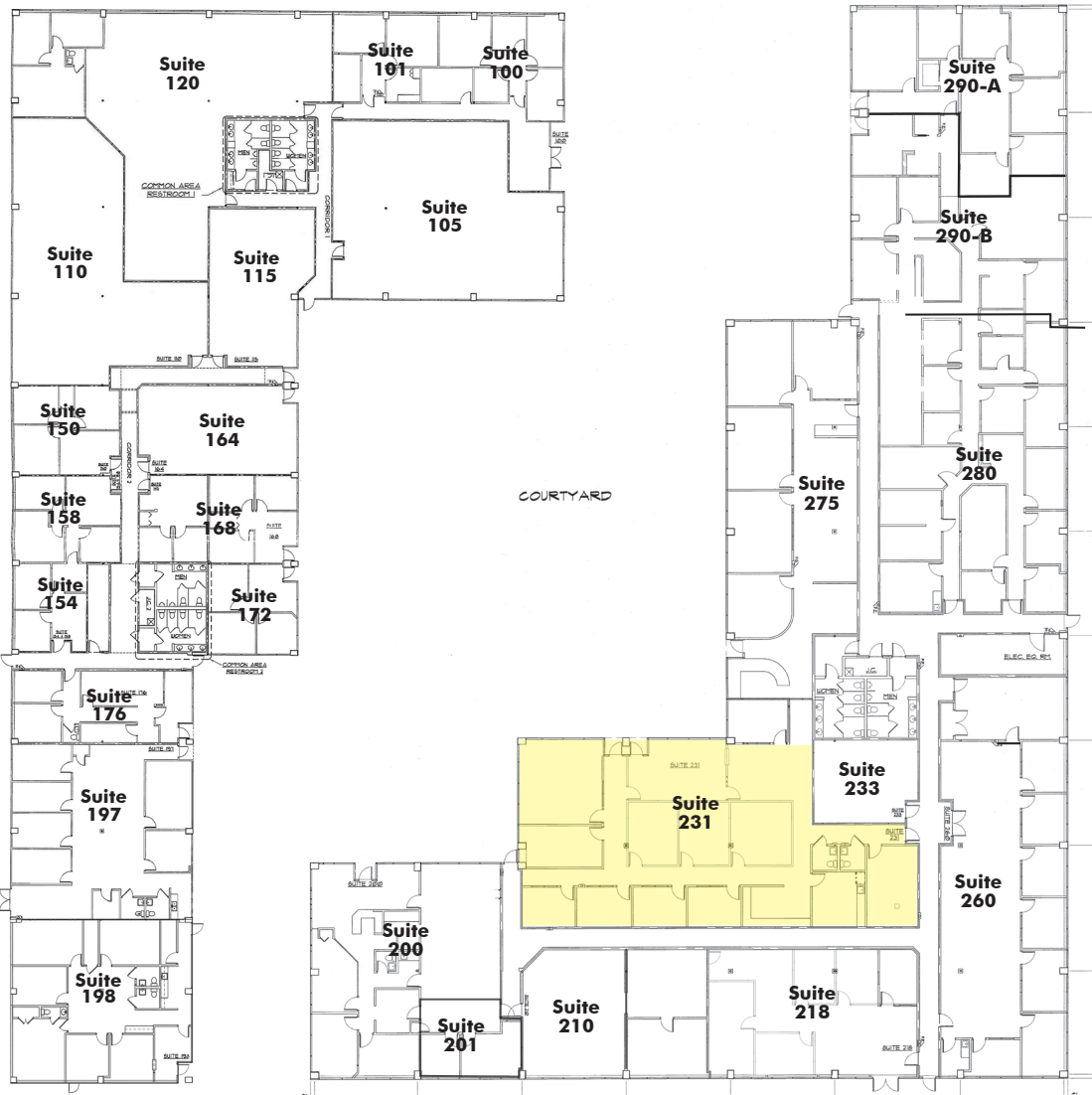

BUILDING 3050-B

AVAILABLE



HIGHLIGHTS

- Ample parking
- On-site property management
- Natural light and courtyard views
- Common restrooms in close proximity
- Space is move-in ready

CONTACT

DAVE WALLACE, CCIM, SIOR
 Senior Vice President
 239.659.1447 x218
 dave.wallace@creconsultants.com

DAVID WALLACE
 Senior Associate
 239.659.1447 x223
 david.wallace@creconsultants.com

The information contained herein was obtained from sources believed reliable. CRE Consultants makes no guarantees, warranties or representations as to the completeness or accuracy thereof, and is subject to errors, omissions, change of price or conditions prior to sale or lease, or withdrawal without notice.

FOR LEASE

3050 HORSESHOE DRIVE, NAPLES, FL 34104

SYNERGISTIC COMPANIES IN IMMEDIATE TRADE AREA



Collier County
Tax Department

Collier County
Growth Management

Collier County
Community Development

Collier Contractor
Licensing

Suncoast
Credit Union

- Salvation Army
- Southwest Florida Workforce Development
- Early Learning Coalition of SWFL
- Lutheran Services of Florida
- Blue Water Benefits Consulting

VA Clinic

Lighthouse of
Collier

HORSESHOE DR N

3050A
3050B

Naples Adventist
Christian School

HORSESHOE DR S

Mason Classical
Academy

Friends of
Foster Children

ENTERPRISE AVE

Paws Assistant
Dogs

Family Preservation
Case Management DCF

Windmill Creek
Academy

David Lawrence
Offices

National Park
Service

Quest for
Success

Cobham Slip
Rings

CONTACT
DAVE WALLACE, CCIM, SIOR
Senior Vice President
239.659.1447 x218
dave.wallace@creconsultants.com

DAVID WALLACE
Senior Associate
239.659.1447 x223
david.wallace@creconsultants.com

The information contained herein was obtained from sources believed reliable. CRE Consultants makes no guarantees, warranties or representations as to the completeness or accuracy thereof, and is subject to errors, omissions, change of price or conditions prior to sale or lease, or withdrawal without notice. 05/14/24