

# COMMERCIAL DEVELOPMENT SITE AVAILABLE



**COLDWELL BANKER  
COMMERCIAL**

PRIME  
PROPERTIES  
CBCWEST.COM

636 - 32 4/10 Road, Clifton, CO 81520

**FOR SALE**

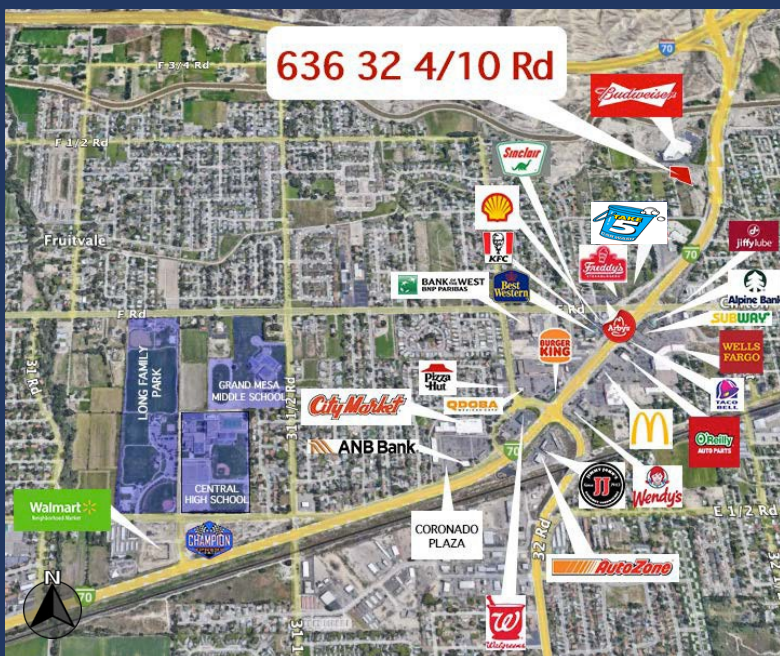

**ACRES:** 1.00 AC  
**ZONING:** Commercial C-2  
**PRICE:** \$785,000

- ✓ Located in Clifton's Prime Commercial Retail Area
- ✓ High Traffic Visibility from Primary Arterial Byways:
  - I-70 Business Loop = 27,000 VPD
  - Patterson Road (F Road) = 13,000 VPD
- ✓ Flexible Zoning allowing for Variety of Uses
- ✓ Sale - Ground Lease - Build To Suit
- ✓ Interstate Access and Roadside Visibility

All information herein is from sources deemed reliable. However, broker makes no warranties, express or implied, as to the accuracy of the information or to the suitability of this property for the investor.

**Mike Foster, CCIM | [mfooster@cbcwest.com](mailto:mfooster@cbcwest.com)**  
Coldwell Banker Commercial Prime Properties

**Direct:** 970-244-6602  
**Mobile:** 970-433-8374

131 N. 6th, St., Suite 200  
Grand Junction, CO 81501

**CBCWEST.COM**

©2022 Coldwell Banker Real Estate LLC, dba Coldwell Banker Commercial Affiliates. All rights reserved. Coldwell Banker Commercial® and the Coldwell Banker Commercial are registered service marks owned by Coldwell Banker Real Estate LLC. Coldwell Banker Real Estate LLC, dba Coldwell Banker Commercial Affiliates fully supports the principles of the Fair Housing Act and the Equal Opportunity Act. Each office is independently owned and operated.