



LEE & ASSOCIATES  
COMMERCIAL REAL ESTATE SERVICES



STONEMONT



**LEGACY  
AT ORIOLE**

**DOCK-HIGH WAREHOUSE SPACE**  
Up to 250,000 SF Available

16670 - 16680 ORIOLE ROAD, FORT MYERS, FLORIDA 33912



# SITE MAP

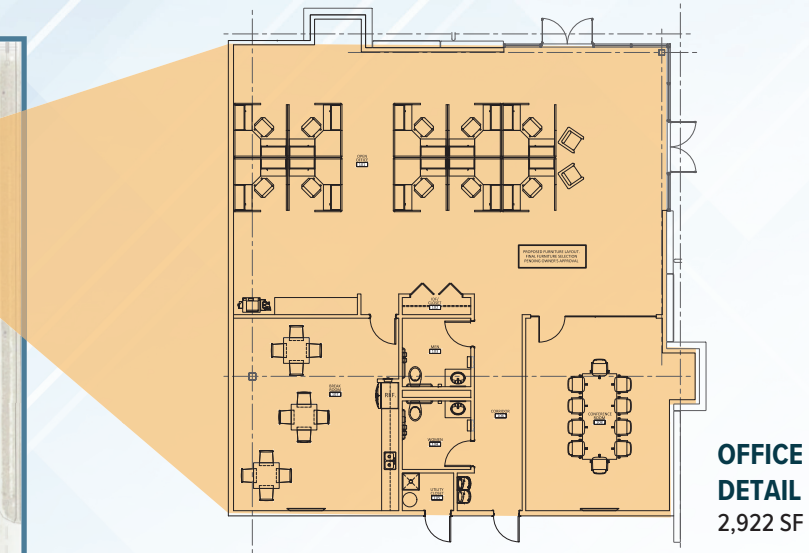
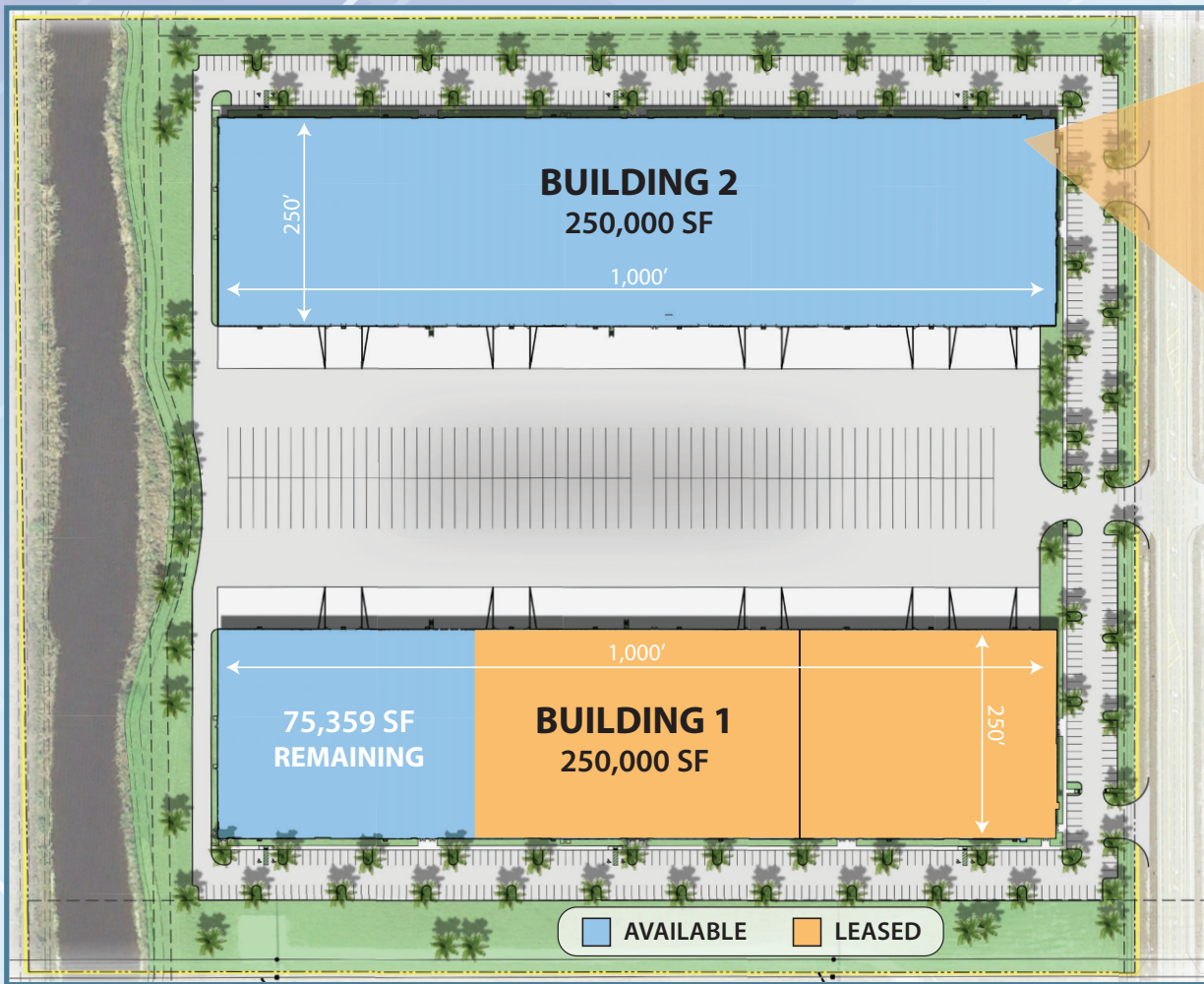

SPECIFICATIONS	BUILDING 1	BUILDING 2
OFFICE TO SUIT	Spec Office Planned	OFFICE TO SUIT 2,922 SF
BUILDING DEPTH	250'	BUILDING DEPTH 250'
COLUMN SPACING	50' x 50'	COLUMN SPACING 50' x 50'
CLEAR HEIGHT	32'	CLEAR HEIGHT 32'
DOCK DOORS	5 Dock Doors (9' x 10')	DOCK DOORS Up to 43 Dock Doors (9' x 10')
DRIVE - INS	2 Drive - In Doors (12' x 14')	DRIVE - INS 8 Drive - In Doors (12' x 14')
TRUCK COURT	180'	TRUCK COURT 180'
WAREHOUSE LIGHTING	LED	WAREHOUSE LIGHTING LED
FULLY SPRINKLERED	ESFR	FULLY SPRINKLERED ESFR
PARKING SPACES	280	PARKING SPACES 280
TRAILER PARKING SPACES	25	TRAILER PARKING SPACES 85



# CORPORATE NEIGHBORS





# SITE AERIALS

---







LEE & ASSOCIATES  
COMMERCIAL REAL ESTATE SERVICES



STONEMONT



## FOR LEASING INFORMATION PLEASE CONTACT:

---

**DEREK BORNHORST, SIOR, CCIM**

*PRINCIPAL*

239.210.7607

[dbornhorst@lee-associates.com](mailto:dbornhorst@lee-associates.com)

---

**BOB JOHNSTON, SIOR**

*PRINCIPAL*

239.210.7601

[bjohnston@lee-associates.com](mailto:bjohnston@lee-associates.com)

---

**JERRY MESSONNIER, SIOR**

*PRINCIPAL*

239.210.7610

[jmessonnier@lee-associates.com](mailto:jmessonnier@lee-associates.com)

**LEGACY  
AT ORIOLE**