

**F C** FIRST CAPITAL  
Property Group, Inc.  
**P G** Commercial Real Estate Services

**MAIN STREET  
SQUARE**



# RETAIL SPACE FOR LEASE

**7800 S US HWY 17-92, Fern Park, FL 32730**

Contact: Trey Gravenstein E: [Trey@FCPG.com](mailto:Trey@FCPG.com)  
Vice President of Brokerage Services P: 407.872.0177 ext 119

Contact: Michael Castrilli E: [Michael@FCPG.com](mailto:Michael@FCPG.com)  
Senior Sales & Leasing Associate P: 407.872.0177 ext 130

## For Lease: Negotiable, NNN

Suite 174: ± 1,050 SF | Available Immediately  
Suite 182: ± 1,400 SF | Available 6.01.2024

Located at signalized intersection off high traffic Hwy 17-92 with 50,500 AADT

Less than 0.7 miles south from Hwy 17-92 and SR 436 intersection (66,000 AADT on SR 436)

4 Points of access with cross access to Dunkin Donuts, Baskin Robbins and Advanced Auto Parts

Building façade and large elevated marquee signage facing Hwy 17-92 available

Direct site lines to Hwy 17-92 with over 400' of frontage

Winn-Dixie remodeled in 2012 with focused departments to better service the local demographic

## JOIN THESE RETAILERS!

615 E. Colonial Drive, Orlando, FL 32803 Phone: 407.872.0209 www.FCPG.com

Information furnished regarding the subject property is believed to be accurate, but no guarantee or representation is made. References to square footage are approximate. This offering is subject to errors, omissions, prior sale or lease or withdrawal without notice. ©2024 First Capital Property Group, Inc., Licensed Real Estate Brokers & Managers.





**50,500**  
AADT ON HWY 17-92

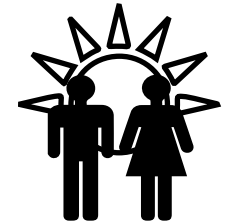

**413,927**  
DAYTIME POPULATION  
WITHIN 15 MINS

## DEMOGRAPHICS

**2023**

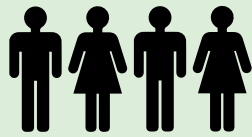

Total Population

18,000



Total Households

7,900



Average HH Income

\$98,430

**5 Min**

134,522

59,165

\$91,720

**10 Mins**

348,399

148,136

\$99,840

**15 Mins**

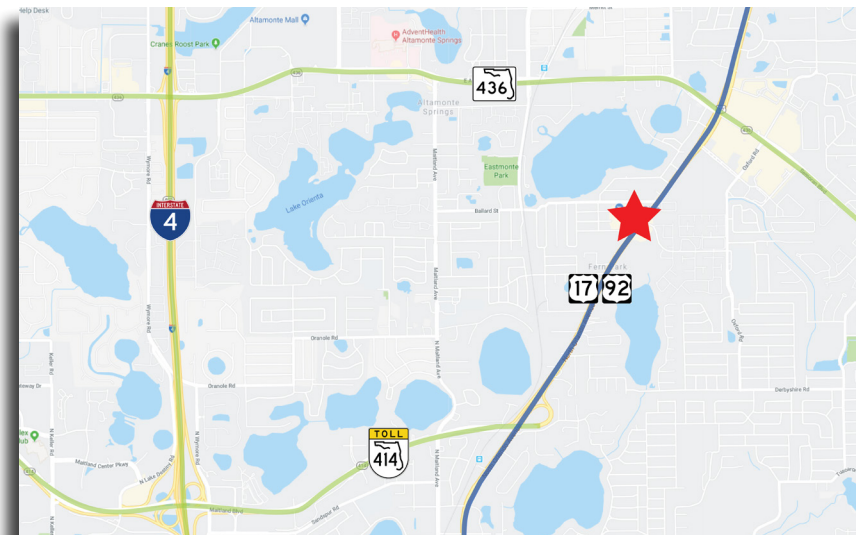

615 E. Colonial Drive, Orlando, FL 32803 Phone: 407.872.0209 www.FCPG.com

Information furnished regarding the subject property is believed to be accurate, but no guarantee or representation is made. References to square footage are approximate. This offering is subject to errors, omissions, prior sale or lease or withdrawal without notice. ©2024 First Capital Property Group, Inc., Licensed Real Estate Brokers & Managers.







## AVAILABILITY

Suite 174: ± 1,050 SF

Suite 182: ± 1,400 SF

■ 615 E. Colonial Drive, Orlando, FL 32803 ■ Phone: 407.872.0209 ■ [www.FCPG.com](http://www.FCPG.com) ■

Information furnished regarding the subject property is believed to be accurate, but no guarantee or representation is made. References to square footage are approximate. This offering is subject to errors, omissions, prior sale or lease or withdrawal without notice. ©2024 First Capital Property Group, Inc., Licensed Real Estate Brokers & Managers.



# THE NEIGHBORHOOD



■ 615 E. Colonial Drive, Orlando, FL 32803 ■ Phone: 407.872.0209 ■ [www.FCPG.com](http://www.FCPG.com) ■

Information furnished regarding the subject property is believed to be accurate, but no guarantee or representation is made. References to square footage are approximate. This offering is subject to errors, omissions, prior sale or lease or withdrawal without notice. ©2024 First Capital Property Group, Inc., Licensed Real Estate Brokers & Managers.



# SUITES 174

## SUITE 174

± 1,050 SF

Dimensions: ± 15' x ± 70'

Bathrooms: 1 (± 5'6" x ± 5' 9")

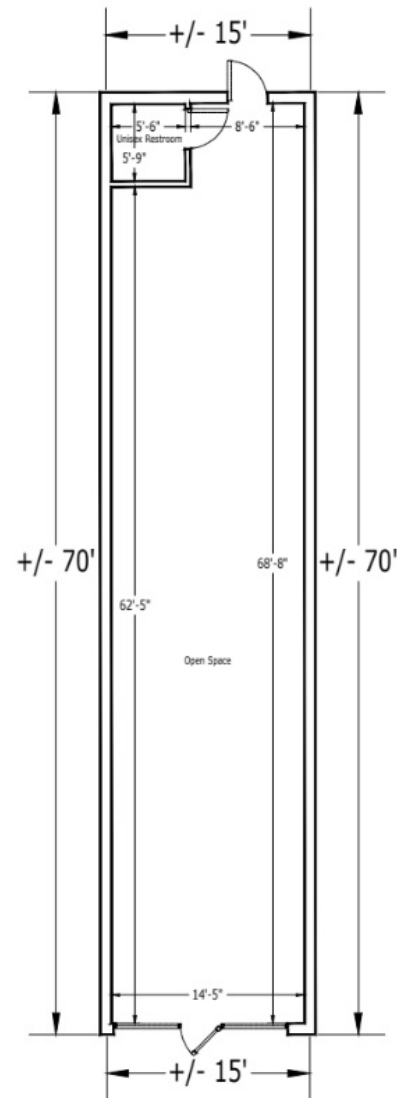

■ 615 E. Colonial Drive, Orlando, FL 32803 ■ Phone: 407.872.0209 ■ [www.FCPG.com](http://www.FCPG.com) ■

Information furnished regarding the subject property is believed to be accurate, but no guarantee or representation is made. References to square footage are approximate. This offering is subject to errors, omissions, prior sale or lease or withdrawal without notice. ©2024 First Capital Property Group, Inc., Licensed Real Estate Brokers & Managers.