

For Lease

±2,841 SF

Medical Office Space  
near JFK Medical



4889 South Congress Avenue Lake Worth, FL 33461

**RECENTLY UPGRADED BUILDING  
UNDER NEW OWNERSHIP!**

Additional Parking Now Available

### Property Features

- 2-story freestanding building in a convenient, highly visible location with ample parking
- Second floor, built-out medical space with immediate availability and ADA elevator
- Possible signage opportunities
- Just south of Lake Worth Road, with easy access to main arterial roads and numerous dining/shopping options

### Key Features:



Just ½ mile north of  
JFK Medical Center



Highly visible location  
with possible signage



Brand new spec suite with  
immediate availability

**Lesley Sheinberg**

Managing Director | lsheinberg@mhcreal.com

**Barbara LeBrun, SIOR**

Managing Director | blebrun@mhcreal.com

**Julia Piatek**

Associate & Transaction Coordinator | jpiatek@mhcreal.com



FOR LEASE: 4889 S CONGRESS AVENUE, LAKE WORTH

# Medical Office Space Near JFK Medical Center

## Suite 202 2,841 SF

- Fantastic suite with a reception and waiting area
- 1 office
- 3 exam rooms
- Nurse's station
- 2 private restrooms
- Coffee/Breakroom
- Storage closet
- Can be combined with Suite 201 for a maximum size of 4,836 SF

### Rate:

\$22.50/SF NNN  
\$11.50/SF CAM

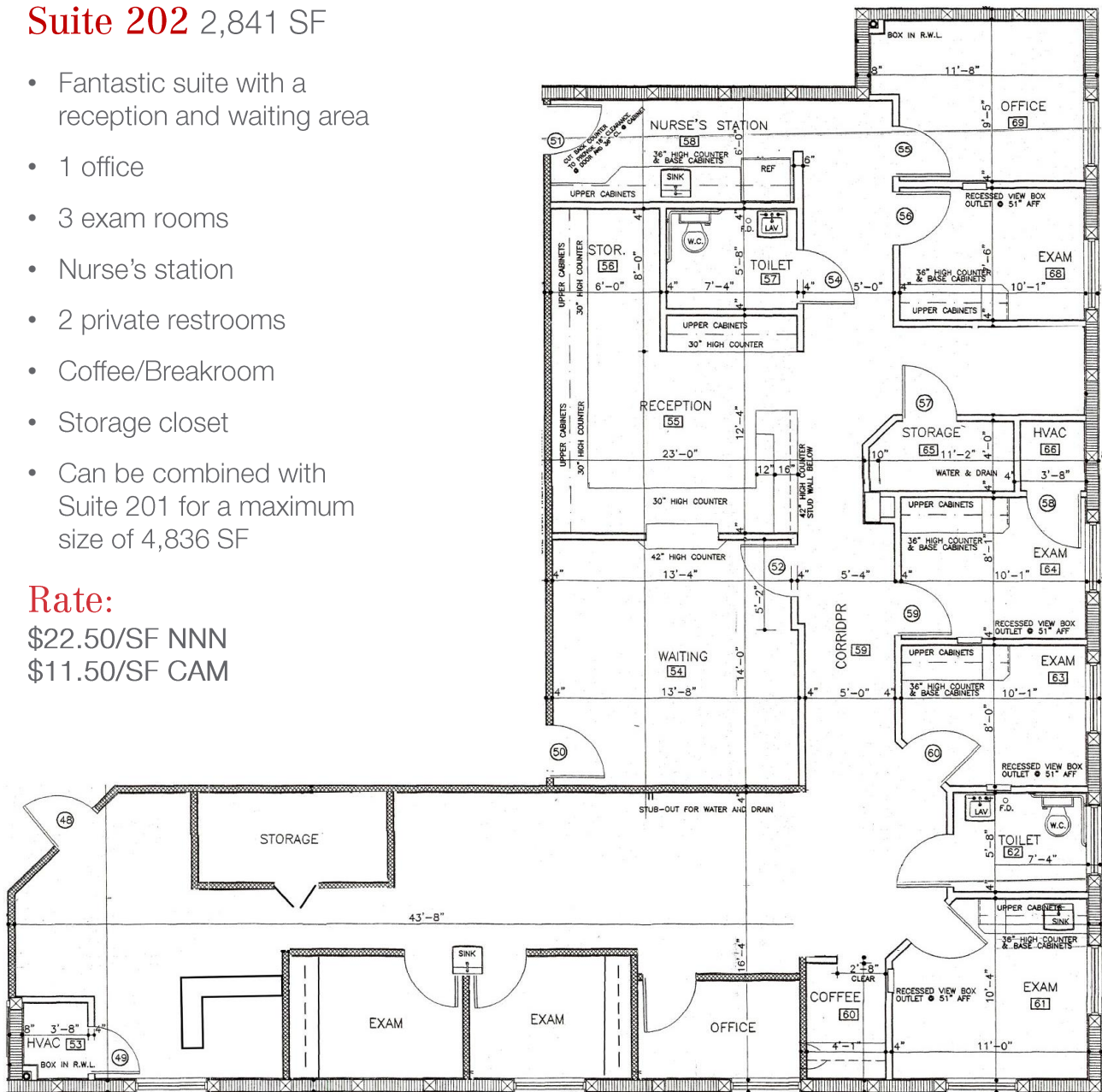

\*Not to scale. Subject to error.

**Lesley Sheinberg**

Managing Director | lsheinberg@mhcreal.com

**Julia Piatek**

Associate & Transaction Coordinator | jpiatek@mhcreal.com

**Barbara LeBrun, SIOR**

Managing Director | blebrun@mhcreal.com

