

# RESIDENTIAL DEVELOPMENT OPPORTUNITY

2095 N Miller Run Terrace, Crystal River, FL 34428

Contact: Austin McWilliams  
 Senior Sales & Leasing Associate

E: Austin@FCPG.com  
 P: 407.872.0177 ext. 134

Contact: Jesse King  
 Sales & Leasing Associate

E: Jesse@FCPG.com  
 P: 407.872.0177 ext. 136

## For Sale: Inquire for Price

3.3 Acre Residential Site

Parcel ID: 17E18S24 22200



Visit [FCPG.com/Crystal\\_River](https://www.fcpg.com/Crystal_River)  
 For a Development  
 Highlight Video



3.3-acre Residential Site with PUD Entitlements for 56-unit Multifamily Development. Zoning and Site Plan Approval in-place for seven 8-plex units

High Density Residential zoning with PUD overlay allows for short and long term rentals

Local municipality dynamic provides potential for lower density Townhome project

Ideally situated within 1 mile of access to new Hwy 589 Roadway Extension to be completed by 2026

Strategically located within 5 minutes of Target, Publix, Walmart Supercenter, new YMCA, and additional regional and national retailers

Historical development plans upon request

Located in fast-growing Citrus County with thousands of single family homes and townhomes within a 5 mile radius

\*Engineering, Entitlements & Permits for above sample rendering

615 E. Colonial Dr., Orlando, FL 32803 Phone: 407.872.0209 Fax: 407.426.8542

Information furnished regarding the subject property is believed to be accurate, but no guarantee or representation is made. References to square footage are approximate. This offering is subject to errors, omissions, prior sale or lease or withdrawal without notice. ©2024 First Capital Property Group, Inc., Licensed Real Estate Brokers & Managers.

# PROPOSED DEVELOPMENT PLAN

## LANDSCAPING OVERVIEW

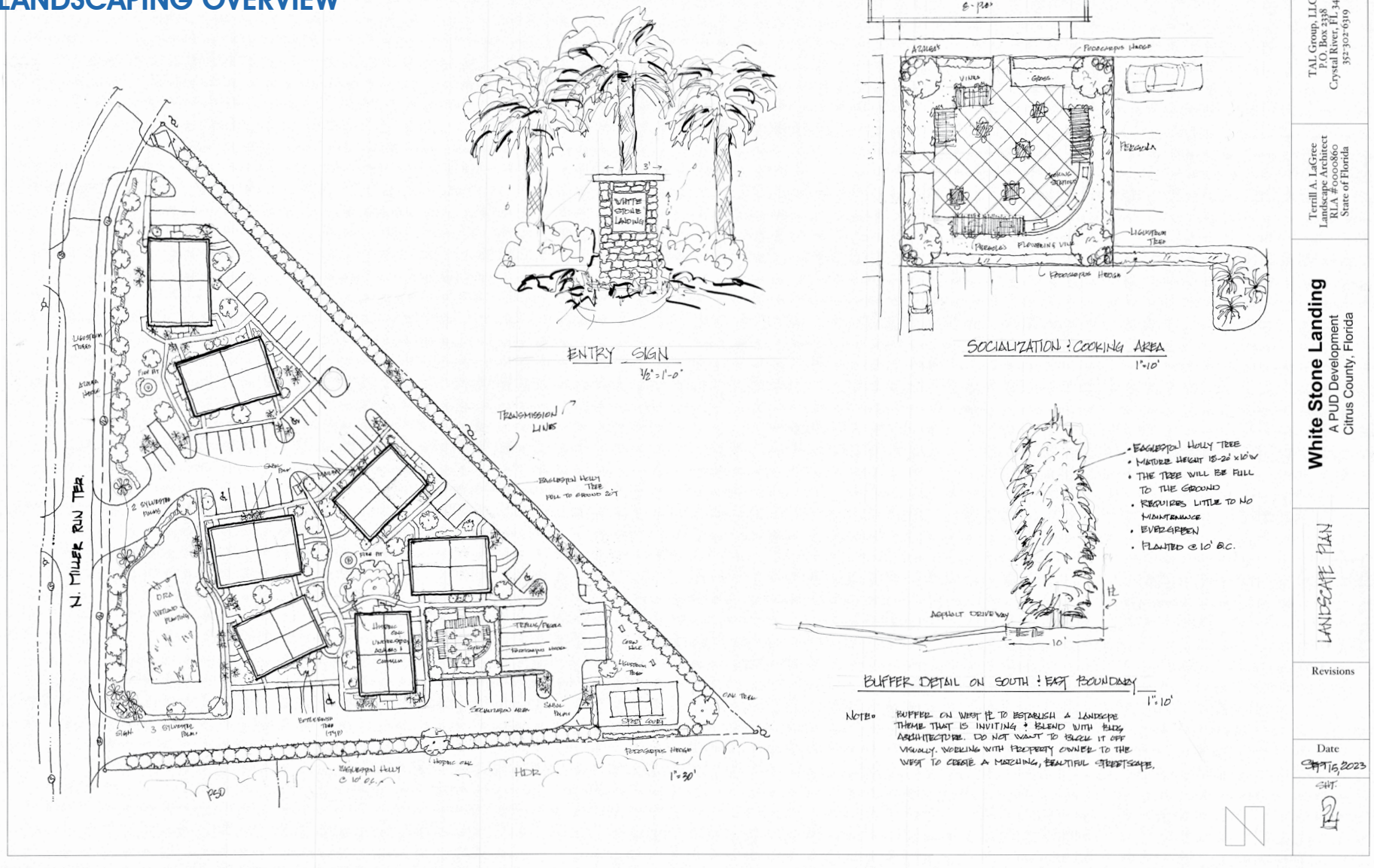

TAL Group, LLC  
P.O. Box 2338  
Crystal River, FL 34423  
352-302-6310

Terrill A. LaGree  
Landscape Architect  
RLA #000860  
State of Florida

615 E. Colonial Dr., Orlando, FL 32803 Phone: 407.872.0209 Fax: 407.426.8542

Information furnished regarding the subject property is believed to be accurate, but no guarantee or representation is made. References to square footage are approximate. This offering is subject to errors, omissions, prior sale or lease or withdrawal without notice. ©2024 First Capital Property Group, Inc., Licensed Real Estate Brokers & Managers.

**FIRST CAPITAL**  
Property Group, Inc.  
Commercial Real Estate Services

# SURROUNDING AREA



■ 615 E. Colonial Dr., Orlando, FL 32803 ■ Phone: 407.872.0209 ■ Fax: 407.426.8542 ■

Information furnished regarding the subject property is believed to be accurate, but no guarantee or representation is made. References to square footage are approximate. This offering is subject to errors, omissions, prior sale or lease or withdrawal without notice. ©2024 First Capital Property Group, Inc., Licensed Real Estate Brokers & Managers.

# LOCATION

## Drive Times & Traffic Counts



2 minutes  
(0.8 miles)

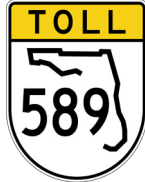

Current: 8 mins / 4.3 miles  
Future: 2 mins / 0.9 miles



8 minutes  
(3.2 miles)



16 minutes  
(10.2 miles)



43 minutes  
(31.0 miles)

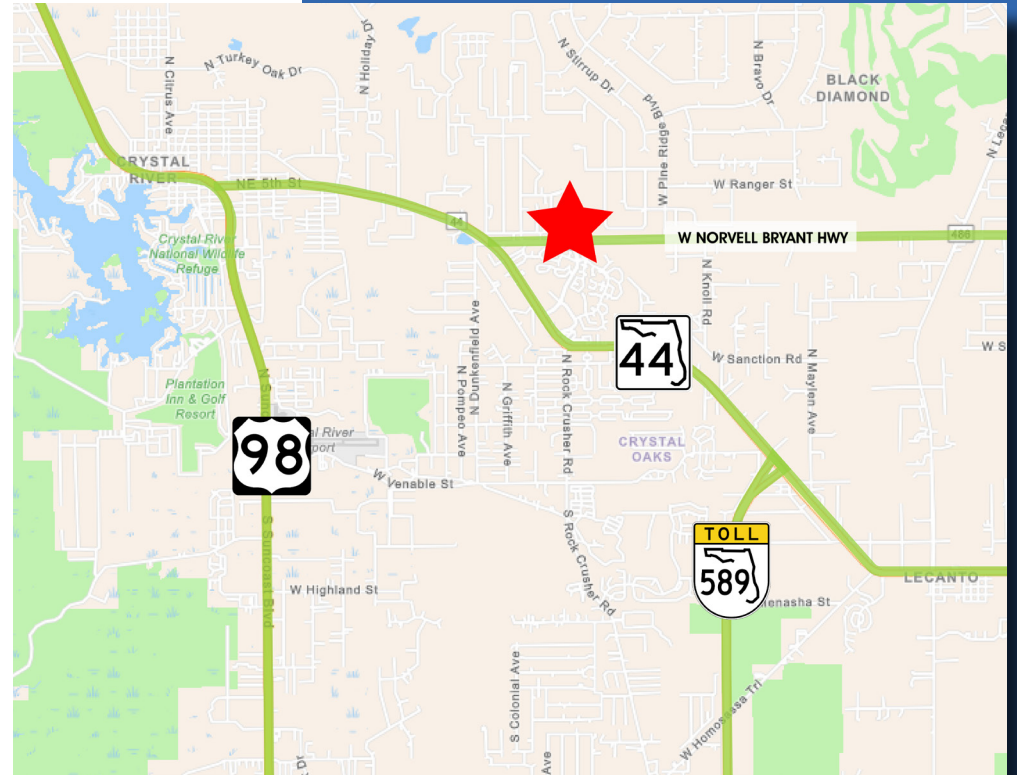

## Average Annual Daily Trips

### 2022

W Norvell Bryant Hwy	13,000
State Road 44	31,500
N Suncoast Blvd / Toll Road 589	27,500

## Surrounding Businesses

### 2023

	5 Mins	10 Mins	15 Mins
Retail Businesses	42	192	319
Food & Drink Businesses	12	78	122

615 E. Colonial Dr., Orlando, FL 32803 Phone: 407.872.0209 Fax: 407.426.8542

Information furnished regarding the subject property is believed to be accurate, but no guarantee or representation is made. References to square footage are approximate. This offering is subject to errors, omissions, prior sale or lease or withdrawal without notice. ©2024 First Capital Property Group, Inc., Licensed Real Estate Brokers & Managers.

# DEMOGRAPHICS



**EMPLOYMENT  
POPULATION**  
± 12,553  
(10 min drive time)



**MEDIAN AGE**  
59.7  
(10 min drive time)

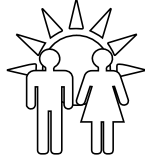

**DAYTIME  
POPULATION**  
29,647  
(10 min drive time)



Total Population



Total Families



Total Households



Average  
Income

		Total Population	Total Families	Total Households	Average Income
5 mins	2023	3,397	969	1,635	\$62,948
10 mins	2023	25,161	6,919	11,149	\$72,660
15 mins	2023	61,716	17,551	27,310	\$72,859



■ 615 E. Colonial Dr., Orlando, FL 32803 ■ Phone: 407.872.0209 ■ Fax: 407.426.8542 ■

Information furnished regarding the subject property is believed to be accurate, but no guarantee or representation is made. References to square footage are approximate. This offering is subject to errors, omissions, prior sale or lease or withdrawal without notice. ©2024 First Capital Property Group, Inc., Licensed Real Estate Brokers & Managers.

