



CHANCELLOR DR.

7552 CHANCELLOR DRIVE | SUITE 100

±25,500 RSF AVAILABLE FOR LEASE



±25,500 AVAILABLE FOR LEASE

7552 CHANCELLOR DR. | ORLANDO, FL

PROPERTY MAP

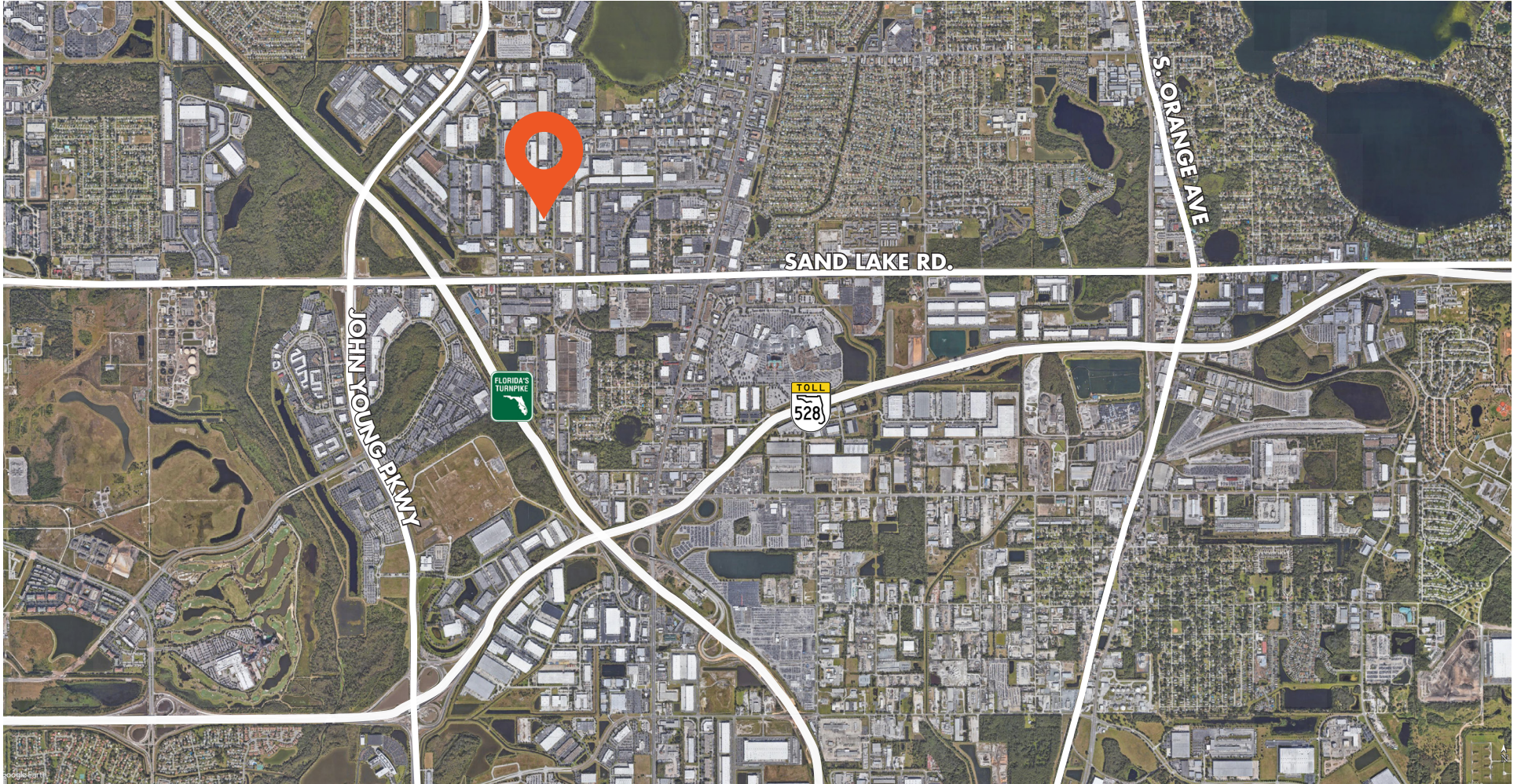

FOR MORE INFORMATION, PLEASE CONTACT:

JOEY WOODMAN | **407.748.5888**

Vice President

Joey.Woodman@foundrycommercial.com

Licensed Real Estate Broker

JUSTIN RUBY, SIOR, CCIM | **407.865.0311**

Partner

Justin.Ruby@foundrycommercial.com

Licensed Real Estate Broker

EASTGROUP
PROPERTIES

FOUNDRY
COMMERCIAL

Although the information contained herein was provided by sources believed to be reliable, Foundry Commercial makes no representation, expressed or implied, as to its accuracy and said information is subject to errors, omissions or changes.

foundrycommercial.com

±25,500 AVAILABLE FOR LEASE

7552 CHANCELLOR DR. | ORLANDO, FL

INDUSTRIAL WAREHOUSE FOR LEASE

LOCATION OVERVIEW

Situated in the highly sought-after Orlando Central Park, this property is located off of Chancellor Drive near the intersection of Sand Lake Rd and Orange Blossom Trail. This building offers excellent access to serve the Central Florida market with close proximity to I-4 and Florida's Turnpike.

PROPERTY FEATURES

- Newly renovated office space
- Drive-in ramp door
- Convenient roadway access

BUILDING FEATURES

AVAILABLE SF	± 25,500 SF
OFFICE	± 1,263 SF
LOADING	Front
DOCK-HIGH DOORS	5
RAMP DOORS	1
ZONING	I-P
CLEAR HEIGHT	26'
PARKING RATIO	1.25/1,000
AVAILABLE	Q2 2024

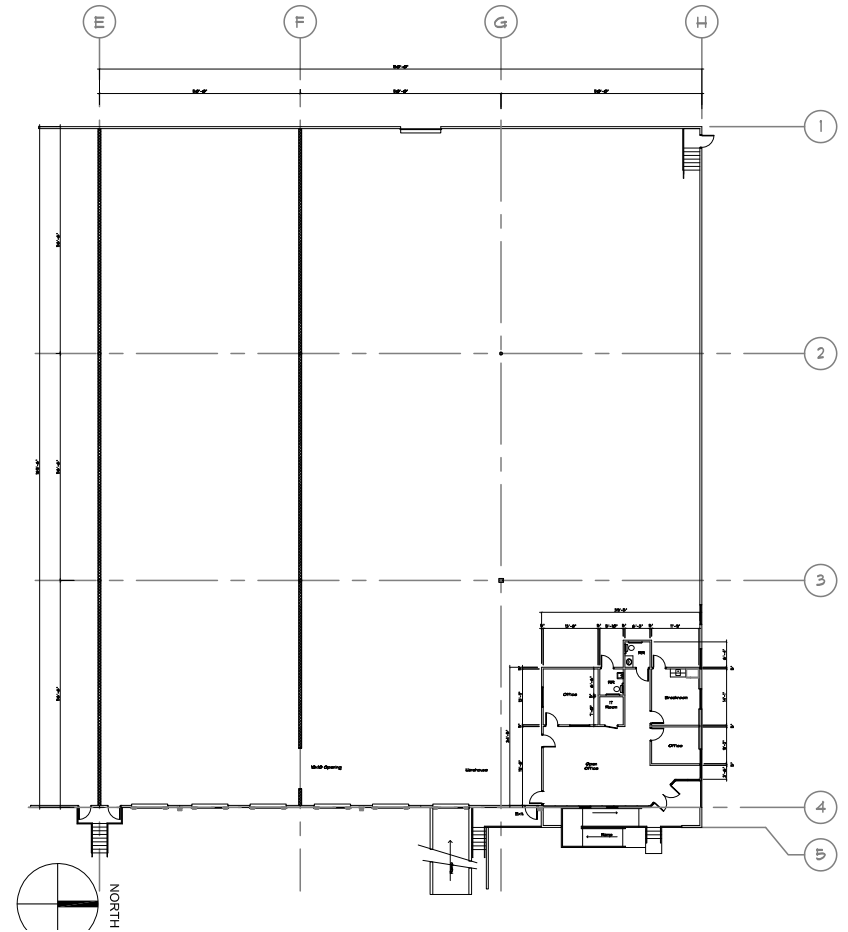

FOR MORE INFORMATION, PLEASE CONTACT:

JOEY WOODMAN | 407.748.5888
Vice President
Joey.Woodman@foundrycommercial.com
Licensed Real Estate Broker

JUSTIN RUBY, SIOR, CCIM | 407.865.0311
Partner
Justin.Ruby@foundrycommercial.com
Licensed Real Estate Broker

EASTGROUP
PROPERTIES

FOUNDRY
COMMERCIAL

Although the information contained herein was provided by sources believed to be reliable, Foundry Commercial makes no representation, expressed or implied, as to its accuracy and said information is subject to errors, omissions or changes.

foundrycommercial.com