

FOR LEASE

Owned and Operated by



LeeVista Business Center - Bldg G

7455 Emerald Dunes Drive, Orlando, FL 32822

27,842 SF



**LEASING INFO
& CONTACT**

Tim Perry, CCIM, SIOR

321.281.8515 / tperry@lee-associates.com

Bo Bradford, CCIM, SIOR

321.281.8502 / bbradford@lee-associates.com



This is not an offer or acceptance of an offer to lease space. A lease will only be offered or made in a written agreement signed by landlord. No representation or warranty of any kind is made by landlord unless set forth in a written definitive lease executed by the landlord.

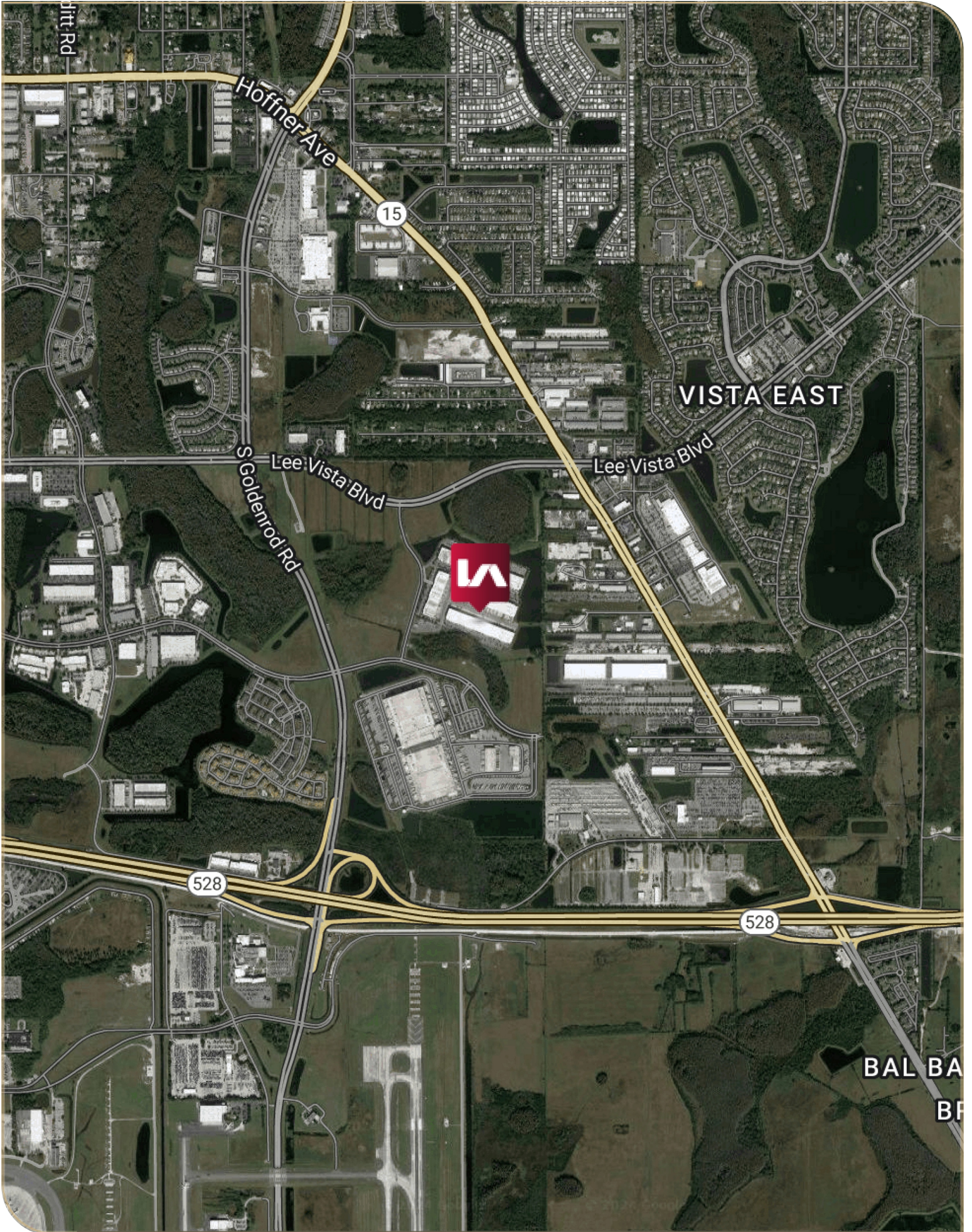

Jitt Rd

Hoffner Ave

15

VISTA EAST

S Goldenrod Rd

Lee Vista Blvd

Lee Vista Blvd



528

528

BAL BA
BF

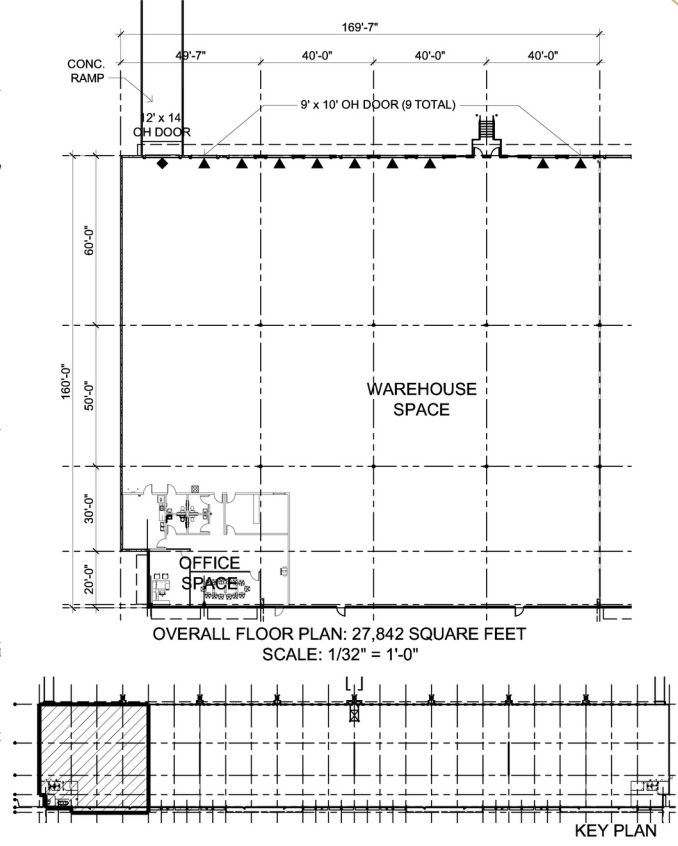
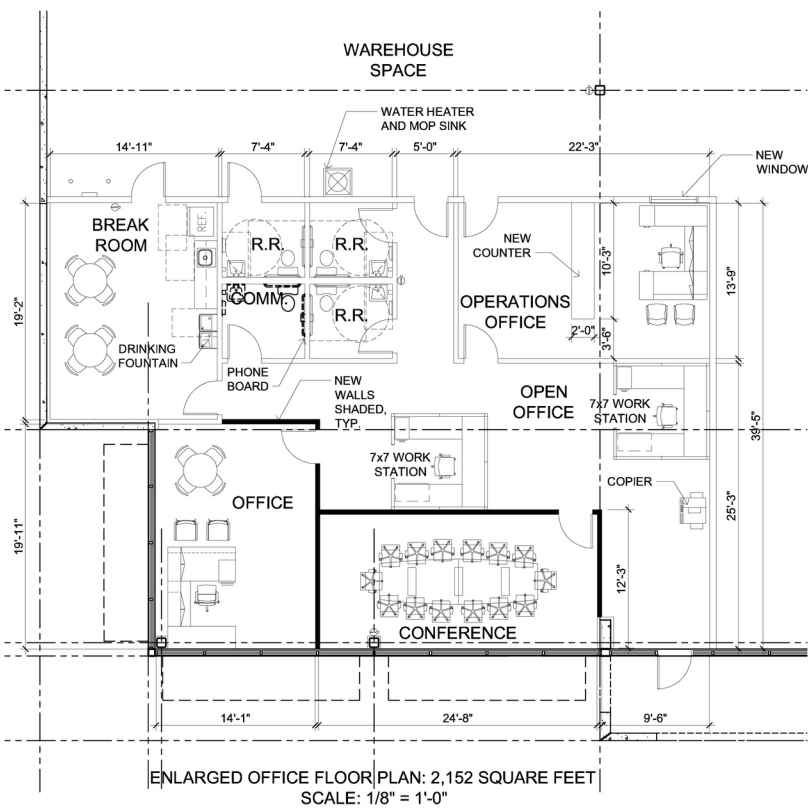

BUILDING DATA

Building SF:	159,884 SF
Clear Height:	30'
Column Spacing:	40' W x 50' D
Building Depth:	160'
Truck Court:	200' including a 60' concrete apron
Available:	October 1, 2024

LISTING DATA

Available SF:	27,842 SF
Office SF:	2,152 SF
Doors:	Nine (9) Dock Doors One (1) Oversized (12' x 14') door with ramp to grade level
Lease Rate:	\$11.95/SF NNN
Op Ex:	\$3.17/SF