

VICINITY MAP  
(NOT TO SCALE)

**LEGAL DESCRIPTION:**

POB IS 34 FEET EAST AND 196.75 FEET SOUTH 00°40' EAST FROM THE QUARTER CORNER ON THE WEST LINE OF SECTION 23, T6S,R7E; THENCE NORTH 00°40' WEST 108.00 FEET; THENCE NORTH 89°20' EAST 195 FEET; THENCE SOUTH 00°40' EAST 108.00 FEET; THENCE SOUTH 89°20' WEST 195.00 FEET BACK TO THE POB, ALL AS PER SURVEY OF GILBERT SULLIVAN, RLS, DATED 2/18/00.

DOCAR SALES

- NOTES:**
1. THIS SURVEY IS VALID ONLY IF THE DRAWING INCLUDES THE SEAL AND SIGNATURE OF THE SURVEYOR.
  2. BASIS OF BEARINGS: PLAT BY GILBERT SULLIVAN, RLS, DATED 2/18/00.
  3. THIS PLAT REPRESENTS AN ALTA/ACSM LAND TITLE SURVEY OF A PARCEL OF LAND AS INDICATED IN A MORTGAGE DEED FILED IN BOOK 879, PAGE 771 IN THE CLERK OF COURT'S OFFICE OF THE TANGIPAHOA PARISH RECORDS.
  3. THIS SURVEY MEETS CURRENT MINIMUM STANDARDS FOR PROPERTY BOUNDARY SURVEYS AND PLATS FOR THE STATE OF LOUISIANA.
  4. THIS PROPERTY IS SUBJECT TO ALL EASEMENTS, RIGHTS-OF-WAY, OR RESTRICTIONS, OF RECORD, KNOWN OR UNKNOWN.
  5. THIS PLAT IS CERTIFIED ONLY TO THOSE LISTED IN THE CERTIFICATION AND IS NOT TRANSFERABLE TO ANY ADDITIONAL INSTITUTIONS OR SUBSEQUENT OWNERS.
  6. NO EXCAVATION WAS PERFORMED TO DETERMINE THE EXACT LOCATION OF UNDERGROUND UTILITIES. THEREFORE ALL UTILITY LOCATIONS SHOWN HEREON ARE APPROXIMATE AND WERE LOCATED BY SURVEY FIELD CREW AS PER VISIBLE SIGHTING.
  7. THERE WERE NO VISIBLE EVIDENCE NOTED OF A SOLID WASTE DUMP, SUMP OR SANITARY LANDFILL.
  8. NO ENCROACHMENTS WERE OBSERVED.
  9. THE DITCH ACROSS THE NORTH SIDE OF THE PROPERTY IS NO LONGER EXISTING.

**SURVEYOR'S CERTIFICATION TO:**

- 1) SunTrust Bank, ITS SUCCESSORS AND/OR ASSIGNS
  - 2) Orleans Title Insurance Agency, L.L.C.
  - 3) First American Title Insurance Company of Louisiana
  - 4) JDM Louisiana, LLC
  - 5) Gray Robinson, P.A.
- THIS IS TO CERTIFY THAT THIS MAP OR PLAT AND THE SURVEY ON WHICH IT IS BASED WERE MADE IN ACCORDANCE WITH THE 2011 MINIMUM STANDARD REQUIREMENTS FOR ALTA/ACSM LAND TITLE SURVEYS, JOINTLY ESTABLISHED AND ADOPTED BY ALTA AND NSPS, AND INCLUDES ITEMS 1-4, 6a, 7-8, 11a, 13, 16-19 AND 21 OF TABLE A THEREOF. THE FIELD WORK WAS COMPLETED ON DECEMBER 14, 2015.

DATE OF PLAT OR MAP: 12/20/2015 MICHAEL E. JAMES, RLS #4480

**SURVEYOR'S CERTIFICATION:**

I HEREBY CERTIFY THAT THE HEREON PLATTED AND DESCRIBED SURVEY REPRESENTS THE PROPERTY DESCRIBED IN SCHEDULE A OF THE TITLE COMMITMENT, FILE NO. 6658.3 DATED JANUARY 4, 2016 AND WAS COMPLETED AND MONUMENTS WERE FOUND OR SET AS SHOWN ON DECEMBER 20, 2015.

01/29/16

MICHAEL E. JAMES, RLS #4480 DATE

**FLOOD CERTIFICATION:**  
THIS PROPERTY IS LOCATED ENTIRELY WITHIN FLOOD ZONE AE, A PRESENTLY ESTABLISHED 100-YEAR FLOOD PLAIN, AS DETERMINED BY THE NATIONAL FLOOD INSURANCE PROGRAM, FLOOD INSURANCE RATE MAP FOR TANGIPAHOA PARISH, LOUISIANA AND INCORPORATED AREAS, MAP NUMBER: 2210500340 F. EFFECTIVE DATE: JULY 22, 2010.

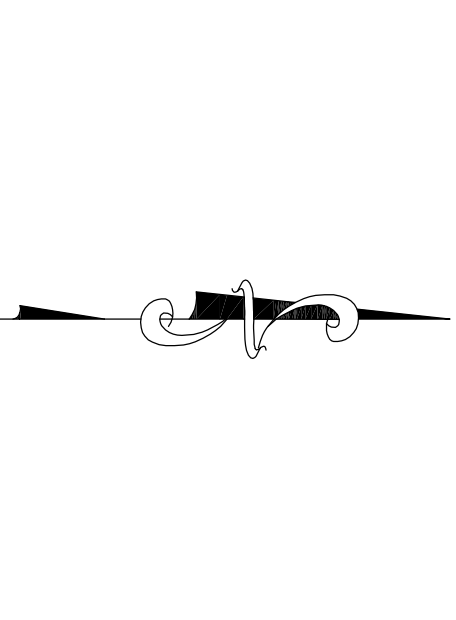

**LEGEND**

- These standard symbols may be found in the drawing.
- ⌘ FOUND PIPE
  - FOUND IRON PIN
  - SET IRON PIN
  - △ FOUND RAILROAD SPIKE
  - ⊙ WATER METER
  - ⊙ GAS METER
  - ⊙ POWER POLE
  - ⊙ SEWER MANHOLE
  - ⊙ TELEPHONE PEDESTAL
  - ⊙ SEWER CLEANOUT
  - ⊙ CABLE
  - ⊙ ELECTRIC METER
  - ⊙ STORM DRAIN
  - ⊙ COMPUTED POINT
  - ⊙ LIGHT POLE
  - ⊙ OVERHEAD POWERLINE

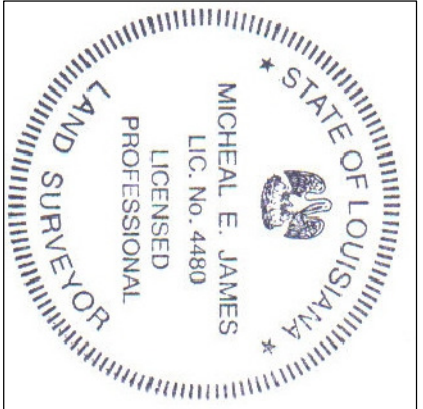

|  |                         |
|--|-------------------------|
| ZONING: CN - COMMERCIAL NEIGHBORHOOD       |                         |
| <b>ALTA SURVEY</b>                         |                         |
| <b>FOR</b>                                 |                         |
| <b>JDM LOUISIANA, LLC</b>                  |                         |
| PART OF THE SW1/4                          |                         |
| SECTION 23, TOWNSHIP 6 SOUTH, RANGE 7 EAST |                         |
| HAMMOND, LOUISIANA                         |                         |
| BICKFORD SURVEYS, LLC                      | DATE: JANUARY 29, 2016. |
| P.O. Box 29                                | SCALE: 1" = 40'         |
| PONCHATOULA, LA 70454                      | JOB NUMBER: 15002L      |
| 985-635-7910                               | FILE NAME: 15002L.DWG   |