

603 Central Florida Parkway

603 Central Florida Parkway, Orlando, Florida 32824

FOR LEASE

UP TO 20,000 SF SPACE
AND 1.5 AC INDUSTRIAL YARD



RAIL LINE

CENTRAL FLORIDA PARKWAY



CUSHMAN &
WAKEFIELD

603 Central Florida Parkway

603 Central Florida Parkway, Orlando, Florida 32824

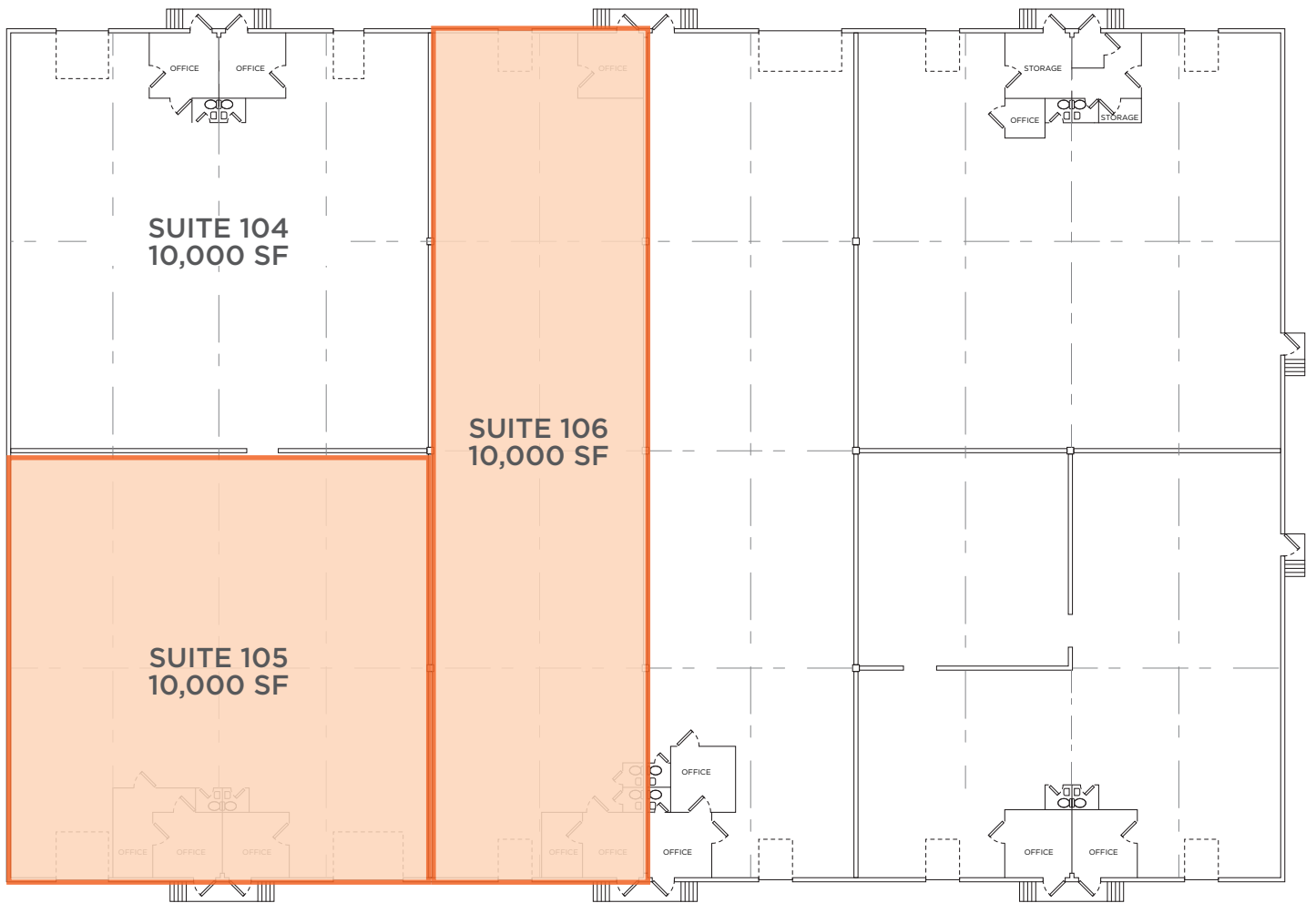

SPACE HIGHLIGHTS

\$14.50/SF NNN
ASKING RATE

\$4.73 PSF
OPEX*

3-PHASE
POWER

UP TO 20,000 SF
AVAILABLE SF

CROSS DOCK
LOADING CONFIGURATION

1980
YEAR BUILT

6 (9'x10')
DOCK DOORS

I-4
ZONING

30 DAYS
AVAILABILITY

**Denotes Estimated Operating Expenses for 2024*

603 Central Florida Parkway

603 Central Florida Parkway, Orlando, Florida 32824



OUTSIDE STORAGE HIGHLIGHTS

1.5 ACRES
OUTSIDE STORAGE

\$5,000/AC/MONTH
ASKING RATE

IMMEDIATELY
AVAILABILITY

4.85 ACRES
TOTAL SITE SIZE

I-4
ZONING

603 Central Florida Parkway

603 Central Florida Parkway, Orlando, Florida 32824

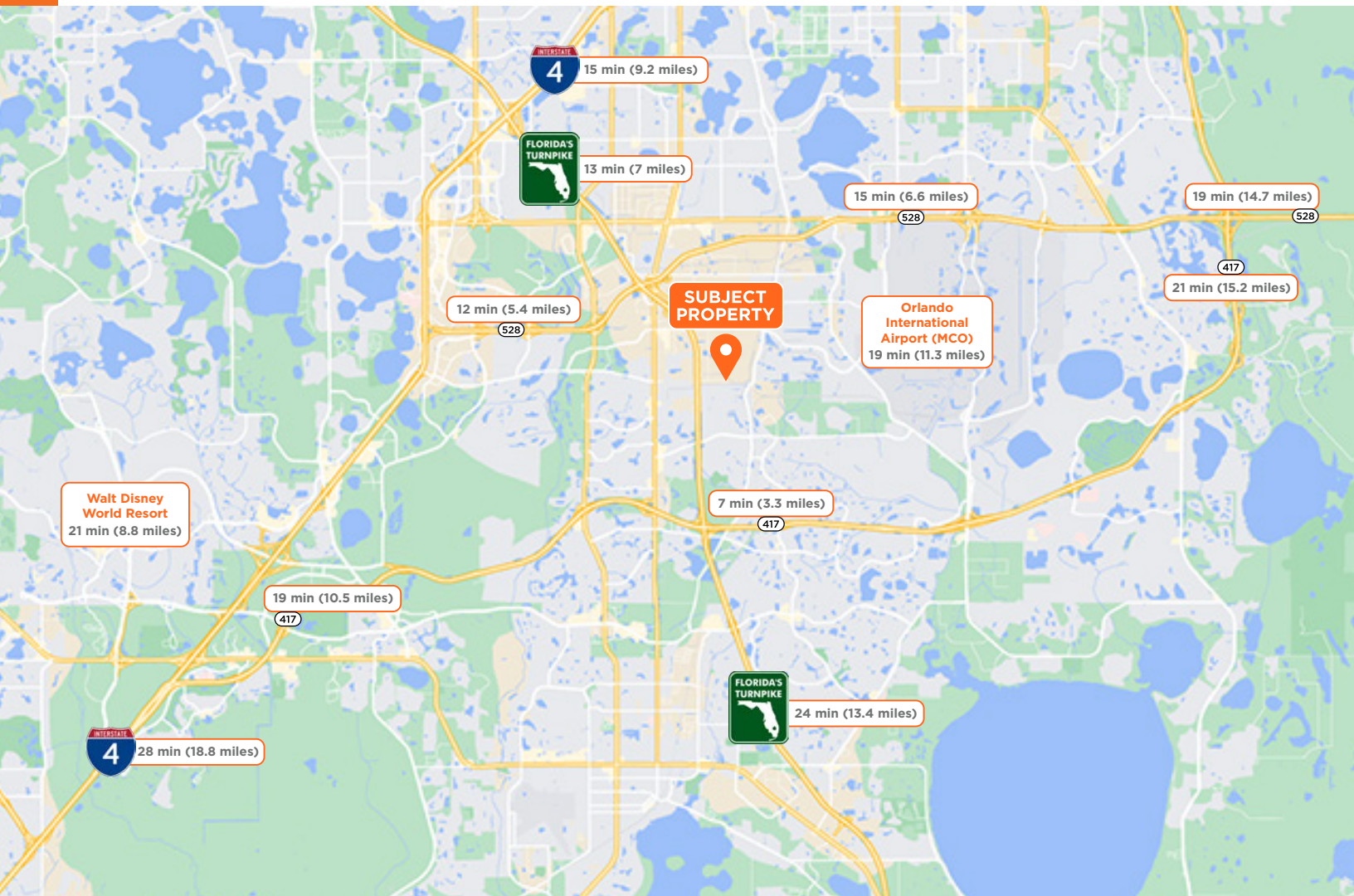

FOR MORE INFORMATION, CONTACT:

JARED BONSHIRE, SIOR

Executive Managing Director
+1 407 541 4414
jared.bonshire@cushwake.com

DAVID PEREZ

Executive Managing Director
+1 407 541 4435
david.perez@cushwake.com

TAYLOR ZAMBITO

Senior Director
+1 407 541 4409
taylor.zambito@cushwake.com

RYAN HUBBARD

Director
+1 407 541 4390
ryan.hubbard@cushwake.com

20 N. Orange Avenue Suite 300
Orlando, FL 32801
United States
+1 407 841 8000
cushmanwakefield.com



©2024 Cushman & Wakefield. All rights reserved. The information contained in this communication is strictly confidential. This information has been obtained from sources believed to be reliable but has not been verified. NO WARRANTY OR REPRESENTATION, EXPRESS OR IMPLIED, IS MADE AS TO THE CONDITION OF THE PROPERTY (OR PROPERTIES) REFERENCED HEREIN OR AS TO THE ACCURACY OR COMPLETENESS OF THE INFORMATION CONTAINED HEREIN, AND SAME IS SUBMITTED SUBJECT TO ERRORS, OMISSIONS, CHANGE OF PRICE, RENTAL OR OTHER CONDITIONS, WITHDRAWAL WITHOUT NOTICE, AND TO ANY SPECIAL LISTING CONDITIONS IMPOSED BY THE PROPERTY OWNER(S). ANY PROJECTIONS, OPINIONS OR ESTIMATES ARE SUBJECT TO UNCERTAINTY AND DO NOT SIGNIFY CURRENT OR FUTURE PROPERTY PERFORMANCE.