

# NOW LEASING

**36,440 S.F. Available**  
**New Construction | Move-in Ready**



## **CLASS A INDUSTRIAL PARK**

**430 Harvest Time Drive Sanford, FL 32771**

### **DESIGN SPECIFICATIONS**

<b>Building 1</b>	<b>146,000 S.F.</b>
<b>Available</b>	<b>36,440 S.F.</b>
<b>Office</b>	<b>1,885± S.F.</b>
<b>Clear Height</b>	<b>32'</b>
<b>Column Spacing</b>	<b>52' x 60', typical</b>
<b>Building Depth</b>	<b>200'</b>
<b>Dock Doors</b>	<b>4</b>
<b>Ramp Doors</b>	<b>1</b>
<b>Loading</b>	<b>Rear</b>
<b>Car Parking</b>	<b>43</b>
<b>Parking Ratio</b>	<b>1.20/1,000 S.F.</b>
<b>Truck Court</b>	<b>130'</b>
<b>Sprinklers</b>	<b>ESFR</b>
<b>Lease Rate</b>	<b>\$9.45/S.F. NNN</b>

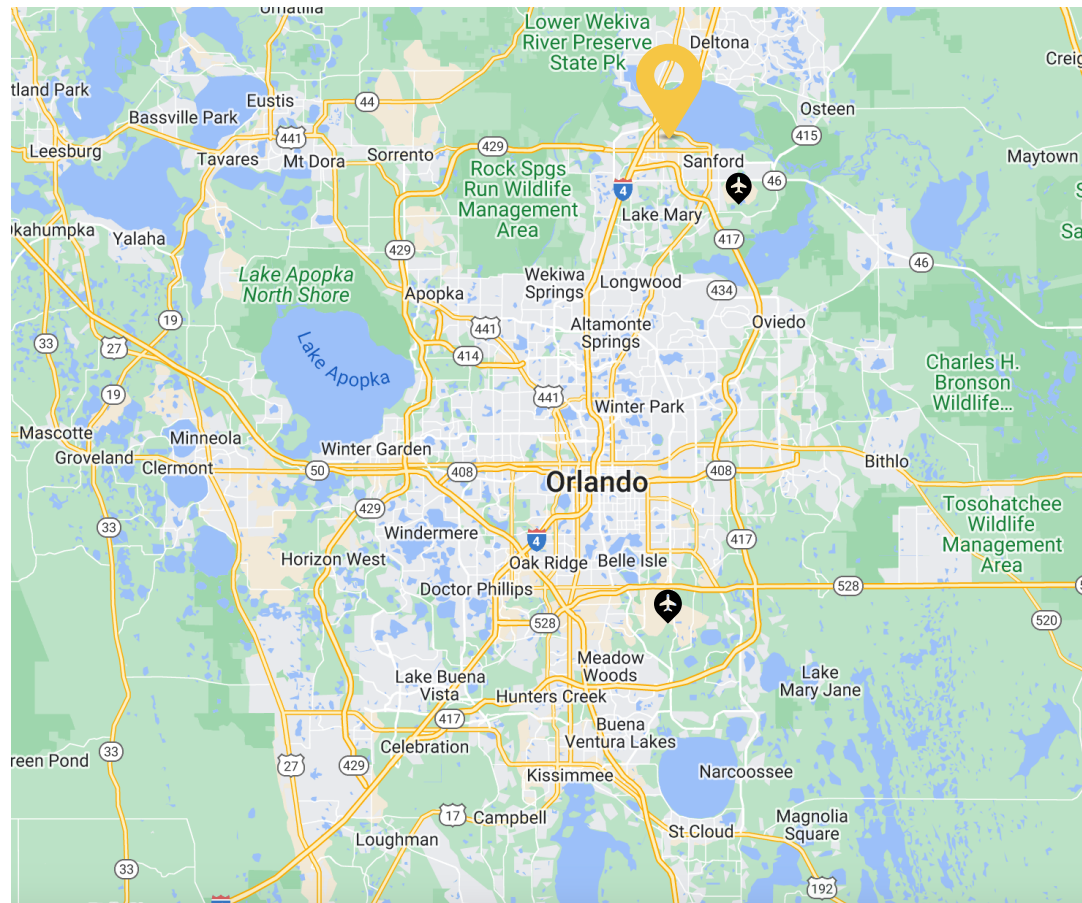

**Interstate Access**

**Proximity to Labor**

**Proximity to Customers**

**Submarket Strength**

**Rail System**

**Accelerated Permitting**

**Local Amenities**



# 430 HARVEST TIME DRIVE

## Office & Warehouse "as built" Floor Plans

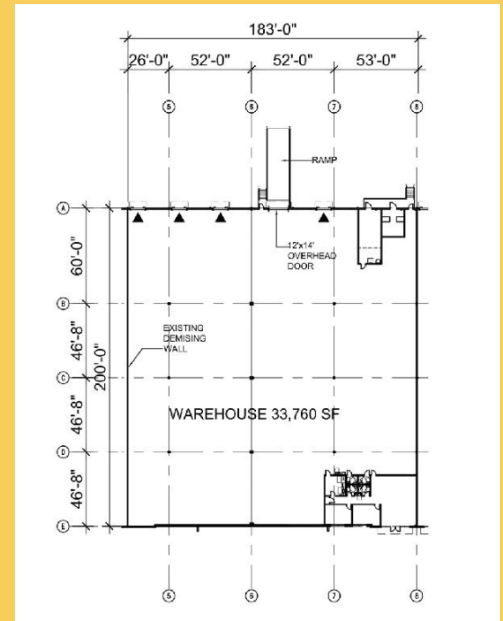
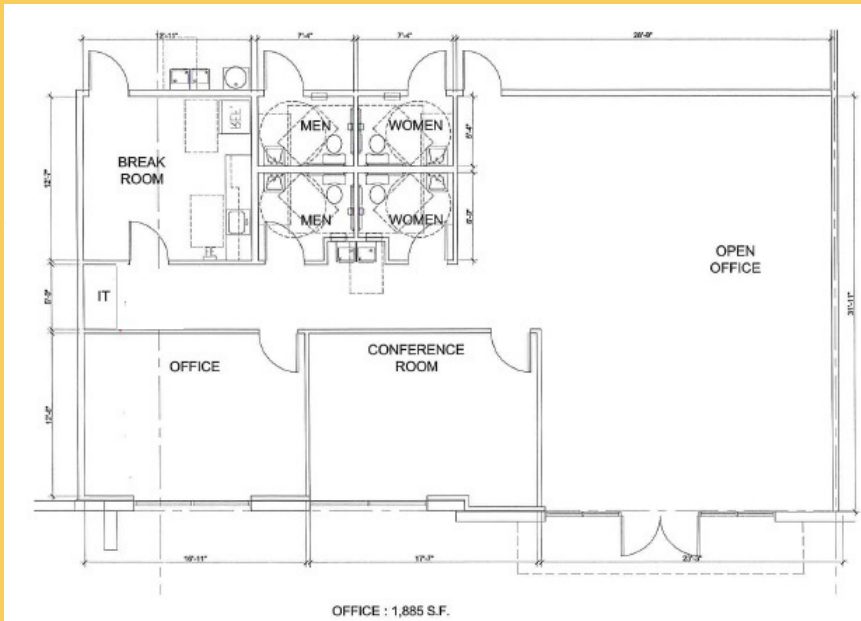

**CRAIG CASTOR**  
 Direct: 407.409.8690  
 Cell: 407.493.6366  
[ccastor@worklifecre.com](mailto:ccastor@worklifecre.com)

**WORKLIFE | CRE**  
 221 NE Ivanhoe Blvd Suite 330  
 Orlando, FL 32804  
[worklifecre.com](http://worklifecre.com)



**WORKLIFE | CRE**

**221 NE Ivanhoe Blvd Suite 330**

**Orlando, FL 32804**

**407-648-0330**

**[worklifecre.com](http://worklifecre.com)**