



### LISTING DATA

**Available SF:** 6,026 SF  
**Doors:** One (1) dock door  
**Clear Height:** 20'  
**Building Type:** Block/Metal Building  
**Comments:** Located in the heart of Longwood, with exceptional access to major thoroughfares such as Ronald Reagan, 434, 436, as well as I-4. 1355 Bennett Drive allows small-businesses the ability to grow and do business in a clean park-like setting.

### ECONOMIC DATA

**Lease Rate:** \$12.75 SF/yr (NNN)  
**Op Ex:** \$2.57/SF



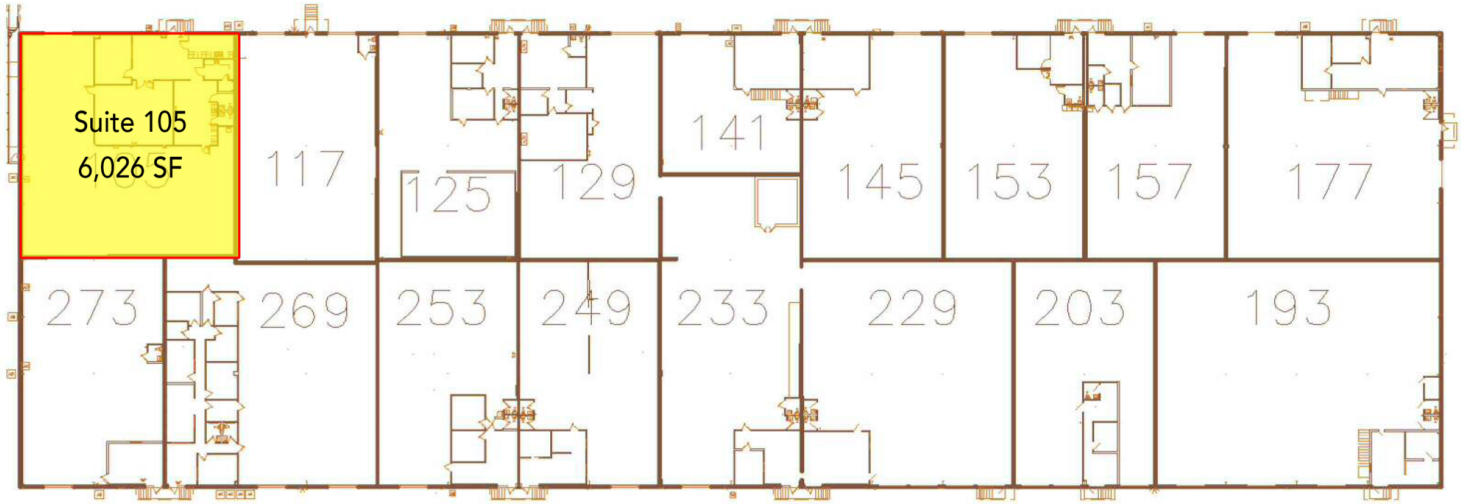

**LEASE INFORMATION**

Lease Type: NNN      Lease Term: Negotiable  
 Total Space: 6,026 SF      Lease Rate: \$12.75 SF/yr

**AVAILABLE SPACES**

SUITE	TENANT	SIZE (SF)	LEASE TYPE	LEASE RATE	DESCRIPTION
Suite 105	Available	6,026 SF	NNN	\$12.75 SF/yr	1,970 SF Office with one (1) dock door

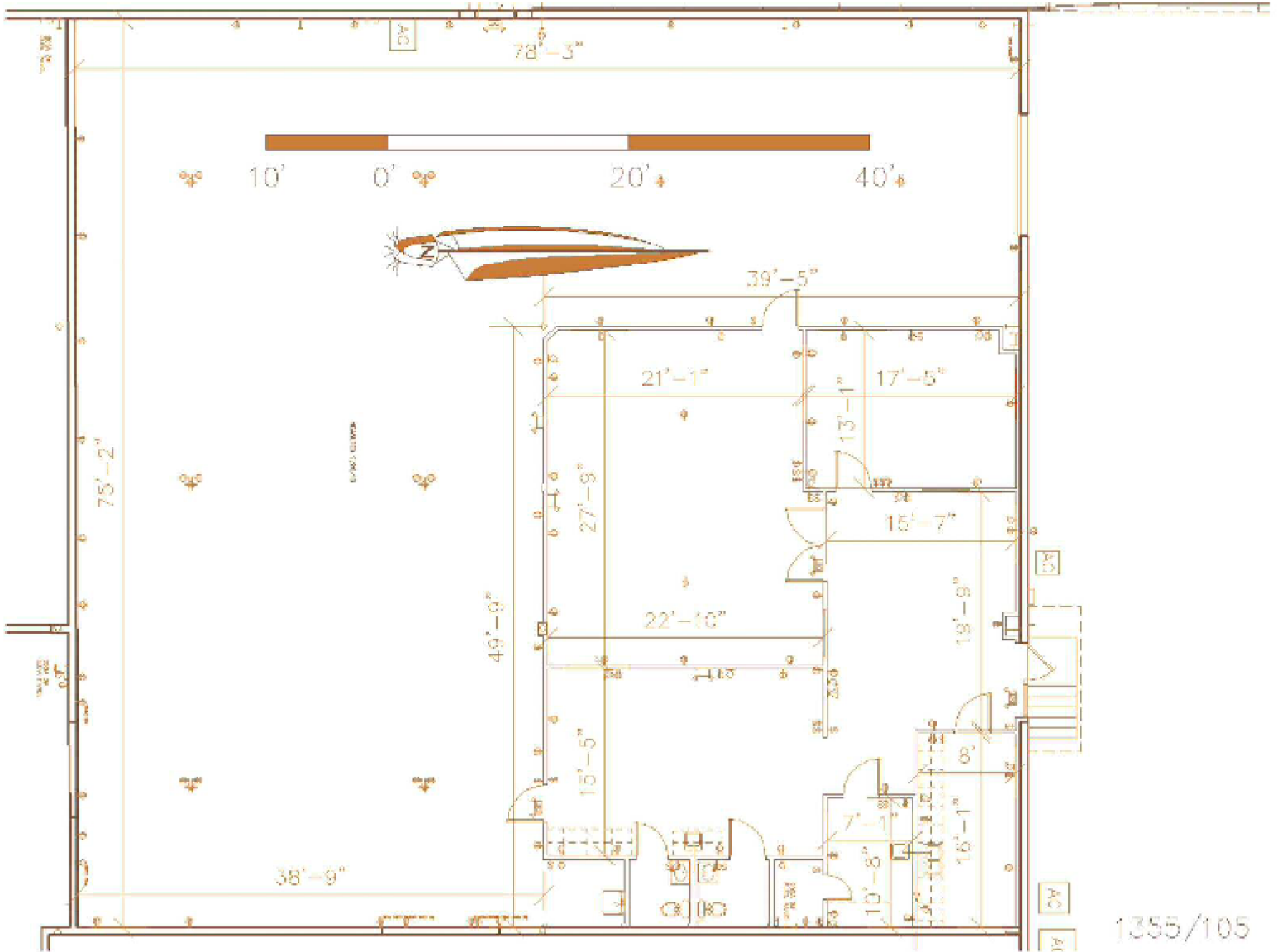

SUITE 105

