

UPSALA RD

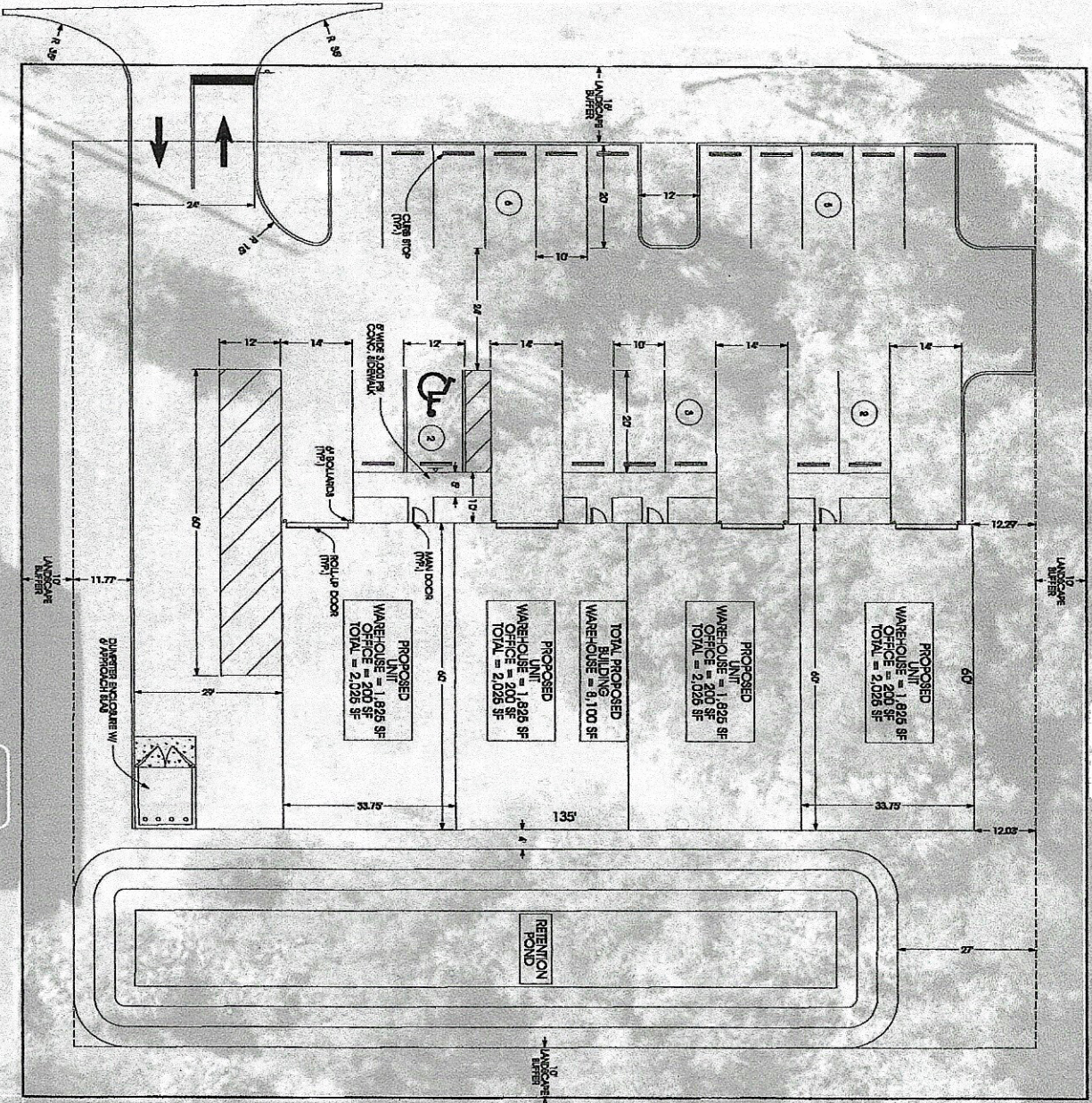

THIS IS A CONCEPT PLAN

ALL REQUIRED DRAWINGS WILL BE SUBMITTED ONCE CONCEPT PLAN IS APPROVED

SITE DATA:
 PARCEL: 24-1-930-006-000-029A
 CURRENT ZONING = R-1 (RESTRICTED INDUSTRIAL)
 TOTAL CONSIGNOR'S AREA = 42,049 SF +/- (0.97 AC)
 TOTAL PROPOSED BUILDING = 6,100 SF
 TOTAL PROPOSED PAVEMENT = 18,410 SF
 TOTAL PROPOSED SIDEWALK = 485 SF
 TOTAL IMPERVIOUS AREA = 21,995 SF (52.28%)
 TOTAL PERVIOUS AREA = 20,074 SF (47.72%)
 TOTAL STORM WATER RETENTION = 6,154 SF (14.6%)

PARKING REQUIREMENTS:
 PARKING PROVIDED:
 TOTAL REGULAR PARKING = 17 SPACES
 TOTAL ADA SPACES = 1 SPACE
 TOTAL PARKING SPACES = 18 SPACES

BUILDING SETBACKS:
 FRONT: 25'
 REAR: 20'
 LANDSCAPE BUFFER
 FRONT: 15'
 SIDE: 10'
 REAR: 10'

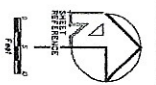

6/8/2023 8:20:42 PM INVA Construction/Revision 000 Training Concept Plan/Work/2023/06/08/2023

SHEET NO.
1 of 1

MICHAEL WOJTUNIAK, P.E.
 P.E. NO. 000000000
 STATE: MI

EPI
 ENGINEERING PLANNING DESIGN PERMITTING

PROJECT: PAWECTION DOG TRAINING

SHEET TITLE: CONCEPT PLAN

REVISIONS:

DATE	BY	DESCRIPTION	DATE	BY	DESCRIPTION

*** THIS ITEM HAS BEEN DIGITALLY SIGNED AND SEALED BY MICHAEL J. WOJTUNIAK, P.E. ON 6/8/2023. PRINTED COPIES OF THIS DOCUMENT ARE NOT CONSIDERED SIGNED AND SEALED AND THE SIGNATURE MUST BE VERIFIED ON ANY ELECTRONIC COPIES, UNLESS THE RAISED SEAL HAS BEEN UTILIZED. ***