

27419 W. Molidor Rd.
Volo, IL 60041

For Sale

MLS #11764727

LAND



LAND 4.34 ACRES

\$895,000

**Signalized Commercial Corner
with Multi Family Potential**

4.34 Acres at signalized intersection with great traffic counts of over 25,000 vehicles per day, zoned B-3 in Volo.

Property contains house and barn currently rented short term for \$2,550/mo. Approximate frontage is 235' on Route 12 and 621' on Molidor Road.

Volo is looking for retail and possibly multi-family (see concept plan) on this prime corner. **24 Acre site across from this property is under contract for a multi-family development.**

Price depends on use: \$8 psf for commercial corner and \$12,000 per unit for multi-family. Broker is related to seller.

Demographics	1 Mile	3 Miles	5 Miles
Total Population	2,481	26,601	99,796
Average HH Income	\$100,473	\$99,433	\$91,406

Specifications

Description:	Land - Retail or Multi Family
Land Size:	4.34 Acres (189,050 SF)
Topography:	Level/Wooded
Environmental Status:	TBA
Utilities:	To Property
Sewer/Water:	Nearby / Across Molidor
Frontage Dimensions:	235' Route 12 621' Molidor Rd.
Zoning:	B-3 (Regional Business District)
Taxes:	\$10,956.14 (2022)
PIN #:	05-27-400-018

[CLICK HERE TO VIEW OUR WEBSITE](#)

No warranty or representation is made as to the accuracy of the foregoing information. Terms of sale or lease and availability are subject to change or withdrawal without notice. This document is for information purposes only. No offer of sub-agency is being made.



www.PremierCommercialRealty.com | 847.854.2300 | 9225 S. Route 31, Lake in the Hills, IL 60156

Senior Broker
Bruce Kaplan

BruceK@PremierCommercialRealty.com
O: 847.854.2300 xx20 C: 847.507.1759

27419 W. Molidor Rd.
Volo, IL 60041

For Sale

LAND

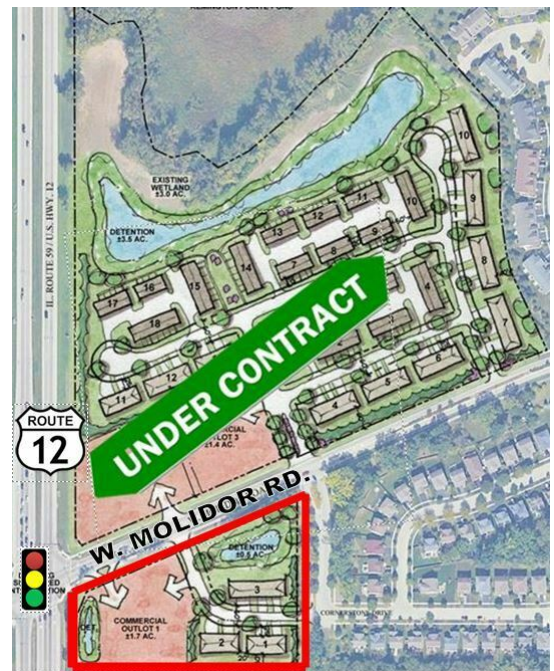
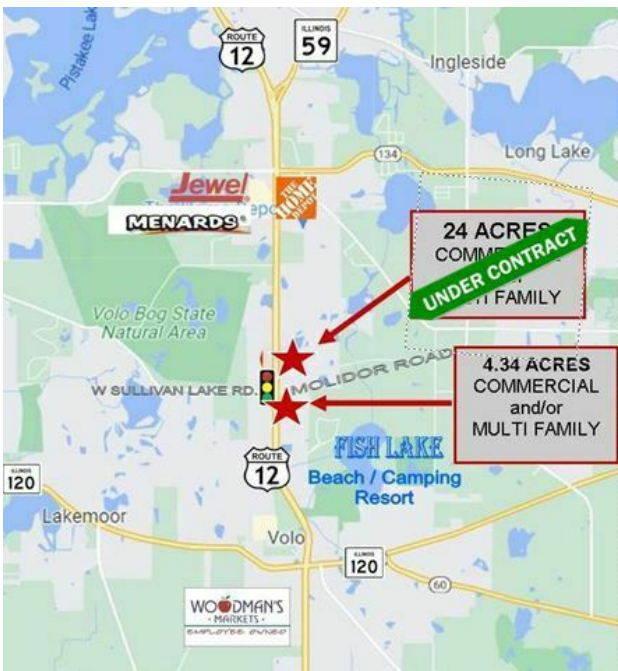

[CLICK HERE TO VIEW OUR WEBSITE](#)

No warranty or representation is made as to the accuracy of the foregoing information. Terms of sale or lease and availability are subject to change or withdrawal without notice. This document is for information purposes only. No offer of sub-agency is being made.



www.PremierCommercialRealty.com | 847.854.2300 | 9225 S. Route 31, Lake in the Hills, IL 60156

Senior Broker
Bruce Kaplan
BruceK@PremierCommercialRealty.com
O: 847.854.2300 xx20 C: 847.507.1759