

6,300 SF OFFICE SPACE AT TYLER SQUARE 1320 MAIN ST., WILLIMANTIC, CT



FOR LEASE
\$19.75/SF+NNN

VIEW DIRECTLY ACROSS THE STREET— WINDHAM HOSPITAL

- ⇒ Across from Windham Hospital
- ⇒ Public Water & Sewer
- ⇒ 10 Ft. Ceiling Height
- ⇒ Gas Heat / Central AC
- ⇒ At signalized intersection
- ⇒ 3-Phase Electric, 480 volts, 4,000 amps
- ⇒ Sprinklered
- ⇒ 525 Parking Spaces
- ⇒ Across from Stop & Shop
- ⇒ Close Proximity to
 - ◇ Windham Hospital
 - ◇ Eastern Connecticut State University



RON LYMAN

Main Office:
1160 Boston Post Rd.
Westbrook, CT 06498
Mailing Address:
73 Second Ave.
Westbrook, CT 06498
860-887-5000 x1 Office

LYMAN

REAL ESTATE BROKERAGE & DEVELOPMENT

www.LymanRE.com

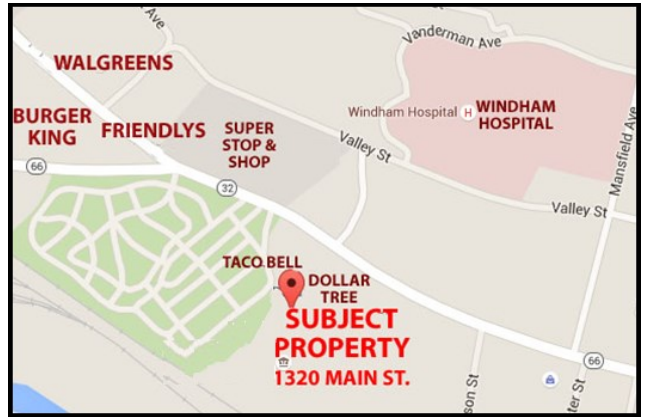
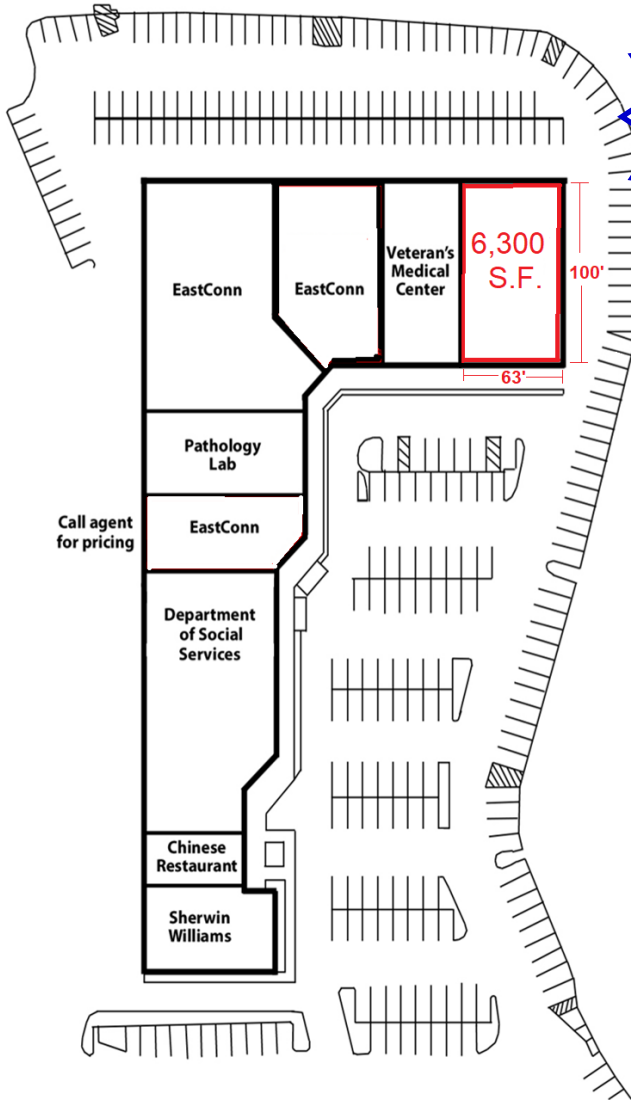

EXISTING FLOOR PLANS (can be reconfigured)

