

RETAIL | OFFICE FOR SALE

2230-2250 Palm Avenue Hialeah, FL 33010

\$2,550,000

+/- 3,835 SF RETAIL/ OFFICE ACROSS 2 BUILDINGS AVAILABLE FOR SALE. 2 WATER & GAS METERS, IMPACT WINDOWS. PROPERTY SITS ON HIGHLY TRAFFICATED PALM AVE WITH C-2 LIBERAL RETAIL COMMERCIAL ZONING. ACROSS FROM HISTORICAL HIALEAH PARK AND CASINO GOING THROUGH REDEVELOPMENT. MULTIPLE USES PERMITTED.

9,750 SF LOT
C-2 RETAIL COMM ZONING
NEW ROOF, ELEC, PLUMB.
40-YEAR CERTIFICATION

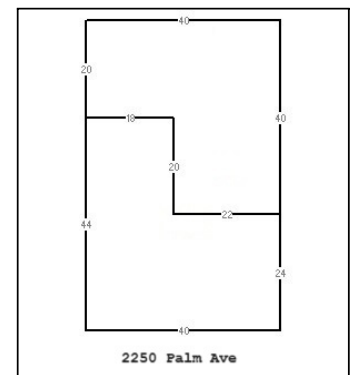
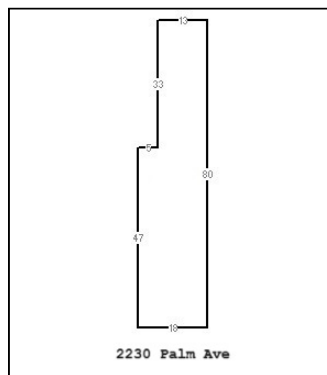
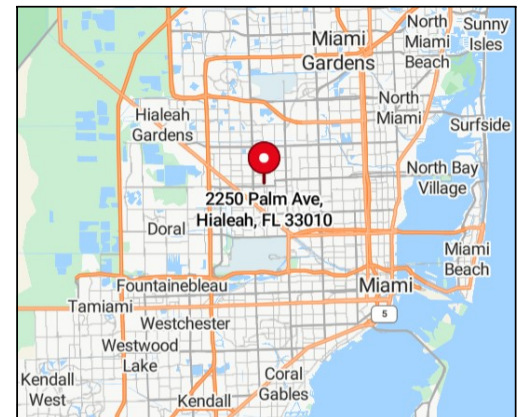

If your property is already listed, this is not a solicitation. We gladly cooperate with all brokers.

With roots that trace back to 1926, our family-owned company surpassed \$6.8 Billion in total real estate services in 2019.

Keyes.com | KeyesLuxury.com



David Gonzalez, AHWD, e-PRO®, PSA, RENE, SFR, SRES, SRS

**Commercial Broker Associate
The Keyes Company**

Office: 305-371-3592 x14259

Direct: 305-747-8171

Email: davidgonzalez@keyes.com